

UNITED STATES PUBLIC LAND SURVEY CORNER CERTIFICATE

OF

Land Survey Monuments situated in Section 12, Township 76 N, Range 26 W, of the Fifth Principal Meridian, Madison County, Iowa. Previously recorded in N. A. in County Recorder's Office.

(book, page, document number, etc.)

(Show reason for preparing this certificate, the evidence and detailed procedures used in establishing the corner positions and monumentation found or placed.)

Monument Description and Remarks: Found capped iron pin, # not legible. Accepted position.

PLAN - VIEW

(Show a minimum of three reference ties to durable physical objects, relevant monuments and physical conditions that will enable recovery of the corner.)

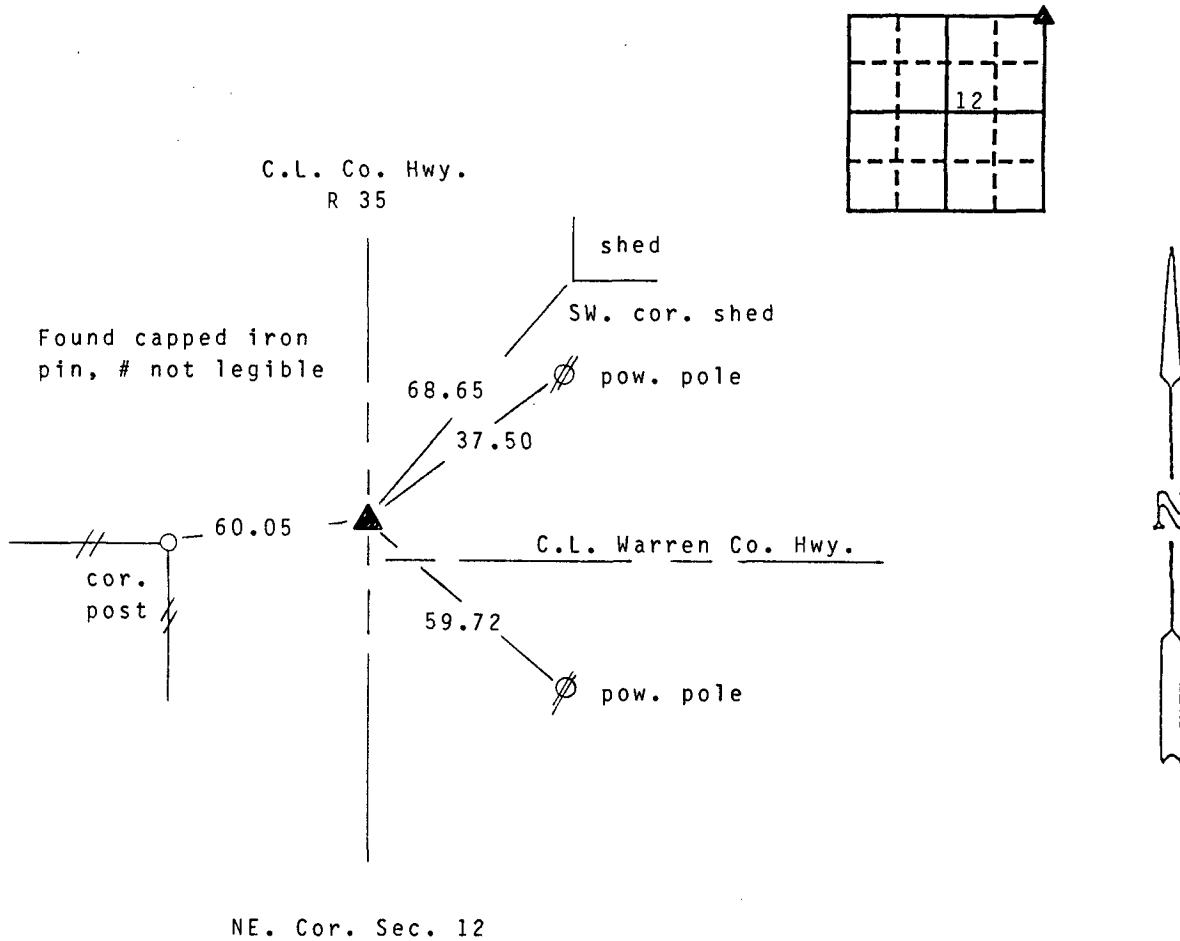

Note: all ties to "X" nails

I hereby certify that the survey work was completed and this certificate was prepared by me or under my direct personal supervision and that I am a duly registered land surveyor under the laws of the state of Iowa. My registration renewal date is 12/31/97.

Signature: J. Brian Morrissey
Name typed or printed: J. Brian Morrissey
Date: Dec. 27, 1995 Reg. No. 7995

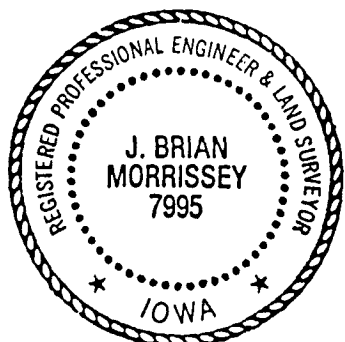

SEAL

Corners	Section	Twp	Range
NE.	12	76N	26W

REC \$ 500
A.S.D. \$ 700
R.M.F. \$ 100

FILED NO. **1782**

BOOK 1 PAGE 323

95 DEC 29 AM 10: 50

MICHELLE UTSLER
RECORDER
MADISON COUNTY, IOWA

CHECKED
RECORDED
COMPARED