

UNITED STATES PUBLIC LAND SURVEY CORNER CERTIFICATE

95-1195

OF

Land Survey Monuments situated in Section 10, Township 75 North, Range 26 West, of the Fifth Principal Meridian, Madison County, Iowa. Previously recorded in N/A in County Recorder's Office.

(book, page, document number, etc.)

(Show reason for preparing this certificate, the evidence and detailed procedures used in establishing the corner positions and monumentation found or placed.)

Monument Description and Remarks: Found and/or set C.I.R. #5041 at corners as shown on sketch below. FILED NO. 1514

BOOK 1 PAGE 321

REC. \$ 5.00

95 NOV 29 PM 3:34

INDEXED
RECORDED
CERTIFIED

AUDIT ✓
R.M.F. \$ 1.00

MICHELLE UTSLER
RECORDER
MADISON COUNTY, IOWA

PLAN - VIEW

(Show a minimum of three reference ties to durable physical objects, relevant monuments and physical conditions that will enable recovery of the corner.)

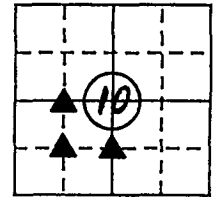
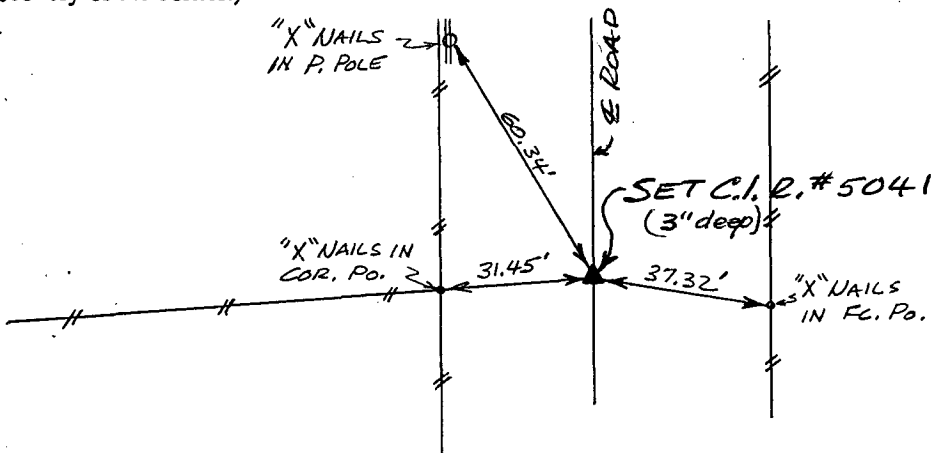

Ref. to SE. COR., NE. 1/4 of SW. 1/4, SECTION 10, T75N, R26W.

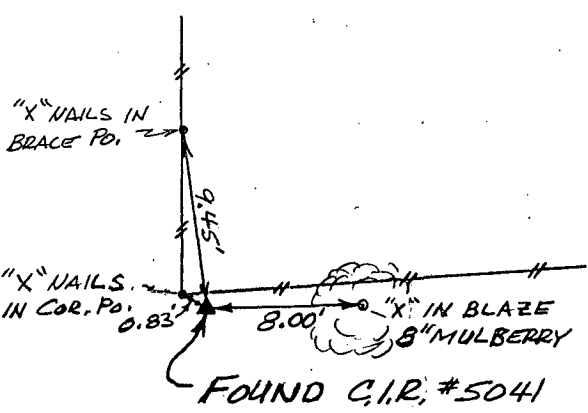

Ref. to NE. COR., NW. 1/4 of SW. 1/4, SECTION 10, T75N, R26W.

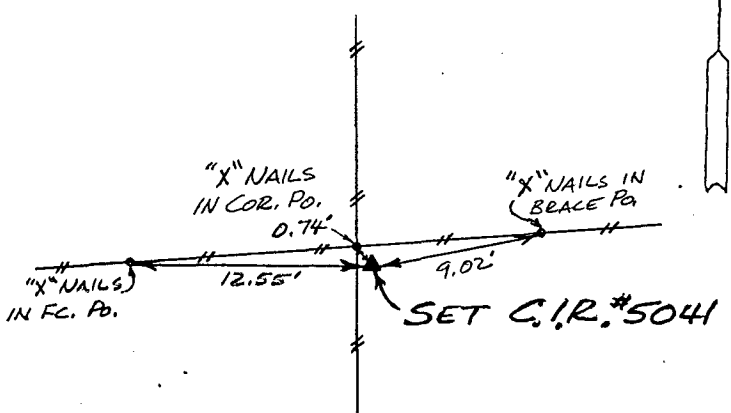

Ref. to SE. COR., NW. 1/4 of SW. 1/4, SECTION 10, T75N, R26W.

I hereby certify that the survey work was completed and this land surveying document was prepared by me or under my direct personal supervision and that I am a duly registered land surveyor under the laws of the state of Iowa

Signature: Charles T. Vance
Name typed or printed: Charles T. Vance, PE & LS

Date: 16 Oct. 1995 Reg. No. 5041

My registration renewal date is December 31, 1995

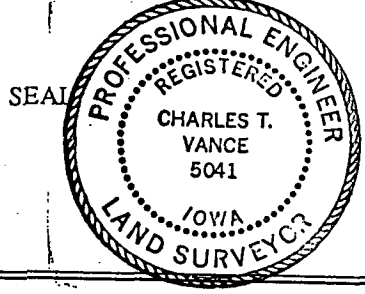

Corners	Section	Twp	Range
SE. COR.			
NE. 1/4 SW. 1/4	10	75	26
NE. COR.			
NW. 1/4 SW. 1/4	10	75	26
SE. COR.			
NW. 1/4 SW. 1/4	10	75	26