

UNITED STATES PUBLIC LAND SURVEY CORNER CERTIFICATE

OF

Land Survey Monuments situated in Section 7, Township 76 North, Range 28 West, of the Fifth Principal Meridian, Madison County, Iowa. Previously recorded in _____ in County Recorder's Office.

(book, page, document number, etc.)

(Show reason for preparing this certificate, the evidence and detailed procedures used in establishing the corner positions and monumentation found or placed.)

Monument Description and Remarks:

NW cor. SW 1/4 NE 1/4 - Found Round Headed Bolt, 16" deep

NW Cor SW 1/4 NW 1/4 - Set P.K. Nail in Slab of County Road P-57

PLAN - VIEW

(Show a minimum of three reference ties to durable physical objects, relevant monuments and physical conditions that will enable recovery of the corner.)

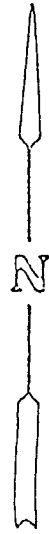
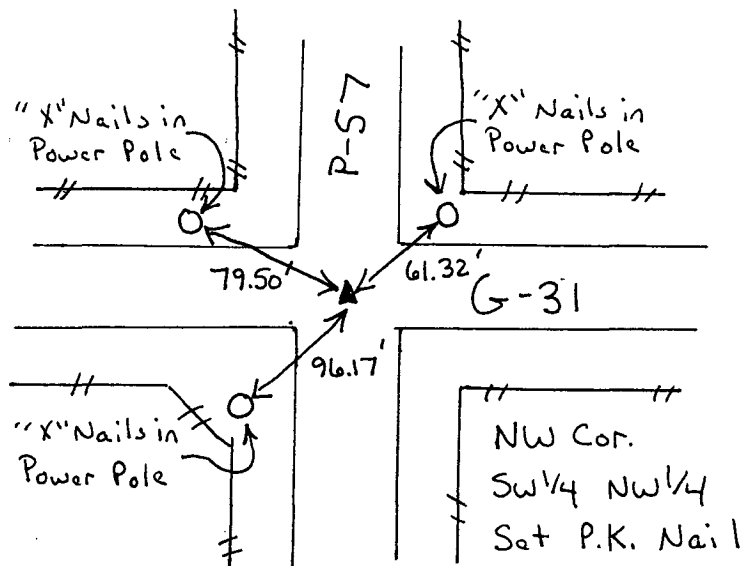
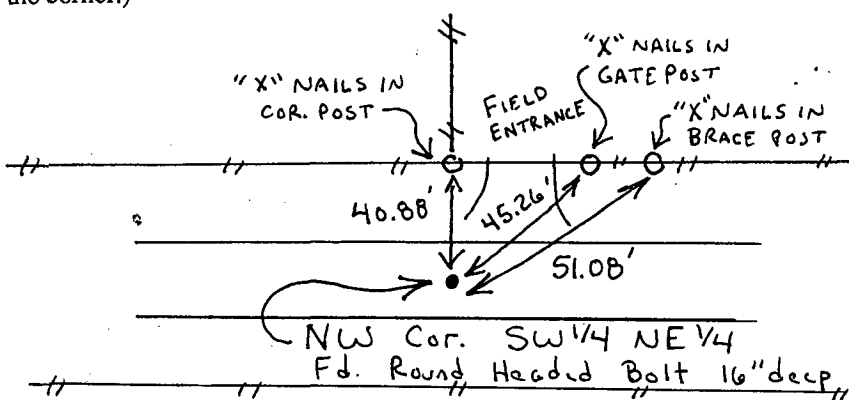

I hereby certify that the survey work was completed and this land surveying document was prepared by me or under my direct personal supervision and that I am a duly registered land surveyor under the laws of the state of Iowa

Signature: J. M. Hochstetler
Name typed or printed: J. M. Hochstetler

Date: 11/28/95 Reg. No. 6808

My registration renewal date is December 31, 1995

SEAL



Corners	Section	Twp	Range
NW cor SW 1/4 NE 1/4	7	76	28

NW cor SW 1/4 NW 1/4	7	76	28
----------------------	---	----	----

REC \$ 5.00
AUD \$ _____
R.M.F. \$ 1.00

FILED NO. 1512

BOOK 1 PAGE 319

95 NOV 29 PM 3:32

COMPILED
RECORDED
INDEXED

MICHELLE UTSLER
RECORDER
MADISON COUNTY, IOWA