

RECS 5⁰⁰
AUGS
PLANS 1⁰⁰

COMPUTER ✓
RECORDED ✓ 2000 MAY -9 PM 3:01
COMPARED ✓

MICHELLE UTSLER
RECORDER
MADISON COUNTY, IOWA

✓ VANCE & HOCHSTETLER, P.C., CONSULTING ENGINEERS, WINTERSSET, IOWA (515) 462-3995
CHARLES T. VANCE, 110 West Green St., Winterset, Iowa, 50273
JAMES M HOCHSTETLER, 110 West Green St., Winterset, Iowa 50273

UNITED STATES PUBLIC LAND SURVEY CORNER CERTIFICATE

Land Survey Monuments situated in Section 28 OF 28 Township 77 North Range 29 West, of the Fifth Principal Meridian, MADISON County, Iowa.
Previously recorded in _____ in County Recorder's Office.
(book, page, document number, etc.)

(Show reason for preparing this certificate, the evidence and detailed procedures used in establishing the the corner positions and monumentation found or placed.)

Monument Description and Remarks:

S. 1/4 cor. - Fd. Square headed bolt (3" deep) in roadway in line with property line fences North & South.
SW cor. - Set Capped Iron Rod #6808 (1/2" rebar, 3" deep) at centerline-centerline intersection of existing roadways (used roads to North and East to set).

PLAN - VIEW

(Show a minimum of three reference ties to durable physical objects, relevant monuments and physical conditions that will enable recovery of the corner.)

SOUTH 1/4 COR.
SEC. 28-77-29
Fd. Square headed bolt

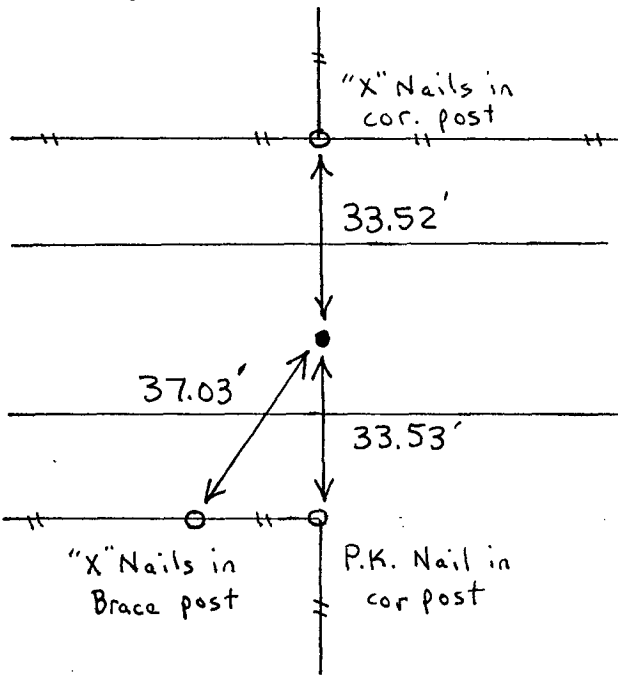

SW CORNER
SEC. 28-77-29
Set C.I.R. #6808

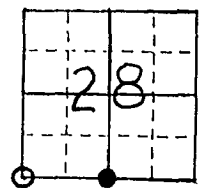

NOTE: All ties are to "X" Nails set in Power Poles.

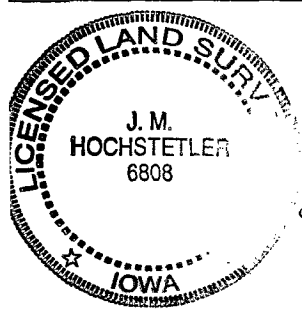
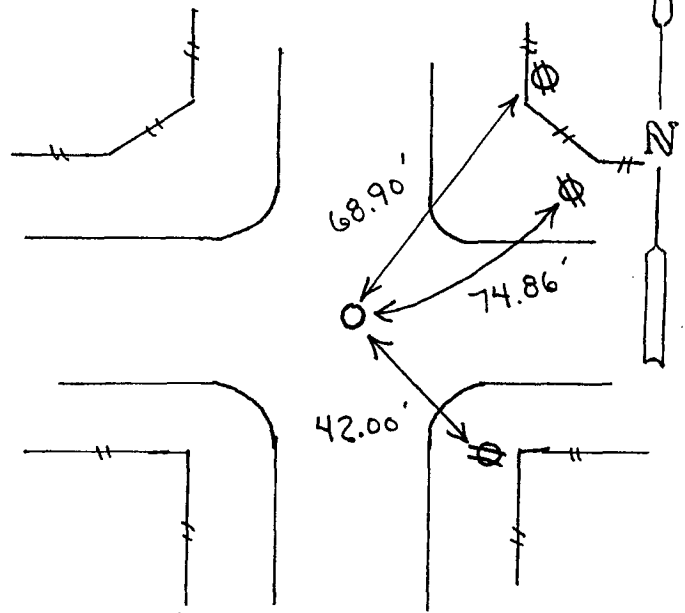

I hereby certify that this land surveying document was prepared and the related survey work was performed by me or under my direct personal supervision and that I am a duly licensed Land Surveyor under the laws of the State of Iowa.

J.M. Hochstetler
J.M. HOCHSTETLER

License number 6808 Date 5/19/2000

My license renewal date is December 31, 2001

Pages or sheets covered by this seal: 1

List Corners to be Indexed

Corners	Section	Twp	Range
S. 1/4 cor.	28	77N	29W
SW cor.	28	77N	29W