

REC.S. 5⁰⁰ COMPUTER
 AUD.S. _____ RECORDED
 R.M.F.S. 1⁰⁰ COMPARED

MICHELLE UTSLER
 RECORDER
 MADISON COUNTY, IOWA

RETURN TO: BOLDMAN LAND SURVEYING, P.C., BOX 66, WINTERSSET, IA 50273 515-462-9242

UNITED STATES PUBLIC LAND SURVEY CORNER CERTIFICATE

OF

Land Survey Monuments situated in Section 21, Township 78, Range 26, of the Fifth Principal Meridian, Madison County, Iowa
 Previously recorded in None In County Recorder's Office.
 (book, page, document number, etc.)

(Show reason for preparing this certificate, the evidence and detailed procedures used in establishing the corner positions and monumentation found or placed.)

Monument Description and Remarks: Set 5/8" capped rebar #13427 based on traversing the NW 1/4 of Section 21 using recorded section corners, fence corners, and monuments

PLAN-VIEW

(Show a minimum of three reference ties to durable physical objects, relevant monuments and physical conditions that will enable recovery of the corner.)

① X-nails in fence posts

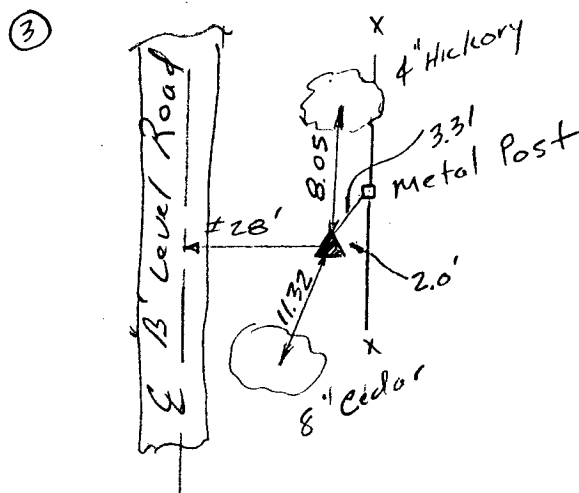
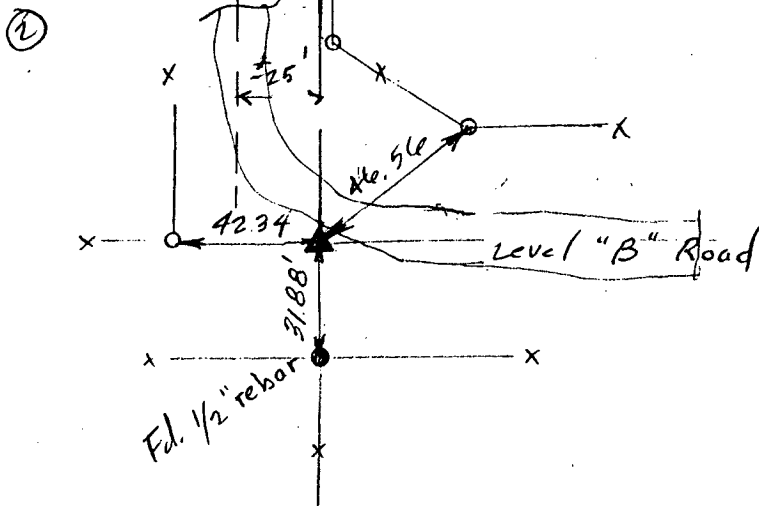
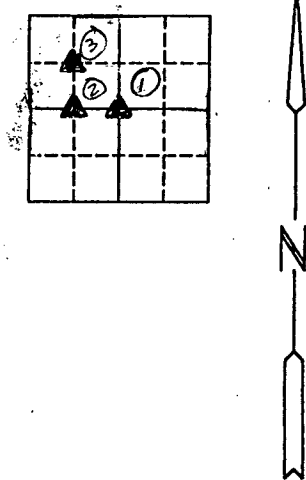
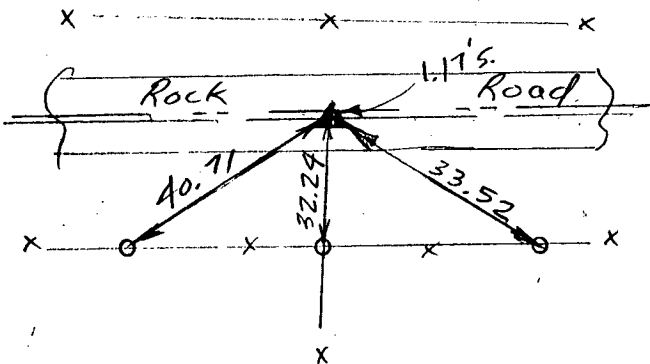

I hereby certify that the survey work was completed and this certificate was prepared by me or under my direct personal supervision and that I am a duly Licensed Land Surveyor under the laws of the State of Iowa

Signature: Craig S. Boldman
 Craig S. Boldman

Date: 3/20/02 Reg. No. 13427

List Corners to be Indexed

Corners	Section	Twp	Range
SE CORNER NW 1/4	21	78	26
SW CORNER SE 1/4 NW 1/4	21	78	26
NW CORNER SE 1/4 NW 1/4	21	78	26

SEAL

