

UNITED STATES PUBLIC LAND SURVEY CORNER CERTIFICATE

OF

Land Survey Monuments situated in Section 26, Township 76 N, Range 29 W, of the Fifth Principal Meridian, MADISON County, Iowa. Previously recorded in _____ in County Recorder's Office.

(book, page, document number, etc.)

(Show reason for preparing this certificate, the evidence and detailed procedures used in establishing the corner positions and monumentation found or placed.)

Monument Description and Remarks: S 1/4 COR SEC. 26-76-29 - Set yellow CIR # 6808 3" deep - Set at & traveled portion of Co. Rd. in line with Property line fence to South. Fence to North next to Road was not on line because of ditch but did line up with set point after it got away from the ditch.

PLAN - VIEW

(Show a minimum of three reference ties to durable physical objects, relevant monuments and physical conditions that will enable recovery of the corner.)

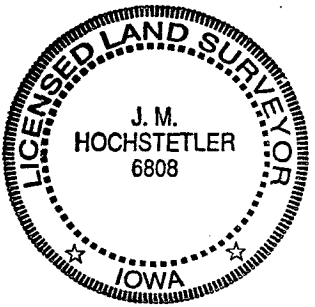
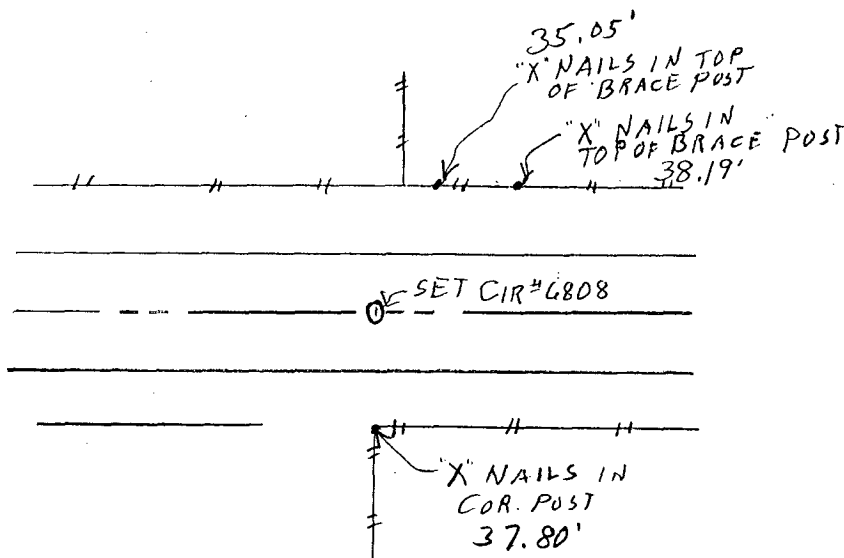
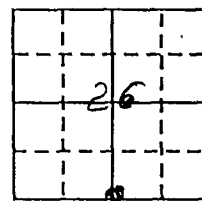

I hereby certify that this land surveying document was prepared and the related survey work was performed by me or under my direct personal supervision and that I am a duly licensed Land Surveyor under the laws of the State of Iowa.
J.M. Hochstetler
 J.M. HOCHSTETLER
 License number 6808 Date 11/26/2000
 My license renewal date is December 31, 2001.
 Pages or sheets covered by this seal: 1

Corners	Section	Twp	Range
S 1/4 COR	26	76 N	29 W

REC \$ 5.00
 AUD \$ _____
 R.M.F. \$ 1.00

COMPUTER
 RECORDED
 COMPARED

FILED NO. 002791
 BOOK 2 PAGE 129
 2000 JAN 26 PM 3:14
 MICHELLE UTSLER
 RECORDER
 MADISON COUNTY, IOWA