

REC'D 5<sup>th</sup>  
 AUDS  
 R.M.F. \$ 1.00

FILED NO. 003549  
 BOOK 2 PAGE 140

2000 MAR 24 AM 11:57

COMPUTER   
 RECORDED   
 COMPARED

CHARLETTA UTSLER  
 RECORDER  
 MADISON COUNTY, IOWA

**CORRECTION**

RETURN TO BOLDMAN LAND SURVEYING, P.C., BOX 66, WINTERSET, IA 50273 515-462-9242

**UNITED STATES PUBLIC LAND SURVEY CORNER CERTIFICATE**

OF

Land Survey Monuments situated in Section 21, Township 76, Range 28, of the Fifth Principal Meridian, Madison County, Iowa. Previously recorded in Book 2 Page 138 in County Recorder's Office. (book, page, document number, etc.)

(show reason for preparing this certificate, the evidence and detailed procedures used in establishing the corner positions and monumentation found or placed.)

Monument Description and Remarks: Set 5/8" capped rebar #13427 based on traversing the NW 1/4 of Section 21 using recorded section corners, fence corners, and monuments

**PLAN-VIEW**

(Show a minimum of three reference ties to durable physical objects, relevant monuments and physical conditions that will enable recovery of the corner.)

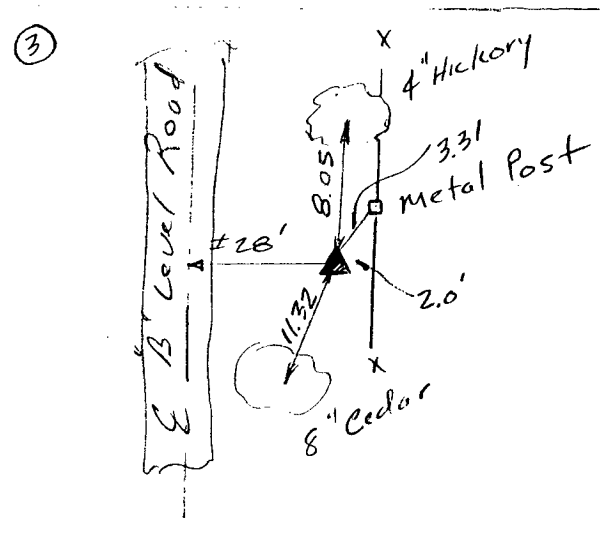
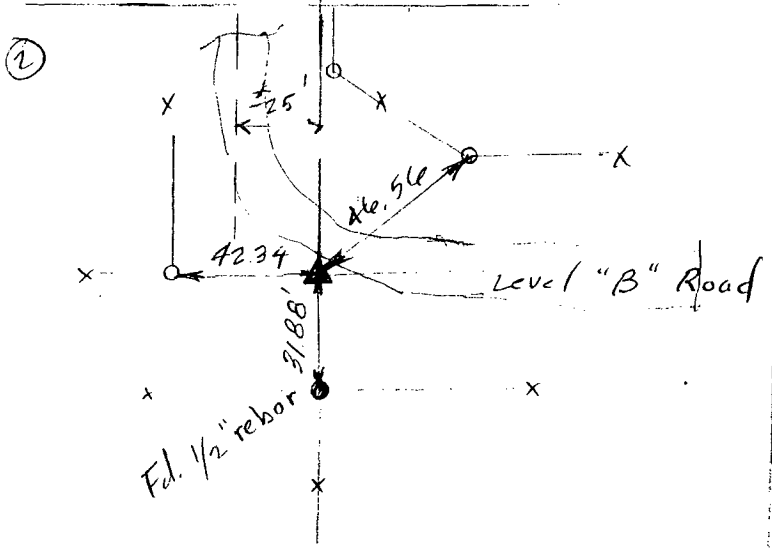
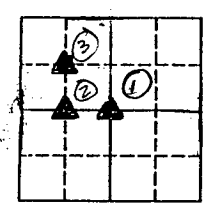
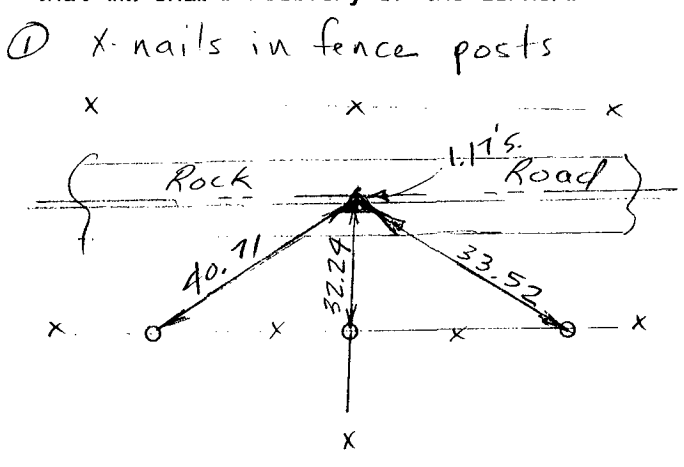

I hereby certify that the survey work was completed and this certificate was prepared by me or under my direct personal supervision and that I am a duly Licensed Land Surveyor under the laws of the State of Iowa

Signature: Craig S. Boldman  
 Craig S. Boldman

Date: 3/24/00 Reg. No. 13427

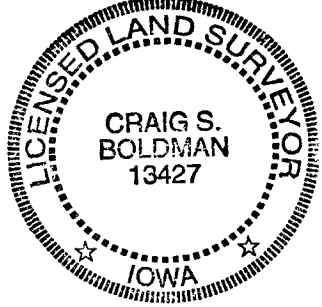

SEAL

**List Corners to be Indexed**

Corners	Section	Twp	Range
SE CORNER NW 1/4	21	76	28
SW CORNER SE 1/4 NW 1/4	21	76	28
NW CORNER SE 1/4 NW 1/4	21	76	28