

REC \$ 5.00
AUD \$ _____
R.M.F. \$ 1.00

FILED NO. 002227
BOOK 2 PAGE 120
1999 DEC 13 PM 1:30

COMPUTER
RECORDED
COMPARED

MICHELLE UTSLER
RECORDER
MADISON COUNTY IOWA

RETURN TO: BOLDMAN LAND SURVEYING, P.C., BOX 66, WINTERSSET, IA 50273 515-462-9242

UNITED STATES PUBLIC LAND SURVEY CORNER CERTIFICATE

□ OF
Land Survey Monuments situated in Section 24 Township 76 N. Range _____
26 W. of the Fifth Principal Meridian, Madison County, Iowa
Previously recorded in Warren Co. Engr. Office In County Recorder's Office.
(book, page, document number, etc.)

(show reason for preparing this certificate, the evidence and detailed procedures used in establishing the corner positions and monumentation found or placed.)

Monument Description and Remarks: Found 1/2" pin set over conc. mon.
Original ties destroyed by construction. Re-
tied to perpetuate location.

PLAN-VIEW

(Show a minimum of three reference ties to durable physical objects, relevant monuments and physical conditions that will enable recovery of the corner.)

All nails in top of posts

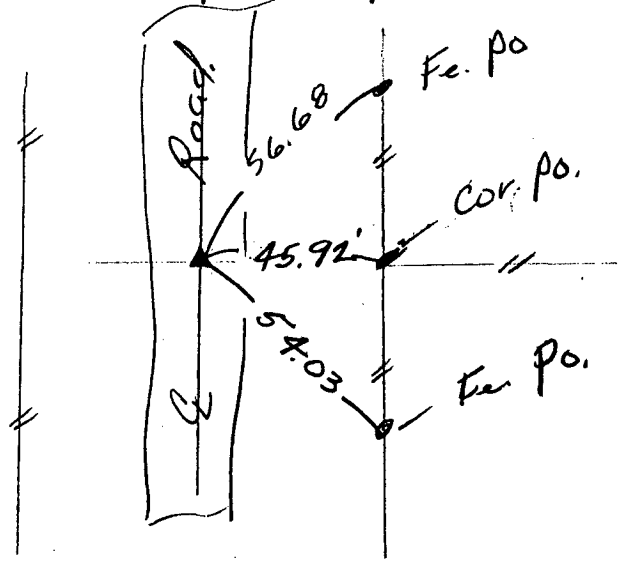

Ref. E 1/4 Sec. 24-76-26

I hereby certify that the survey work was completed and this certificate was prepared by me or under my direct personal supervision and that I am a duly Licensed Land Surveyor under the laws of the State of Iowa

Signature: _____
Craig S. Boldman

Date: _____ Reg. No. 13427

SEAL

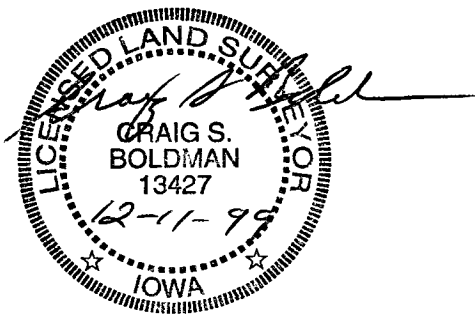

List Corners to be Indexed

Corners	Section	Twp	Range
E 1/4	24	76N	26W