

COMPUTER   
RECORDED   
COMPARED

FILED NO. 000277  
BOOK 2 PAGE 85  
99 JUL 19 PH 2:21

REC \$ 5.00  
AJD \$         
R.I.F. \$ 1.00

MICHELLE UTSLER  
RECORDER  
MADISON COUNTY, IOWA

VANCE & HOCHSTETLER, P.C., CONSULTING ENGINEERS, WINTERSSET, IOWA (515) 462-3995  
CHARLES T. VANCE, 110 West Green St., Winterset, Iowa, 50273  
JAMES M HOCHSTETLER, 110 West Green St., Winterset, Iowa 50273

UNITED STATES PUBLIC LAND SURVEY CORNER CERTIFICATE  
OF

Land Survey Monuments situated in Section 32, Township 74 North, Range 27 West, of the Fifth Principal Meridian, MADISON County, Iowa.  
Previously recorded in \_\_\_\_\_ in County Recorder's Office.  
(book, page, document number, etc.)

(Show reason for preparing this certificate, the evidence and detailed procedures used in establishing the the corner positions and monumentation found or placed.)

Monument Description and Remarks:  
SW cor. - Set capped Iron Rod (1/2" rebar, 3" deep) #6808 at R.O.W. split of North-South road in line with fence line to East.  
NW cor. SW. 1/4 SW. 1/4 - Set C.I.R. #6808 at halfway point of ~~R.O.W.~~ R.O.W. split line from the SW cor. and intersection with an East-West fence line at the W. 1/4 corner.

PLAN - VIEW

(Show a minimum of three reference ties to durable physical objects, relevant monuments and physical conditions that will enable recovery of the corner.)

SW CORNER  
SEC. 32-74-27  
Set C.I.R. #6808

NW CORNER  
SW. 1/4 SW. 1/4  
SEC. 32-74-27  
Set C.I.R. #6808

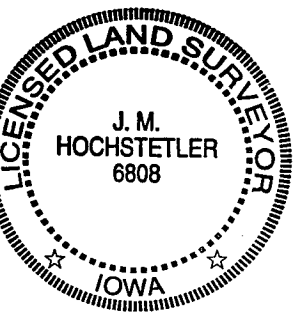
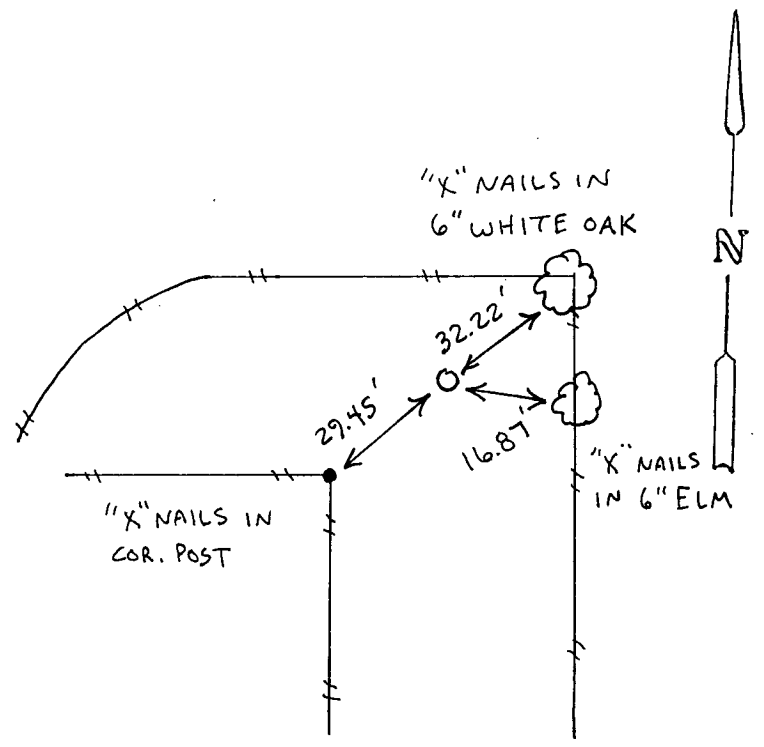
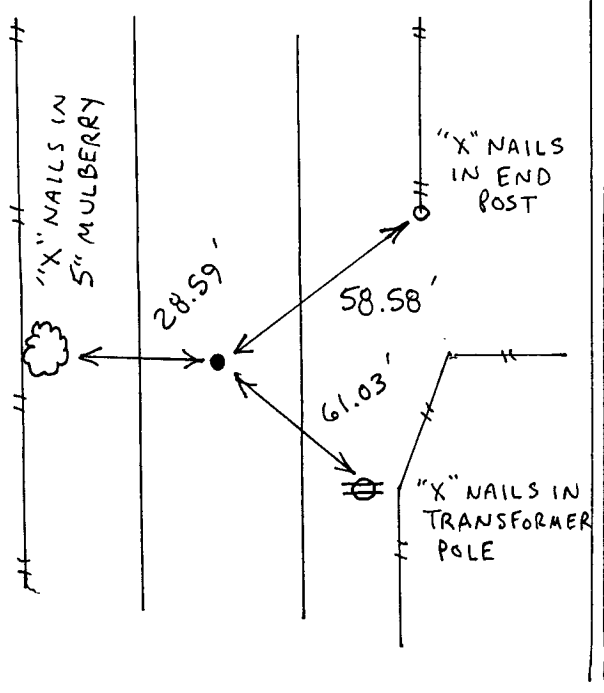
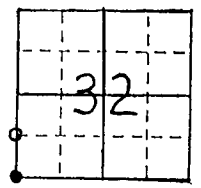

I hereby certify that this land surveying document was prepared and the related survey work was performed by me or under my direct personal supervision and that I am a duly licensed Land Surveyor under the laws of the State of Iowa.  
J. M. Hochstetler  
J. M. HOCHSTETLER  
License number 6808 Date 7/12/99  
My license renewal date is December 31, 1999.  
Pages or sheets covered by this seal: 1

List Corners to be Indexed

Corners	Section	Twp	Range
SW cor.	32	74N	27W
NW cor.	32	74N	27W
SW. 1/4 SW. 1/4	32	74N	27W