

COMPUTER   
RECORDED   
COMPARED

REC \$ 500  
AUD \$ \_\_\_\_\_  
R.M.F. \$ 100

FILED NO. 000143  
BOOK 2 PAGE 81  
1999 JUL -9 PM 2:07

Prepared By: J. Brian Morrissey, Morrissey Surveying, 1926 Pammel Park Road, Winterset, MO 64073, Tel. (515) 462-2166  
MICHELLE UTSLER  
MADISON COUNTY, IOWA

# UNITED STATES PUBLIC LAND SURVEY CORNER CERTIFICATE OF

Land Survey Monuments situated in Section 11, Township 75 N, Range 28 W, of the Fifth Principal Meridian, Madison County, Iowa.  
Previously recorded in N.A. in County Recorders Office.  
(book, page, document number, etc.)

(Show reason for preparing this certificate, the evidence and detailed procedures used in establishing the corner positions and monumentation found or placed.)

Monument Description and Remarks: Found 12" x 14" x 6" granite stone documented previously by IDOT in 1973, accepted position.

## PLAN VIEW

(Show a minimum of three reference ties to durable physical objects, relevant monuments and physical conditions that will enable recovery of the corner.)

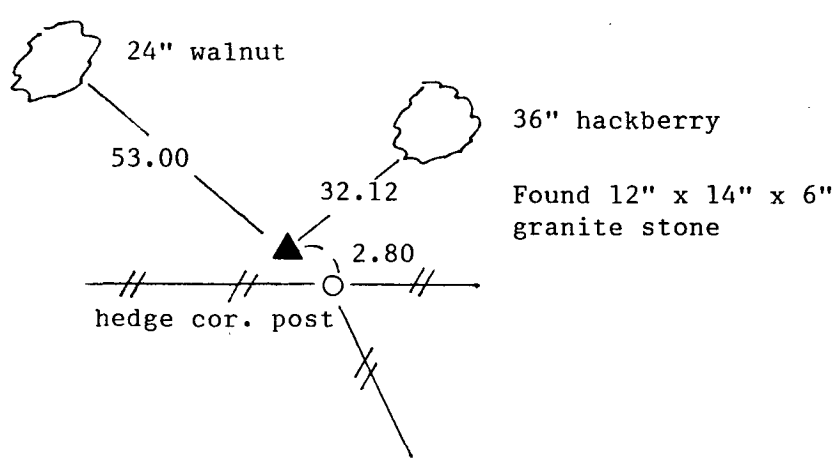
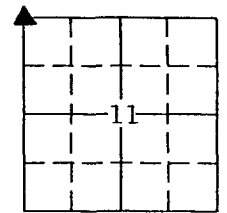

NW. COR. SECTION 11

NOTE: ALL TIES TO "X" NAILS UNLESS NOTED



I hereby certify that the survey work was completed and this certificate was prepared by me or under my direct personal supervision and that I am a duly Licensed Land Surveyor under the laws of the State of Iowa.

Signature: J. Brian Morrissey Date: 7/8/99  
J. Brian Morrissey

License number 7995.  
My license renewal date is December 31, 1999.

262-98-1