

REC \$ 5.00

AUD \$

R.M.F. \$ 1.00

COMPUTER

RECORDED

COMPARED

FILED NO. 000752

BOOK 2 PAGE 88

99 AUG 20 PM 1:28

MICHELLE UTSLER  
RECORDER  
MADISON COUNTY, IOWA

BL 519-90

# UNITED STATES PUBLIC LAND SURVEY CORNER CERTIFICATE OF

Land Survey Monuments situated in Section 15, Township 74 North, Range 26 West, of the Fifth Principal Meridian, Madison County, Iowa.

Previously recorded in \_\_\_\_\_ in County Recorder's Office.  
(book, page, document number, ect.)

(Show reason for preparing this certificate, the evidence and detailed procedures used in establishing the corner positions and found or placed.)

Monument Description and Remarks: Center - Set at the intersection of the quarter-section lines.

SE Cor. SW 1/4 NE 1/4 - Set at the split between the Center of section and the E 1/4 Cor.

## PLAN - VIEW

(Show a minimum of three reference ties to durable physical objects, relevant monuments and physical conditions that will enable recovery of the corner)

CENTER SEC. 15-74-26

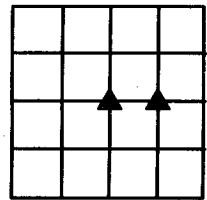
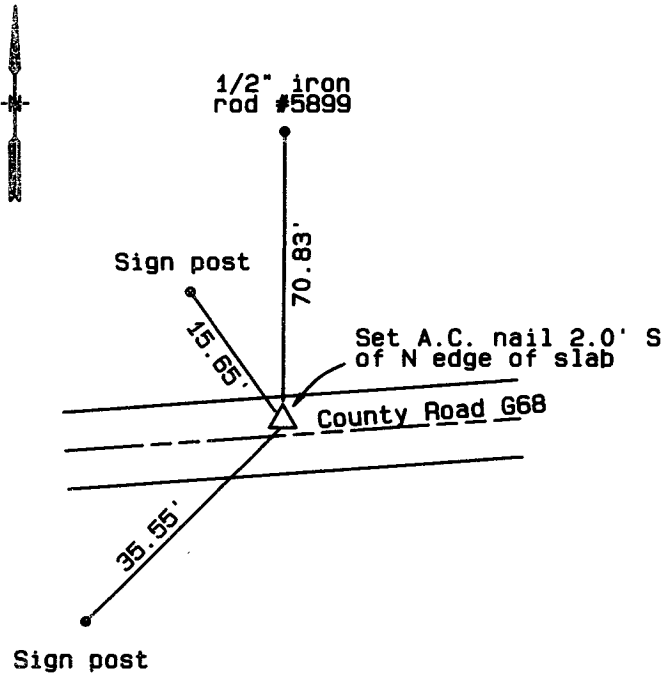

SE COR. SW 1/4 NE 1/4 SEC. 15-74-26

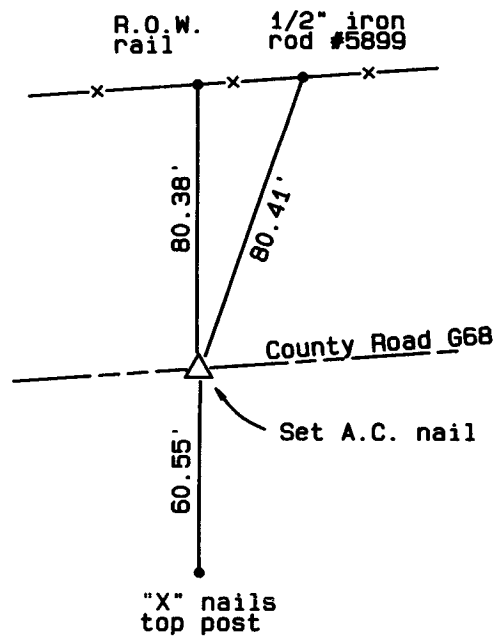

I hereby certify that this land surveying document was prepared and the related survey work was performed by me or under my direct personal supervision and that I am a duly licensed Land Surveyor under the laws of the State of Iowa.

Signed

Date

*James V. Rash*

*7-27-99*

James V. Rash, L.S.  
Iowa license No. 5899

My license renewal date is December 31, 1999

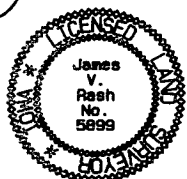

### List Corners to be Indexed

Corners	Section	Twp.	Range
CENTER	15	74	26
SE COR. SW 1/4 NE 1/4	15	74	26