

MICHELLE UTSLER
RECORDER
MADISON COUNTY, IOWA

COMPUTER

RECORDED

COMPARED

RECS 500

AUDS _____

R.M.F. \$ 100

VANCE & HOCHSTETLER, P.C., CONSULTING ENGINEERS, WINTERSSET, IOWA (515) 462-3995
CHARLES T. VANCE, 110 West Green St., Winterset, Iowa, 50273
JAMES M HOCHSTETLER, 110 West Green St., Winterset, Iowa 50273

UNITED STATES PUBLIC LAND SURVEY CORNER CERTIFICATE

Land Survey Monuments situated in Section 14 OF 14 Township 77 N, Range 26 W, of the Fifth Principal Meridian, MADISON County, Iowa.
Previously recorded in _____ in County Recorder's Office.
(book, page, document number, etc.)

(Show reason for preparing this certificate, the evidence and detailed procedures used in establishing the the corner positions and monumentation found or placed.)

Monument Description and Remarks: S.W. COR SEC. 14-77-26 - Could not find any records of the corner being found or used in the County Surveyor's records or old road records. No property line fences on either side but old road dedications indicate road centerline was Section line. Used certified corners at S $\frac{1}{4}$ Cor Sec. 15, SEC COR SEC. 14, and old fence line at approx S $\frac{1}{4}$ Cor Sec. 14 and original survey measurement to set location.

PLAN - VIEW

(Show a minimum of three reference ties to durable physical objects, relevant monuments and physical conditions that will enable recovery of the corner.)

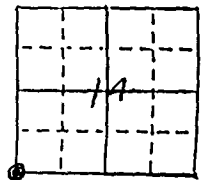

SW COR
SEC. 14-77-26
SET CIR # 6808

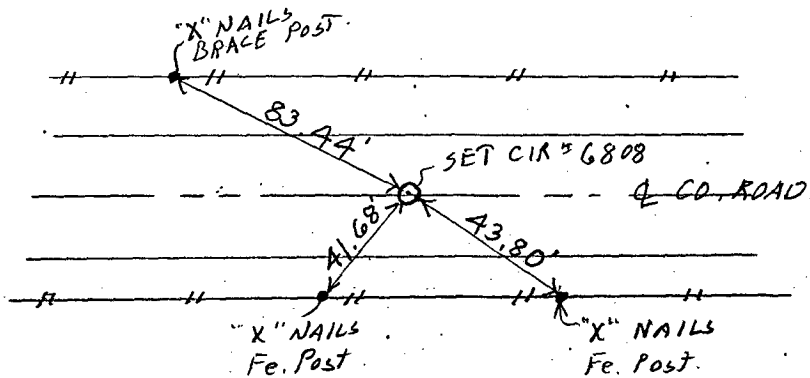

List Corners to be Indexed

Corners	Section	Twp	Range
SW COR	14	77N	26W

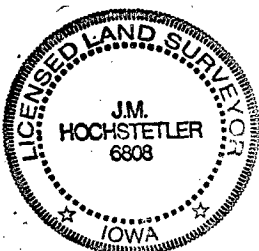

I hereby certify that this land surveying document was prepared and the related survey work was performed by me or under my direct personal supervision and that I am a duly licensed Land Surveyor under the laws of the State of Iowa.

J.M. Hochstetler
J.M. HOCHSTETLER
License number 6808 Date 12/9/98
My license renewal date is December 31, 1999.
Pages or sheets covered by this seal: 1