

COMPUTER
RECORDED
COMPARED

REC \$ 5.00
AUD \$ _____
R.M.F. \$ 1.00

MICHELLE UTSLER
RECORDER
MADISON COUNTY, IOWA

VANCE & HOCHSTETLER, P.C., CONSULTING ENGINEERS, WINTERSSET, IOWA (515) 462-3995

CHARLES T. VANCE, 110 West Green St., Winterset, Iowa, 50273
JAMES M HOCHSTETLER, 110 West Green St., Winterset, Iowa 50273

UNITED STATES PUBLIC LAND SURVEY CORNER CERTIFICATE

Land Survey Monuments situated in Section 14 OF 14 Township 75 N Range 28 W of the Fifth Principal Meridian, MADISON County, Iowa.
Previously recorded in _____ in County Recorder's Office.
(book, page, document number, etc.)

(Show reason for preparing this certificate, the evidence and detailed procedures used in establishing the the corner positions and monumentation found or placed.)

Monument Description and Remarks: SW COR SE 1/4 SE 1/4 - Set CIR # 6808 based on ties filed in County Engineer's Office by Iowa DOT. which noted a limestone found. Old Co. Road Survey by E.B. Hiatt in 1915 also noted a Stone at this corner. We could not find stone but a driveway and culvert had been installed in the area. N.W. COR. SE 1/4 SE 1/4 - Set CIR # 6808 at old Property line fence corner. N.E. COR SE 1/4 SE 1/4 - Set CIR # 6808 at old Property line fence corner.

PLAN - VIEW

(Show a minimum of three reference ties to durable physical objects, relevant monuments and physical conditions that will enable recovery of the corner.)

SW COR SE 1/4 SE 1/4
SET CIR # 6808

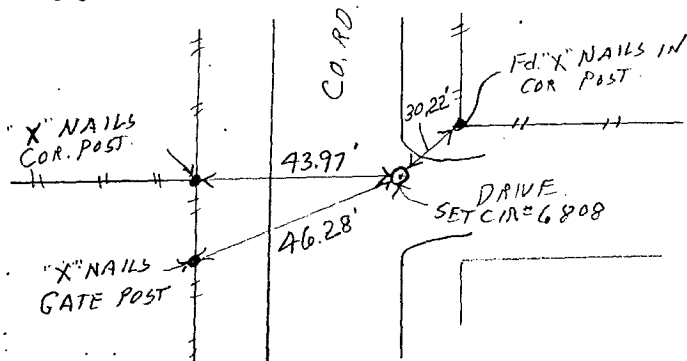

N.E. COR SE 1/4 SE 1/4
SET CIR # 6808

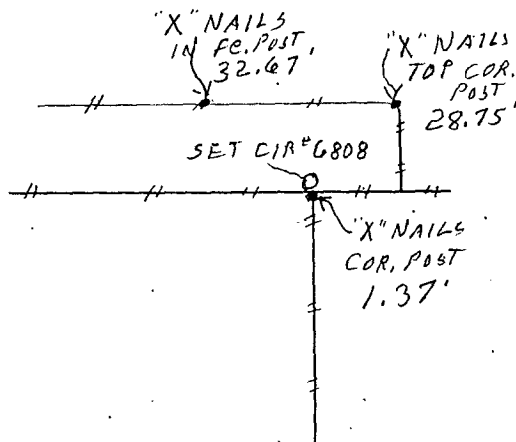
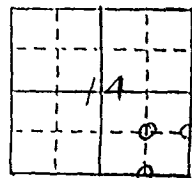

NW COR SE 1/4 SE 1/4
SET CIR # 6808

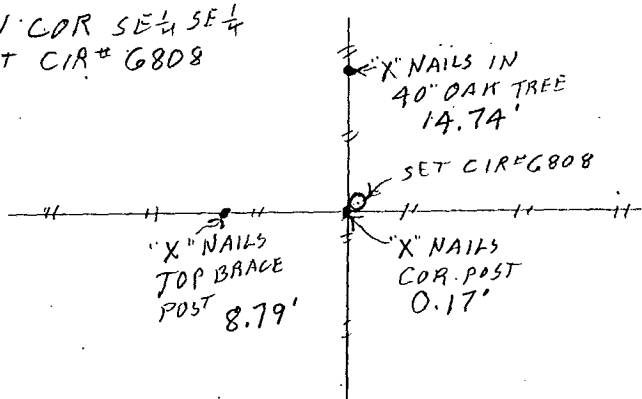

List Corners to be Indexed

Corners	Section	Twp	Range
SW COR SE 1/4 SE 1/4	14	75N	28W
NW COR SE 1/4 SE 1/4	14	75N	28W
N.E. COR SE 1/4 SE 1/4	14	75N	28W

I hereby certify that this land surveying document was prepared and the related survey work was performed by me or under my direct personal supervision and that I am a duly licensed Land Surveyor under the laws of the State of Iowa.

J.M. Hochstetler
J.M. HOCHSTETLER
License number 6808
Date 12/7/98
My license renewal date is December 31, 1999.
Pages or sheets covered by this seal: 1

