

COMPUTER
 RECORDED
 COMPARED
 REC \$ 5.00
 AUD \$ _____
 R.M.F. \$ 1.00

FILED NO. 2762
 BOOK 2 PAGE 14
 99 JAN -6 PM 3:30
 MICHELLE UTSLER
 RECORDER
 MADISON COUNTY, IOWA

RETURN TO SNYDER & ASSOCIATES, INC. 501 SW ORALABOR ROAD, ANKENY, IOWA 50021 (888) 964-2020

UNITED STATES PUBLIC LAND SURVEY CORNER CERTIFICATE OF

Land Survey Monuments situated in Section 10, Township 75, Range 27, of the Fifth Principal Meridian, MADISON, County, Iowa.
 Previously recorded in N/A in County Recorder's Office.
 (book, page, document number, ect.)

(Show reason for preparing this certificate, the evidence and detailed procedures used in establishing the corner positions and monumentation found or placed.)

Monument Description and Remarks: _____

- ① FOUND IP @ CENTERLINE ROADS USING OLD COUNTY TIES.
- ② SET IP W/CAP 11804 @ Q ROAD BY DIVISION FROM EXISTING MONUMENTS NORTH & SOUTH.

Plan-View

(Show a minimum of three reference ties to durable physical objects, relevant monuments and physical conditions that will enable recovery of the corner.)

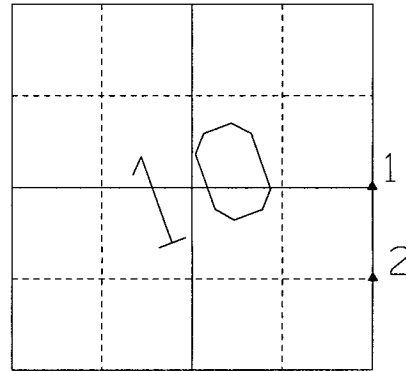
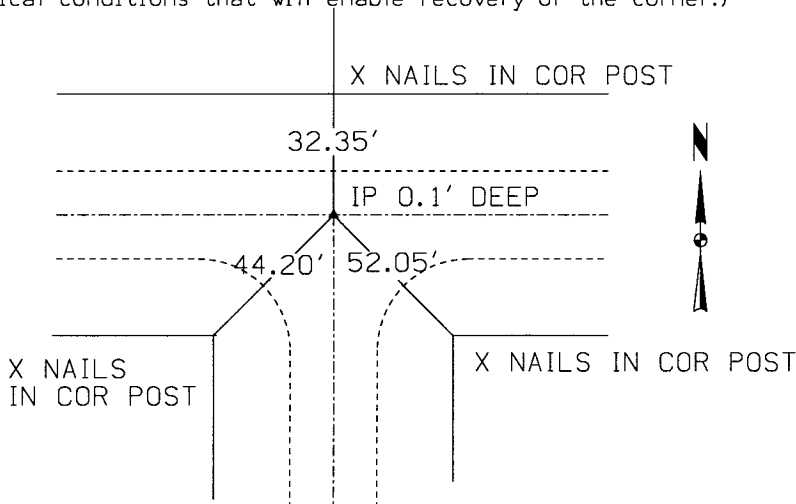

NO. 1 - E 1/4 COR 10-75-27

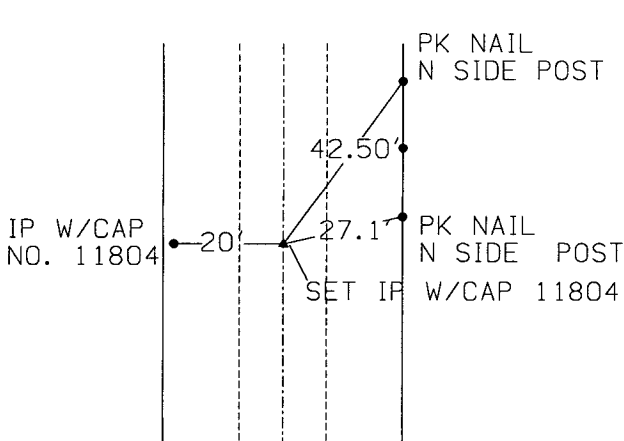

NO. 2 - NE COR, SE 1/4, SE 1/4 10-75-27

List Corners to be Indexed

Corners	Section	Twp	Range
① E 1/4 CORNER	10	75	27
② NE CORNER SE SE 10	10	75	27

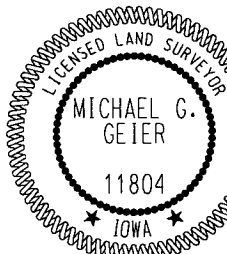

I hereby certify that this land surveying document was prepared and the related surveying work was performed by me or under my direct supervision and that I am a duly licensed Land Surveyor under the laws of the State of Iowa.

Michael G. Geier 1-4-99
 Michael G. Geier, L.S. Date
 License Number 11804
 My License Renewal Date is December 31, 1999
 Pages or sheets covered by this seal:

