



Document 2011 480

Book 2011 Page 480 Type 06 043 Pages 1
Date 2/15/2011 Time 10:03 AM
Rec Amt \$9.00

INDX ✓
ANNO ✓
SCAN
CHEK

LISA SMITH, COUNTY RECORDER
MADISON COUNTY IOWA

Coffman Engineering and Surveying 909 Poplar St. Atlantic, IA 50022 (712) 243-3015

UNITED STATES PUBLIC LAND SURVEY CORNER CERTIFICATE

Land Survey Monuments situated in Section 21, Township 77N, Range 29W of the Fifth Principal Meridian, Madison County, Iowa. Previously recorded in Book 2 Page 168 in the County Recorder's Office.
Monument Description and Remarks:

Found copy of corner certificate recorded 7/31/2000 in County Engineer's Office. Looked for yellow plug in concrete pavement but did not find it. Pulled ties to grader blades and chalked the intersection of the ties but still could not find yellow plug as stated on corner certificate. The pavement in this area has been patched and plug appears to be obliterated. Chiseled X in pavement at intersection of ties to mark the location of the corner as per the ties on the corner certificate.

Plan View

(Show a minimum of three reference ties to durable physical objects, relevant monuments and physical conditions that will enable recovery of the corner.)

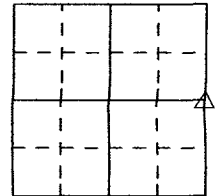
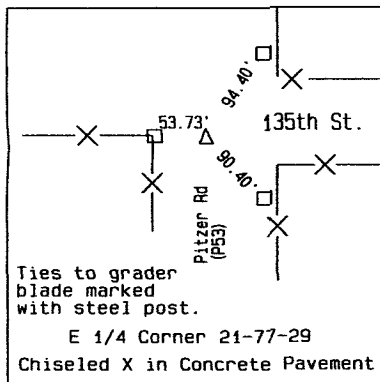

No scale

All distances are horizontal distance.

- 1/2" rebar with red plastic cap Coffman 9331
- △ section corner monument set
- ▲ section corner monument found

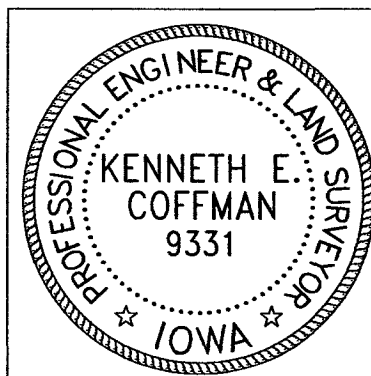

I hereby certify that this land surveying document was prepared by me or under my direct supervision and that I am a duly Licensed Land Surveyor under the laws of the State of Iowa.

Kenneth E. Coffman Lic. No. 9331
Kenneth E. Coffman
Signature
Date 12/14/2011
Pages or sheets covered by this seal 1
My renewal date is December 31, 2011