



Document 2010 2220

Book 2010 Page 2220 Type 06 001 Pages 3

Date 9/15/2010 Time 10:06 AM

Rec Amt \$19.00

INDX
ANNO
SCAN

LISA SMITH, COUNTY RECORDER
MADISON COUNTY IOWA

CHEK

UJ

PLEASE RETURN TO:

MIDAMERICAN ENERGY ATTN: RIGHT-OF-WAY SERVICES P.O. BOX 657 DES MOINES, IA 50306-0657

Prepared by: Bob Young 515 242 6747

**MIDAMERICAN ENERGY COMPANY
OVERHEAD ELECTRIC LINE EASEMENT**

Folder No. 067-10
Work Req. No. DR2179406
Project No. 01145

State of Iowa
County of Madison
Section 1
Township 77 North
Range 28 West of the 5th P.M.

KNOW ALL MEN BY THESE PRESENTS:

For and in consideration of the sum of One and no/100-----Dollar (\$1.00), and other valuable consideration, in hand paid by MIDAMERICAN ENERGY COMPANY, an Iowa Corporation, receipt of which is hereby acknowledged, the undersigned **JSC Properties Inc. an Iowa Corporation** (Grantors), heirs and assigns, do hereby grant to MIDAMERICAN ENERGY COMPANY (Grantee), its successors or assigns, the right to construct, maintain, and operate an electrical supply line, and communications lines or cables and including the necessary poles, wires, guys, guy stubs, anchors and other necessary equipment, upon, over, along, and across certain real estate described below, together with the right to enter upon the said real estate for the purpose of constructing, maintaining, or removing said lines or cables, and the right to trim or remove, with reasonable care, such trees as may interfere with the proper maintenance or operation thereof, and the right to remove from the strip of land specifically described below any obstruction, including buildings and other structures, which interfere with proper maintenance and operation of said lines or cables. Grantors agree that they will not construct or place any permanent buildings, structures, trees, plants; or other objects on the property described below. Grantors agree not to perform any construction that would change the existing grade resulting in a violation of the minimum clearance requirements of the National Electric Safety Code or that would interfere with the operation and maintenance of the lines or cables.

MIDAMERICAN ENERGY COMPANY will repair or pay for any damage which may be caused to fences, or other property of the undersigned by the construction, maintenance, operation, or removal of said lines or cables.

EASEMENT DESCRIPTION:

An overhead electric line and anchor easement as generally depicted on Exhibit "A", attached hereto and made a part hereof; situated on the following described property:

The East Half of the Northeast Quarter (E1/2 NE1/4) of Section One (1), Township 77, North of Range 28 West of the 5th P.M., Madison County, Iowa.

This easement shall be binding upon the heirs, successors, and assigns of both parties. Grantors shall have the right of full enjoyment and use of the above described property except as such that will be inconsistent with this easement.

Dated this 19th day of August, 2010.

JSC Properties Inc. an Iowa Corporation

By: *Paul D. Hayes*
Name Paul D. Hayes
Title President

ACKNOWLEDGMENT

STATE OF IOWA)
COUNTY OF Polk) ss



This instrument was acknowledged before me on 19 August, 2010, by
PAUL D. HAYES of, **JSC Properties Inc. an Iowa Corporation**

Fran Faust
Notary Public in and for said State

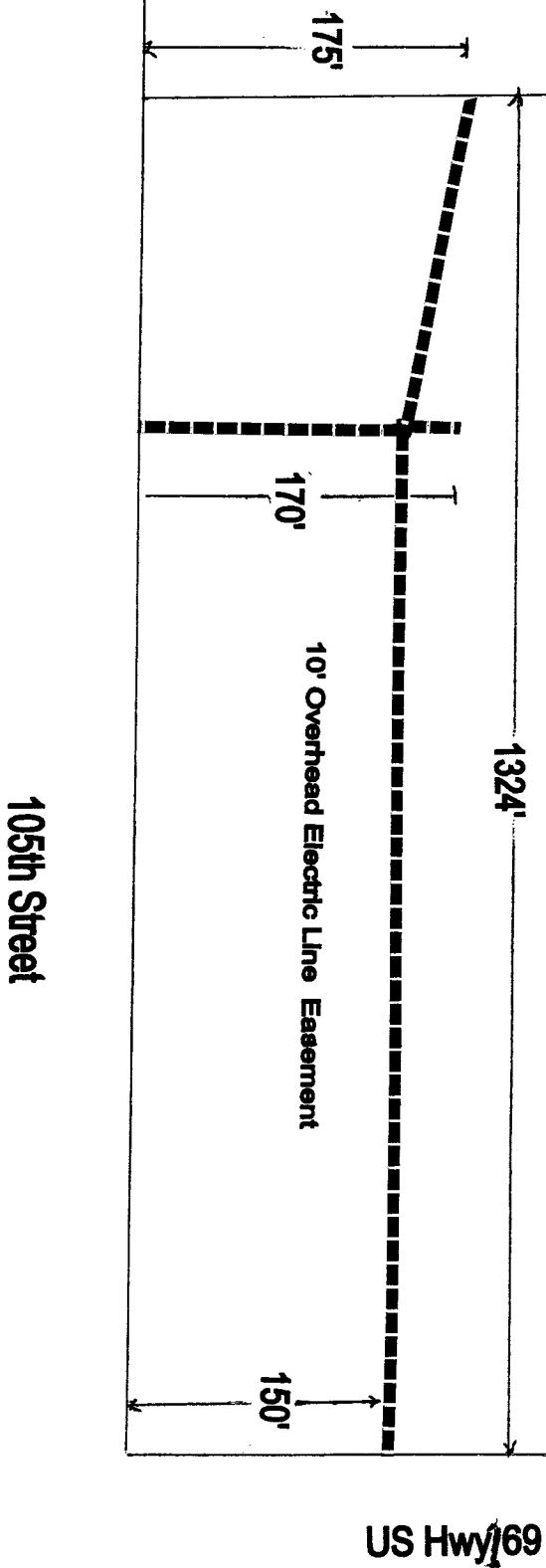

Exhibit "A"



 MidAmerican ENERGY	Customer: JSC Properties Inc	DR21279406	
	Address: 105th Street	Date: 7/6/10	
Crew HQ:	City: Desoto Madison County, Iowa	XY Grid:	
Job Desc: Overhead Electric Line Easement		//////////////// = Easement Marking	