



Document 2010 1670

Book 2010 Page 1670 Type 06 043 Pages 1
Date 7/21/2010 Time 12:07 PM
Rec Amt \$9.00

INDX ✓
ANNO
SCAN
CHEK

LISA SMITH, COUNTY RECORDER
MADISON COUNTY IOWA

✓ PREPARED BY & RETURN TO MARK F. WANDRO, SNYDER & ASSOCIATES, INC. 2727 SW SNYDER ROAD, ANKENY, IOWA 50023 (515) 964-2020

UNITED STATES PUBLIC LAND SURVEY CORNER CERTIFICATE OF

Land Survey Monuments situated in Section 03, Township 77 N, Range 26 W, of the Fifth Principal Meridian, MADISON, County, Iowa.
Previously recorded in N/A in County Recorder's Office.
(book, page, document number, ect.)

(Show reason for preparing this certificate, the evidence and detailed procedures used in establishing the corner positions and monumentation found or placed.)

Monument Description and Remarks:

NW CORNER OF SECTION 03-77-26.

NO RECORDED CORNER CERTIFICATE OR MADISON COUNTY ENGINEERS TIES WERE FOUND. SEARCHED AREA USING A METAL DETECTOR AND FOUND NOTHING. SET 1/2" REBAR YPC #11465 BASED ON PLAT OF SURVEY DATED 11/28/1894 IN BOOK 31, PAGE 89.

Plan-View

(Show a minimum of three reference ties to durable physical objects, relevant monuments and physical conditions that will enable recovery of the corner.)

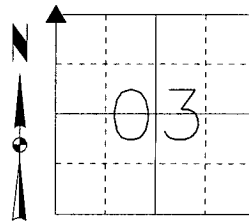

NORTHWEST CORNER
SET 1/2" REBAR YPC #11465.

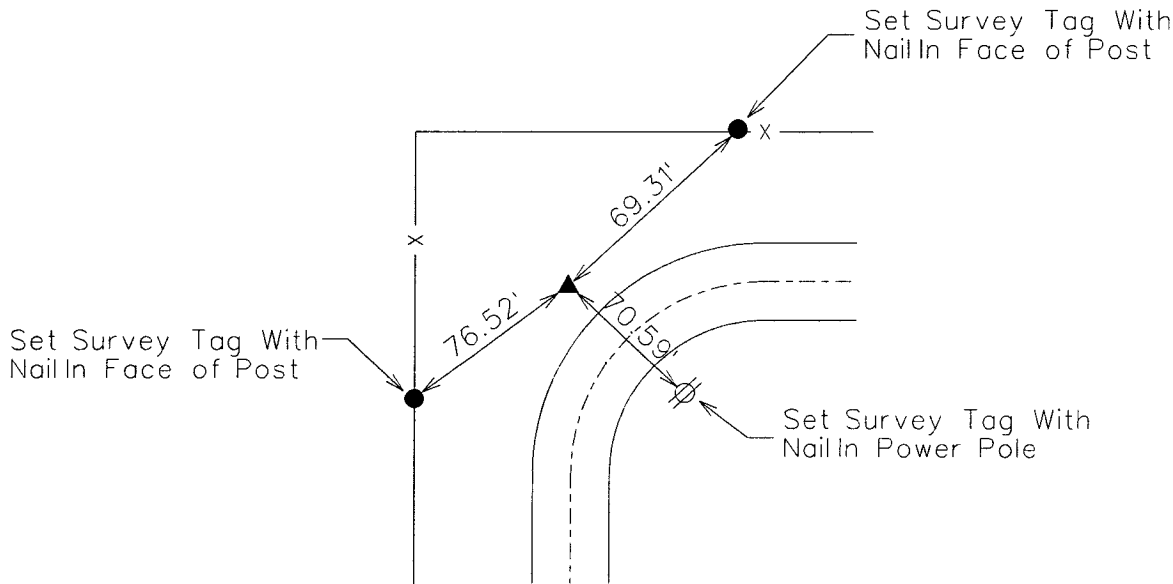

NOTE: ALL DISTANCES MEASURED HORIZONTAL UNLESS OTHERWISE NOTED.

S&A C10

JCC
6/28/2010
D:\Projects\3\77-26_03_NW.dgn

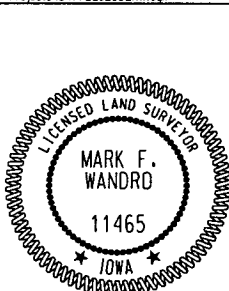

I hereby certify that this land surveying document was prepared and the related survey work was performed by me or under my direct personal supervision and that I am a duly licensed Land Surveyor under the laws of the State of Iowa.
Mark F. Wandro 6/28/10
Mark F. Wandro, PLS Date
License Number 11465
My License Renewal Date is December 31, 2010
Pages or sheets covered by this seal:
SHEET 1 OF 1

List Corners to be Indexed

Corners	Section	Twp	Range
NW CORNER	03	77	26
NE CORNER	04	77	26
SW CORNER	34	78	26
SE CORNER	33	78	26

TECH: JCC/KG

PN: 03_77_26_NW

DATE: 6/08/10