

CERTIFICATION OF VOLUNTARY ANNEXATION RECORD

I, Mark Nitchals, City Administrator of the City of Winterset, Iowa, hereby certify that the attached Resolution and accompanying Applications for Annexation and plat as shown as Exhibit "A" is a true copy as shown by the records of the City of Winterset, Iowa.

Witness my hand and the Corporate Seal of said City hereto affixed this 4th day of December, 1989.

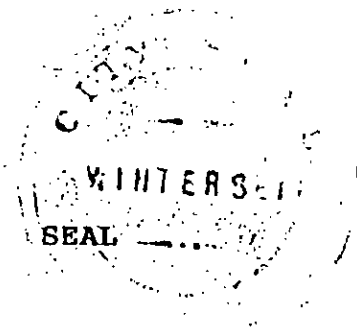

  
\_\_\_\_\_  
Mark Nitchals, City Administrator

*Compared*

FILED NO. 1346  
BOOK 55 PAGE 531  
89 DEC 28 PM 12: 01  
MARY E. WELTY  
RECORDER  
MADISON COUNTY, IOWA  
Fee \$115.00

RESOLUTION 89-115

RESOLUTION ASSENTING TO THE ANNEXATION  
OF CERTAIN REAL ESTATE  
TO THE CITY OF WINTERSSET, IOWA

WHEREAS, the City of Winterset, State of Iowa, is a duly organized municipal corporation;

WHEREAS, pursuant to Section 368.7 of the Code of Iowa, there has been presented to the City Council of the City of Winterset Applications for Annexation executed by the following listed owners of the real estate to be annexed;

PROPERTY OWNERS

B.B. & P. Feed and Grain, Inc.

Adams-Thompson Implement, Inc.

Madison County

Gretchen M. Casper  
Robert M Casper  
Peggy Casper  
John E. Casper  
Winnie Casper

Wight & Short Service, Inc.

Catherine Kilpatrick

Clarence E. Johnson

T. Wayne Tilton

Robert M. Casper  
Peggy Casper

Gretchen M. Casper  
Robert M. Casper  
Peggy Casper  
John E. Casper  
Winnie Casper  
Ronald Baker  
Dorothy Sue Baker

Bill W. Farlow  
Kathryn A. Farlow  
Marvin Cox  
Mary A. Cox

City of Winterset

WHEREAS, all real estate described on the above listed Applications for Annexation, as detailed on the attached Exhibit "A", is adjacent to the existing City limits as shown on the accompanying plat map marked as Exhibit "B".

WHEREAS, The City of Winterset, Iowa desires to annex said territory upon the Applications presented.

NOW, THEREFORE, BE IT RESOLVED by the City Council of the City of Winterset, Iowa as follows:

1. That the Application for Annexation of the real estate as described in Exhibit "A" attached hereto is hereby approved.

2. That on the passage of this Resolution this territory

shall thereafter be and become a part of the City of Winterset, Iowa.

3. That the Administrator shall forthwith cause this Resolution and the exhibits attached hereto to be filed with the City Development Board, the Madison County Recorder, the Iowa Secretary of State, and the District Office of the Iowa Department of Transportation as required by Section 368.7 of the Code of Iowa.

PASSED and APPROVED this 4th day of December, 1989.

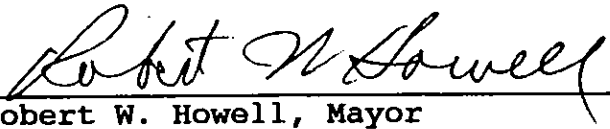
  
Robert W. Howell, Mayor

ATTEST:

  
Mark Nitchals, City Administrator

EXHIBIT A

Name of Owner(s):

B. B. & P. Feed and Grain, Inc.

Legal Description:

A parcel of land described as commencing at the Southeast Corner of Section 25, T76N, R28W of the 5th P.M., Madison County, Iowa; thence North 0°00' 791.45 feet along the east section line to the point of beginning; thence North 90°00' West 500.00 feet; thence North 0°00' 404.60 feet; thence North 81°13' East 505.93 feet to the east section line; thence South 0°00' 481.81 feet to the point of beginning except public road right of way.

Plat Map Key: 2.

\* \* \* \* \*

Name of Owner(s):

Adams-Thompson Implement, Inc.

Legal Description:

A parcel of land described as commencing at the Southeast Corner of Section 25, T76N, R28W of the 5th P.M., Madison County, Iowa; thence North 0°00' 1,601.40 feet along the east section line to the Point of Beginning; thence continuing North 0°00' 314.00 feet; thence North 90°00' West 500.00 feet; thence South 0°00' 314.00 feet; thence North 90°00' East 500.00 feet to the Point of Beginning except public road right of way.

Plat Map Key: 4.

\* \* \* \* \*

Name of Owner(s):

Gretchen M. Casper  
Robert M Casper  
Peggy Casper  
John E. Casper  
Winnie Casper

Legal Description:

The East Half (E.½) of the Southeast Quarter of Section 25, T76N, R28W of the 5th P.M., Madison County except a parcel described as commencing at a point on the east line of said Section 25 304.95 feet north of the Southeast Corner of said Section 25; thence West 500.00 feet; thence North 1,781.45 feet; thence East 500.00 feet; thence South 1,781.45 feet to the Point of Beginning and except public road right of way.

Plat Map Key: 6.

\* \* \* \* \*

Name of Owner(s):

T. Wayne Tilton

Legal Description:

The East Half of the Northwest Quarter of the Southeast Quarter and the Southwest Quarter of the Southeast Quarter of Section 25; T76N, R28W of the 5th P.M., Madison County, Iowa except public road right of way.

Plat Map Key: 7.

\* \* \* \* \*

5  
Name of Owner(s):

Gretchen M. Casper  
Robert M. Casper  
Peggy Casper  
John E. Casper  
Winnie Casper

Legal Description:

The West Half of the Northwest Quarter of the Southeast Quarter of Section 25, T76N, R28W of the 5th P.M., Madison County, Iowa except public road right of way.

Plat Map Key: 8.

\* \* \* \* \*

Name of Owner(s):

Clarence E. Johnson

Legal Description:

The Northeast Quarter and the North Half of the North Half of the Southeast Quarter of Section 35, T76N, R28W of the 5th P.M., Madison County, Iowa except the right of way of relocated Primary Road No. U.S. 169 and except a parcel described as commencing at the North Quarter Corner of Section 35, T76N, R28W of the 5th P.M., Madison County, Iowa thence North 90°00'00" East 91.66 feet along the North line of the Northeast Quarter of said Section 35 to the Point of Beginning; thence continuing North 90°00'00" East 1455.09 feet to a point on the Northerly right of way line of U.S. Highway 169 and Iowa Highway 92; thence along said highway right of way South 62°33'48" West 524.71 feet; thence North 83°44'36" West 280.32 feet; thence South 4°04'30" West 8.95 feet to the centerline of a county road; thence along said county road centerline Northwesterly 612.81 feet along a 818.50 feet radius curve concave southerly with a 598.59 feet long chord bearing North 68°26'30" West; thence North 89°55'31" West 153.39 feet to the Point of Beginning.

Plat Map Key: 9.

\* \* \* \* \*

Name of Owner(s):

City of Winterset

Legal Description:

A parcel described as commencing at the Center of Section 31, T76N, R27W of the 5th P.M., Madison County, Iowa thence South 0°00'00" 1,056.53 feet along the West line of the Southeast Quarter of said Section 31 to centerline of Court Avenue which is the Point of Beginning; thence South 89°44'18" East 416.43 feet along said centerline of Court Avenue; thence South 89°21'18" East 323.58 feet along said centerline of Court Avenue; thence South 0°00'00" 447.84 feet; thence North 89°44'18" West 740.00 feet to West line of the Southeast Quarter of Section 31; thence North 0°00'00" 450.00 feet to Point of Beginning.

Plat Map Key: 53.

\* \* \* \* \*

Name of Owner(s):

Wight & Short Service, Inc.

Legal Description:

Commencing at the Center of Section 31, T76N, R27 West of the 5th P.M., Madison County, Iowa, thence South 0°00' East along the West line of the Southeast Quarter of said Section 31 1,056.22 feet to the centerline of the Easterly extension of Court Avenue in Winterset, Iowa; thence North 89°37' East 474.0 along said centerline, thence North 90°00' East 75.0 feet along said centerline; thence North 0°00' East 55.0 feet to the Point of Beginning; thence North 0°00' East 185.0 feet; thence North 90°00' East 200.00 feet; thence South 0°00' East 185.0 feet; thence North 90°00' West 200.0 feet to the Point of Beginning.

Plat Map Key: 55.

\* \* \* \* \*

Name of Owner(s):

Bill W. Farlow  
Kathryn A. Farlow  
Marvin Cox  
Mary A. Cox

Legal Description:

All that part of the West 233 feet of the East 783 feet of the Northwest Quarter of the Southeast Quarter of Section 31, T76N, R27W of the 5th P.M., Madison County, Iowa lying North of the Public Highway running East and West through said forty acre tract; and except the North 198 feet of the West 233 feet of the East 783 feet of said Northwest Quarter of the Southeast Quarter.

Plat Map Key: 56.

\* \* \* \* \*

Name of Owner(s):

Catherine Kilpatrick

Legal Description:

All that part of the Northwest Quarter of the Southeast Quarter of Section 31, T76N, R27W of the 5th P.M., lying North of the public highway running East and West through said forty acre tract and connecting with Court Avenue in Winterset, Iowa, and South of the right of way of the Chicago, Rock Island and Pacific Railway Company (excepting there from a tract 30 feet in width off of the West side thereof and a tract 783 feet in width off of the East side thereof) and except a parcel in the Northwest Corner thereof described as commencing at the Northwest Corner of the Northwest Quarter of the Southeast Quarter of said Section 31; thence South 198 feet to the South line of the right of way of the Chicago, Rock Island & Pacific Railway Company which is the Point of Beginning, thence East 232 feet; thence South 546.25 feet; thence West 232 feet to the West line of said Northwest Quarter of the Southeast Quarter; thence North 546.25 feet to the Point of Beginning, and except a parcel commencing at the northwest corner of the Southeast Quarter of Section 31, Township 76 North, Range 27 West of the Fifth Principal Meridian, Madison County, Iowa; thence on an assumed bearing of North 90 degrees 00 minutes 00 seconds East along the north line of said Southeast Quarter 232.27 feet; thence South 00

degrees 17 minutes 16 seconds East 198.00 feet to the southerly line of the former right of way of the Chicago, Rock Island and Pacific Railroad and the point of beginning; thence continuing South 00 degrees 17 minutes 16 seconds East 858.38 feet to the centerline of the existing Madison County highway; thence North 89 degrees 44 minutes 17 seconds East along the centerline of the existing Madison County highway 281.58 feet; thence North 00 degrees 09 minutes 49 seconds West 857.08 feet to the southerly line of said former railroad right of way; thence North 90 degrees 00 minutes 00 seconds West 283.44 feet along said former right of way line to the point of beginning and containing 5.56 acres more or less, including 0.36 acres of highway right of way over the southerly 55.00 feet thereof and subject to encumbrances of record.

Plat Map Key: 57.

\* \* \* \* \*

Name of Owner(s):  
Madison County

Legal Description:  
A parcel described as commencing at the Northwest Corner of the Southeast Quarter of Section 31, T76N, R27W of the 5th P.M., Madison County, Iowa; thence South 298 feet along the West line of said Southeast Quarter to the Point of Beginning; thence East 205.0 feet; thence North 100.0 feet; thence East 27.0 feet; thence South 546.25 feet; thence West 232.0 feet; thence North 446.25 feet to the Point of Beginning.

Plat Map Key: 58.

\* \* \* \* \*

Name of Owner(s):  
Gretchen M. Casper  
Robert M. Casper  
Peggy Casper  
John E. Casper  
Winnie Casper  
Ronald Baker  
Dorothy Sue Baker

Legal Description:  
The SE  $\frac{1}{4}$  of the NE  $\frac{1}{4}$  of Section 25, T76N, R28W of the 5th P.M., Madison County, Iowa except a parcel described as commencing at the Northeast Corner of the SE  $\frac{1}{4}$  of the NE  $\frac{1}{4}$  of said Section 25; thence West 500 feet; thence South 500 feet; thence East 500 feet; thence North 500 feet to the Point of Beginning and subject to easements and highway right of way record. The SW  $\frac{1}{4}$  of the NE  $\frac{1}{4}$  of Section 25, T76N, R28W of the 5th P.M., Madison County, Iowa except a parcel described as commencing at a point 24 rods South of the Northwest Corner of the SW  $\frac{1}{4}$  of the NE  $\frac{1}{4}$  of said Section 25, reunning thence East  $9\frac{1}{2}$  rods, thence in a Southwesterly direction following the West side of the Public Highway to a point 48 rods South and 2 rods East of said Northwest Corner, thence West 2 rods, thence North 24 rods to the place of beginning.

Plat Map Key: 62

\* \* \* \* \*

## Name of Owner(s):

Robert M. Casper  
Peggy Casper

## Legal Description:

A parcel described as commencing at the Northeast Corner of the SE  $\frac{1}{4}$  of the NE  $\frac{1}{4}$  of Section 25, T76N, R28W of the 5th PM, Madison County, Iowa; thence West 500 feet; thence South 500 feet; thence East 500 feet; thence North 500 feet to the Point of Beginning and subject to easements and highway right of way record.

Plat Map Key: 63



9.

APPLICATION FOR VOLUNTARY ANNEXATION

TO: CITY OF WINTERSET, IOWA

The undersigned applicants hereby apply to the City of Winterset, Iowa that the following described real estate be annexed to the City of Winterset, Iowa, to-wit:

A parcel described as commencing at the Center of Section 31, T76N, R27W of the 5th P.M., Madison County, Iowa thence South 0°00'00" 1,056.53 feet along the West line of the Southeast Quarter of said Section 31 to centerline of Court Avenue which is the Point of Beginning; thence South 89°44'18" East 416.43 feet along said centerline of Court Avenue; thence South 89°21'18" East 323.58 feet along said centerline of Court Avenue; thence South 0°00'00" 447.84 feet; thence North 89°44'18" West 740.00 feet to West line of the Southeast Quarter of Section 31; thence North 0°00'00" 450.00 feet to Point of Beginning.

The applicants attach hereto as a part of this application a map of the said real estate to be annexed showing its location in relationship to the existing limits of the City of Winterset, Iowa.

The said real estate is not within the urbanized area of a city other than the City to which this Application is directed.

The undersigned applicants do hereby certify that they hold the said real estate by title in fee simple and they have good and lawful authority to make this Application.

Dated on this 4th day of December, 1989.

City of Winterset

  
Robert W. Howell  
Mayor

Attest:

  
Mark Nitchals  
City Administrator

APPLICATION FOR VOLUNTARY ANNEXATION

TO: CITY OF WINTERSSET, IOWA

The undersigned applicants hereby apply to the City of Winterset, Iowa that the following described real estate be annexed to the City of Winterset, Iowa, to-wit:

A parcel described as commencing at the Northeast Corner of the SE  $\frac{1}{4}$  of the NE  $\frac{1}{4}$  of Section 25, T76N, R28W of the 5th PM, Madison County, Iowa; thence West 500 feet; thence South 500 feet; thence East 500 feet; thence North 500 feet to the Point of Beginning and subject to easements and highway right of way record.

The applicants attach hereto as a part of this application a map of the said real estate to be annexed showing its location in relationship to the existing limits of the City of Winterset, Iowa.

The said real estate is not within the urbanized area of a city other than the City to which this Application is directed.

The undersigned applicants do hereby certify that they hold the said real estate by title in fee simple and they have good and lawful authority to make this Application.

Dated on this 19th day of October, 1989.

  
 \_\_\_\_\_  
 Robert M. Casper

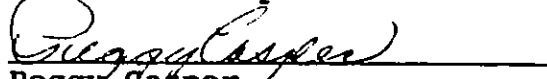
  
 \_\_\_\_\_  
 Peggy Casper  
 A/K/A Margaret Marie Casper

APPLICATION FOR VOLUNTARY ANNEXATION

TO: CITY OF WINTERSET, IOWA

The undersigned applicants hereby apply to the City of Winterset, Iowa that the following described real estate be annexed to the City of Winterset, Iowa, to-wit:

The East Half of the Northwest Quarter of the Southeast Quarter and the Southwest Quarter of the Southeast Quarter of Section 25; T76N, R28W of the 5th P.M., Madison County, Iowa except public road right of way.

The applicants attach hereto as a part of this application a map of the said real estate to be annexed showing its location in relationship to the existing limits of the City of Winterset, Iowa.

The said real estate is not within the urbanized area of a city other than the City to which this Application is directed.

The undersigned applicants do hereby certify that they hold the said real estate by title in fee simple and they have good and lawful authority to make this Application.

Dated on this 31 day of October, 1989.

T. Wayne Tilton

T. Wayne Tilton  
\_\_\_\_\_

APPLICATION FOR VOLUNTARY ANNEXATION

TO: CITY OF WINTERSET, IOWA

The undersigned applicants hereby apply to the City of Winterset, Iowa that the following described real estate be annexed to the City of Winterset, Iowa, to-wit:

The Northeast Quarter and the North Half of the North Half of the Southeast Quarter of Section 35, T76N, R28W of the 5th P.M., Madison County, Iowa except the right of way of relocated Primary Road No. U.S. 169 and except a parcel described as commencing at the North Quarter Corner of Section 35, T76N, R28W of the 5th P.M., Madison County, Iowa thence North 90°00'00" East 91.66 feet along the North line of the Northeast Quarter of said Section 35 to the Point of Beginning; thence continuing North 90°00'00" East 1455.09 feet to a point on the Northerly right of way line of U.S. Highway 169 and Iowa Highway 92; thence along said highway right of way South 62°33'48" West 524.71 feet; thence North 83°44'36" West 280.32 feet; thence South 4°04'30" West 8.95 feet to the centerline of a county road; thence along said county road centerline Northwesterly 612.81 feet along a 818.50 feet radius curve concave southerly with a 598.59 feet long chord bearing North 68°26'30" West; thence North 89°55'31" West 153.39 feet to the Point of Beginning.

The applicants attach hereto as a part of this application a map of the said real estate to be annexed showing its location in relationship to the existing limits of the City of Winterset, Iowa.

The said real estate is not within the urbanized area of a city other than the City to which this Application is directed.

The undersigned applicants do hereby certify that they hold the said real estate by title in fee simple and they have good and lawful authority to make this Application.

Dated on this 26 day of October, 19 89.

Clarence E. Johnson

Clarence E. Johnson

APPLICATION FOR VOLUNTARY ANNEXATION

TO: CITY OF WINTERSSET, IOWA

The undersigned applicants hereby apply to the City of Winterset, Iowa that the following described real estate be annexed to the City of Winterset, Iowa, to-wit:

Commencing at the Center of Section 31, T76N, R27 West of the 5th P.M., Madison County, Iowa, thence South 0°00' East along the West line of the Southeast Quarter of said Section 31 1,056.22 feet to the centerline of the Easterly extension of Court Avenue in Winterset, Iowa; thence North 89°37' East 474.0 along said centerline, thence North 90°00' East 75.0 feet along said centerline; thence North 0°00' East 55.0 feet to the Point of Beginning; thence North 0°00' East 185.0 feet; thence North 90°00' East 200.00 feet; thence South 0°00' East 185.0 feet; thence North 90°00' West 200.0 feet to the Point of Beginning.

The applicants attach hereto as a part of this application a map of the said real estate to be annexed showing its location in relationship to the existing limits of the City of Winterset, Iowa.

The said real estate is not within the urbanized area of a city other than the City to which this Application is directed.

The undersigned applicants do hereby certify that they hold the said real estate by title in fee simple and they have good and lawful authority to make this Application.

Dated on this 31 day of March, 1989.

Wight & Short Service, Inc.

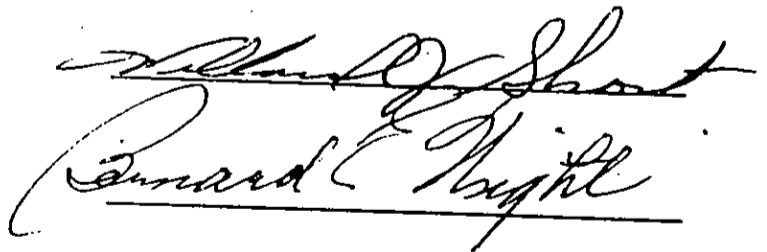
  
Edward J. Short  
Edward C. Wight

14

APPLICATION FOR VOLUNTARY ANNEXATION

TO: CITY OF WINTERSET, IOWA

The undersigned applicants hereby apply to the City of Winterset, Iowa that the following described real estate be annexed to the City of Winterset, Iowa, to-wit:

The West Half of the Northwest Quarter of the Southeast Quarter of Section 25, T76N, R28W of the 5th P.M., Madison County, Iowa except public road right of way.

The applicants attach hereto as a part of this application a map of the said real estate to be annexed showing its location in relationship to the existing limits of the City of Winterset, Iowa.

The said real estate is not within the urbanized area of a city other than the City to which this Application is directed.

The undersigned applicants do hereby certify that they hold the said real estate by title in fee simple and they have good and lawful authority to make this Application.

Dated on this 25th day of April, 1989.

Gretchen M. Casper  
Gretchen M. Casper

Robert M. Casper  
Robert M. Casper

Peggy Casper  
Peggy Casper

John E. Casper  
John E. Casper

Winnie Casper  
Winnie Casper

APPLICATION FOR VOLUNTARY ANNEXATION

TO: CITY OF WINTERSET, IOWA

The undersigned applicants hereby apply to the City of Winterset, Iowa that the following described real estate be annexed to the City of Winterset, Iowa, to-wit:

A parcel of land described as commencing at the Southeast Corner of Section 25, T76N, R28W of the 5th P.M., Madison County, Iowa; thence North 0°00' 1,601.40 feet along the east section line to the Point of Beginning; thence continuing North 0°00' 314.00 feet; thence North 90°00' West 500.00 feet; thence South 0°00' 314.00 feet; thence North 90°00' East 500.00 feet to the Point of Beginning except public road right of way.

The applicants attach hereto as a part of this application a map of the said real estate to be annexed showing its location in relationship to the existing limits of the City of Winterset, Iowa.

The said real estate is not within the urbanized area of a city other than the City to which this Application is directed.

The undersigned applicants do hereby certify that they hold the said real estate by title in fee simple and they have good and lawful authority to make this Application.

Dated on this 20 day of March, 1989.

Adams-Thompson Implement, Inc.

William E. Adams

Adams-Thompson Impl.  
Inc.

APPLICATION FOR VOLUNTARY ANNEXATION

TO: CITY OF WINTERSET, IOWA

The undersigned applicants hereby apply to the City of Winterset, Iowa that the following described real estate be annexed to the City of Winterset, Iowa, to-wit:

The East Half (E.½) of the Southeast Quarter of Section 25, T76N, R28W of the 5th P.M., Madison County except a parcel described as commencing at a point on the east line of said Section 25 304.95 feet north of the Southeast Corner of said Section 25; thence West 500.00 feet; thence North 1,781.45 feet; thence East 500.00 feet; thence South 1,781.45 feet to the Point of Beginning and except public road right of way.

The applicants attach hereto as a part of this application a map of the said real estate to be annexed showing its location in relationship to the existing limits of the City of Winterset, Iowa.

The said real estate is not within the urbanized area of a city other than the City to which this Application is directed.

The undersigned applicants do hereby certify that they hold the said real estate by title in fee simple and they have good and lawful authority to make this Application.

Dated on this 25th day of April, 1989.

Gretchen M. Casper  
Gretchen M. Casper

Robert M. Casper  
Robert M. Casper

Peggy Casper  
Peggy Casper

John E. Casper  
John E. Casper

Winnie Casper  
Winnie Casper



7

APPLICATION FOR VOLUNTARY ANNEXATION

TO: CITY OF WINTERSET, IOWA

The undersigned applicants hereby apply to the City of Winterset, Iowa that the following described real estate be annexed to the City of Winterset, Iowa, to-wit:

A parcel of land described as commencing at the Southeast Corner of Section 25, T76N, R28W of the 5th P.M., Madison County, Iowa; thence North 0°00' 791.45 feet along the east section line to the point of beginning; thence North 90°00' West 500.00 feet; thence North 0°00' 404.60 feet; thence North 81°13' East 505.93 feet to the east section line; thence South 0°00' 481.81 feet to the point of beginning except public road right of way.

The applicants attach hereto as a part of this application a map of the said real estate to be annexed showing its location in relationship to the existing limits of the City of Winterset, Iowa.

The said real estate is not within the urbanized area of a city other than the City to which this Application is directed.

The undersigned applicants do hereby certify that they hold the said real estate by title in fee simple and they have good and lawful authority to make this Application.

Dated on this 10 day of March, 1989.

B. B. & P. Feed and Grain, Inc.

Robert Cogan Sec-Treas

---

APPLICATION FOR VOLUNTARY ANNEXATION

TO: CITY OF WINTERSET, IOWA

The undersigned applicants hereby apply to the City of Winterset, Iowa that the following described real estate be annexed to the City of Winterset, Iowa, to-wit:

All that part of the West 233 feet of the East 783 feet of the Northwest Quarter of the Southeast Quarter of Section 31, T76N, R27W of the 5th P.M., Madison County, Iowa lying North of the Public Highway running East and West through said forty acre tract; and except the North 198 feet of the West 233 feet of the East 783 feet of said Northwest Quarter of the Southeast Quarter.

The applicants attach hereto as a part of this application a map of the said real estate to be annexed showing its location in relationship to the existing limits of the City of Winterset, Iowa.

The said real estate is not within the urbanized area of a city other than the City to which this Application is directed.

The undersigned applicants do hereby certify that they hold the said real estate by title in fee simple and they have good and lawful authority to make this Application.

Dated on this 30th day of Nov., 1989.

B. W. & Kathryn A. Farlow  
Marvin P. & Mary A. Cox

Bill W. Farlow  
Kathryn A. Farlow  
Marvin Cox  
Mary A. Cox

APPLICATION FOR VOLUNTARY ANNEXATION

TO: CITY OF WINTERSET, IOWA

The undersigned applicants hereby apply to the City of Winterset, Iowa that the following described real estate be annexed to the City of Winterset, Iowa, to-wit:

A parcel described as commencing at the Northwest Corner of the Southeast Quarter of Section 31, T76N, R27W of the 5th P.M., Madison County, Iowa; thence South 298 feet along the West line of said Southeast Quarter to the Point of Beginning; thence East 205.0 feet; thence North 100.0 feet; thence East 27.0 feet; thence South 546.25 feet; thence West 232.0 feet; thence North 446.25 feet to the Point of Beginning.

The applicants attach hereto as a part of this application a map of the said real estate to be annexed showing its location in relationship to the existing limits of the City of Winterset, Iowa.

The said real estate is not within the urbanized area of a city other than the City to which this Application is directed.

The undersigned applicants do hereby certify that they hold the said real estate by title in fee simple and they have good and lawful authority to make this Application.

Dated on this 23<sup>rd</sup> day of June, 1989.

Madison County

Phillip Carlson  
Max Newbury  
Ray Korman

APPLICATION FOR VOLUNTARY ANNEXATION

TO: CITY OF WINTERSSET, IOWA

The undersigned applicants hereby apply to the City of Winterset, Iowa that the following described real estate be annexed to the City of Winterset, Iowa, to-wit:

The SE  $\frac{1}{4}$  of the NE  $\frac{1}{4}$  of Section 25, T76N, R28W of the 5th P.M., Madison County, Iowa except a parcel described as commencing at the Northeast Corner of the SE  $\frac{1}{4}$  of the NE  $\frac{1}{4}$  of said Section 25; thence West 500 feet; thence South 500 feet; thence East 500 feet; thence North 500 feet to the Point of Beginning and subject to easements and highway right of way record. The SW  $\frac{1}{4}$  of the NE  $\frac{1}{4}$  of Section 25, T76N, R28W of the 5th P.M., Madison County, Iowa except a parcel described as commencing at a point 24 rods South of the Northwest Corner of the SW  $\frac{1}{4}$  of the NE  $\frac{1}{4}$  of said Section 25, reunning thence East  $9\frac{1}{2}$  rods, thence in a Southwesterly direction following the West side of the Public Highway to a point 48 rods South and 2 rods East of said Northwest Corner, thence West 2 rods, thence North 24 rods to the place of beginning.

The applicants attach hereto as a part of this application a map of the said real estate to be annexed showing its location in relationship to the existing limits of the City of Winterset, Iowa.

The said real estate is not within the urbanized area of a city other than the City to which this Application is directed.

The undersigned applicants do hereby certify that they hold the said real estate by title in fee simple and they have good and lawful authority to make this Application.

Dated on this 19th day of October, 1989.

Gretchen M. Casper  
Gretchen M. Casper

Robert M. Casper  
Robert M. Casper

Peggy Casper  
Peggy Casper  
Margaret Marie Casper

John E. Casper  
John E. Casper

Winnie Casper  
Winnie Casper

Ronald Baker  
Ronald Baker

Dorothy Sue Baker  
Dorothy Sue Baker

APPLICATION FOR VOLUNTARY ANNEXATION

TO: CITY OF WINTERSSET, IOWA

The undersigned applicants hereby apply to the City of Winterset, Iowa that the following described real estate be annexed to the City of Winterset, Iowa, to-wit:

All that part of the Northwest Quarter of the Southeast Quarter of Section 31, T76N, R27W of the 5th P.M., lying North of the public highway running East and West through said forty acre tract and connecting with Court Avenue in Winterset, Iowa, and South of the right of way of the Chicago, Rock Island and Pacific Railway Company (excepting there from a tract 30 feet in width off of the West side thereof and a tract 783 feet in width off of the East side thereof) and except a parcel in the Northwest Corner thereof described as commencing at the Northwest Corner of the Northwest Quarter of the Southeast Quarter of said Section 31; thence South 198 feet to the South line of the right of way of the Chicago, Rock Island & Pacific Railway Company which is the Point of Beginning, thence East 232 feet; thence South 546.25 feet; thence West 232 feet to the West line of said Northwest Quarter of the Southeast Quarter; thence North 546.25 feet to the Point of Beginning, and except a parcel commencing at the northwest corner of the Southeast Quarter of Section 31, Township 76 North, Range 27 West of the Fifth Principal Meridian, Madison County, Iowa; thence on an assumed bearing of North 90 degrees 00 minutes 00 seconds East along the north line of said Southeast Quarter 232.27 feet; thence South 00 degrees 17 minutes 16 seconds East 198.00 feet to the southerly line of the former right of way of the Chicago, Rock Island and Pacific Railroad and the point of beginning; thence continuing South 00 degrees 17 minutes 16 seconds East 858.38 feet to the centerline of the existing Madison County highway; thence North 89 degrees 44 minutes 17 seconds East along the centerline of the existing Madison County highway 281.58 feet; thence North 00 degrees 09 minutes 49 seconds West 857.08 feet to the southerly line of said former railroad right of way; thence North 90 degrees 00 minutes 00 seconds West 283.44 feet along said former right of way line to the point of beginning and containing 5.56 acres more or less, including 0.36 acres of highway right of way over the southerly 55.00 feet thereof and subject to encumbrances of record.

The applicants attach hereto as a part of this application a map of the said real estate to be annexed showing its location in relationship to the existing limits of the City of Winterset, Iowa.

The said real estate is not within the urbanized area of a city other than the City to which this Application is directed.

The undersigned applicants do hereby certify that they hold the said real estate by title in fee simple and they have good and lawful authority to make this Application.

Dated on this 12 day of October, 1989.

Catherine Kilpatrick

Catherine Kilpatrick

Exhibit B

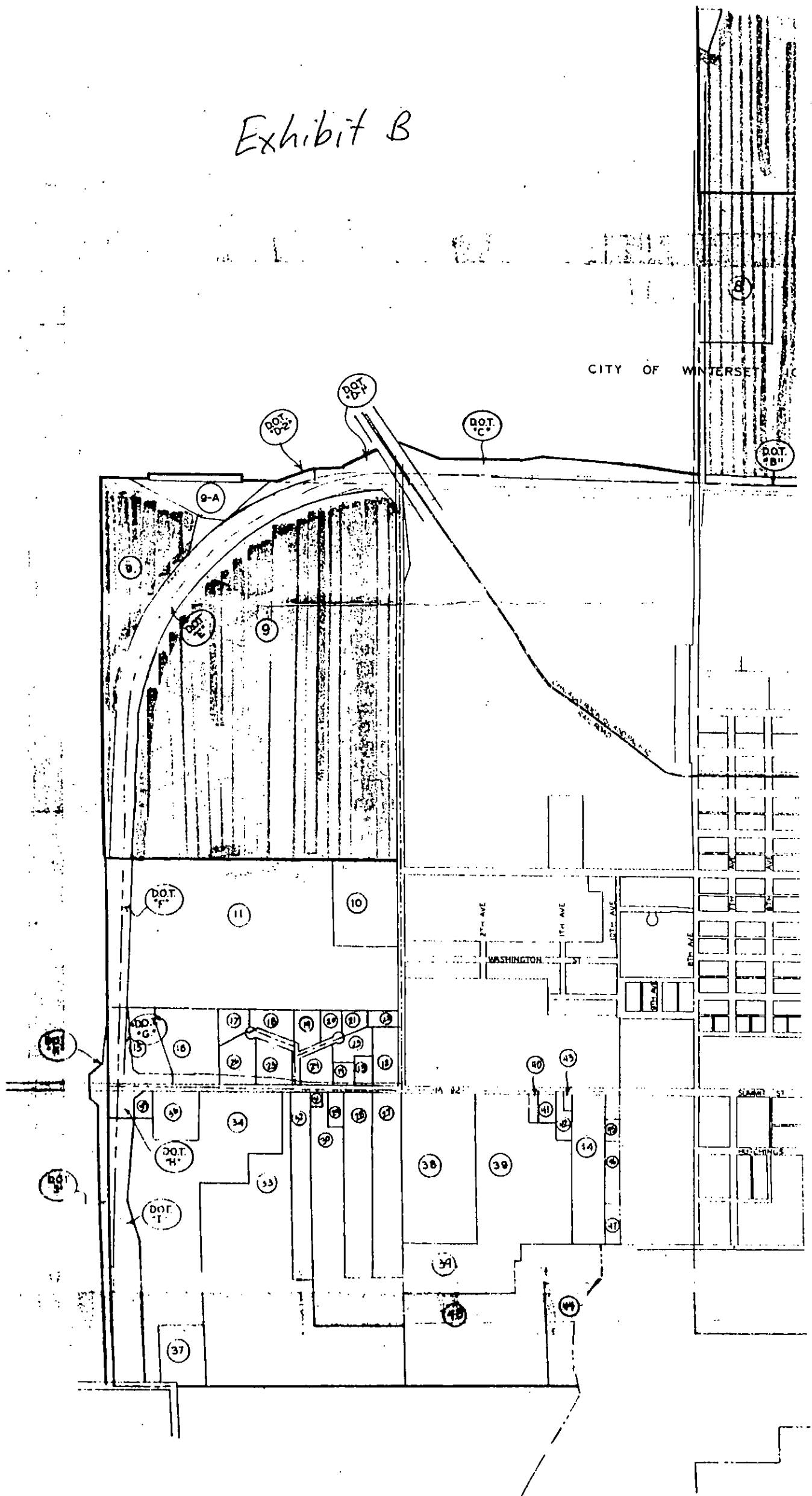

FILED NO. **1346**

BOOK **55** PAGE **531**

89 DEC 28 PM 12: 01

MARY E. WELTY  
RECORDER  
MADISON COUNTY, IOWA

Fee \$115.00

