

PLEASE RETURN TO: MIDWEST POWER 328  
ATTN: RIGHT-OF-WAY SERVICES  
666 GRAND, P.O. BOX 657  
DES MOINES, IA 50303

MIDWEST POWER SYSTEMS INC.  
UNDERGROUND ELECTRIC LINE EASEMENT

Parcel No. 278-93A  
Project No. 00411  
Work Req. No. 9301895  
Sub No. 506238  
Draft No. \_\_\_\_\_

State of Iowa  
County of Madison  
Section \_\_\_\_\_  
Township \_\_\_\_\_ North  
Range \_\_\_\_\_ West of the 5th P.M.

KNOW ALL MEN BY THESE PRESENTS:

For and in consideration of the sum of One and no/100-----Dollar (\$1.00), and other valuable consideration, in hand paid by MIDWEST POWER SYSTEMS INC., an Iowa Corporation, receipt of which is hereby acknowledged, the undersigned Mark and Annette S. Wilden

(Grantors), heirs and assigns, do hereby grant to MIDWEST POWER SYSTEMS INC. (Grantee), its successors or assigns, the right to lay, maintain, operate, repair, and remove underground conduit, wires, and other necessary equipment incident thereto (including associated surface mounted equipment) through and across certain property described below, together with ingress and egress to and from the same, and all the rights and privileges incident and necessary to the enjoyment of this grant.

In consideration of such grant, MIDWEST POWER SYSTEMS INC. agrees that it will repair or pay for any damage which may be caused to crops, fences, or other property of the undersigned by the construction, maintenance, operation, or removal of said line, except such property placed subsequent to the granting of this easement that interferes with the operation and maintenance of the line and associated equipment.

Additionally, MIDWEST POWER SYSTEMS INC. shall have the right to remove from the strip of land specifically described below, any obstructions; including trees, plants, undergrowth, buildings, and structures that interfere with the proper operation and maintenance of said line and equipment.

Grantors agree that they will not construct or place any permanent buildings, structures, trees, plants, or other objects on the property described below.

EASEMENT DESCRIPTION:

An underground electric line easement to consist of a ten foot wide strip of land as shown on the attached Exhibit A and by this reference made a part hereof.

All on and across Lot 1 Lakeview Rural Estate, an Official Plat now included in and forming a part of Madison County, Iowa.

COMPUTER   
RECORDED   
COMPARED   
REC \$ 10.00  
AUD \$ \_\_\_\_\_  
R.M.F. \$ 1.00

FILED NO. 1545  
BOOK 132 PAGE 328  
93 DEC 16 PM 1:37  
MICHELLE UTSLER  
RECORDER  
MADISON COUNTY, IOWA

This easement shall be binding upon the heirs, successors, and assigns of both parties and shall continue until cancelled by mutual consent, or the removal and abandonment of said line. Grantors shall have the right of full enjoyment and use of the above described property except as such that will be inconsistent with this easement.

Dated this 26 day of November, 1993.

Mark A. Wilden  
Mark Wilden  
Annette S. Wilden  
Annette S. Wilden

\_\_\_\_\_  
Social Security Number/Tax I.D. Number  
\_\_\_\_\_  
Social Security Number/Tax I.D. Number

ACKNOWLEDGMENT

STATE OF IOWA  
COUNTY OF Madison ss

On this 26th day of November, 1993, before me, a Notary Public, personally appeared Mark and Annette S. Wilden to me known to be the person(s) who are named in and who executed the foregoing instrument, and acknowledged that they executed the same as their voluntary act and deed.

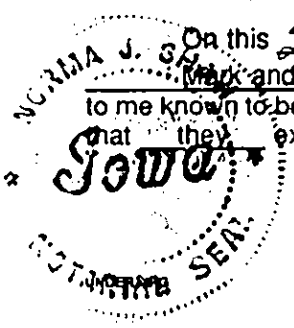

Norma J. Shaw  
Notary Public in and for said County  
Commission Expires 1/29/96

# EXHIBIT A

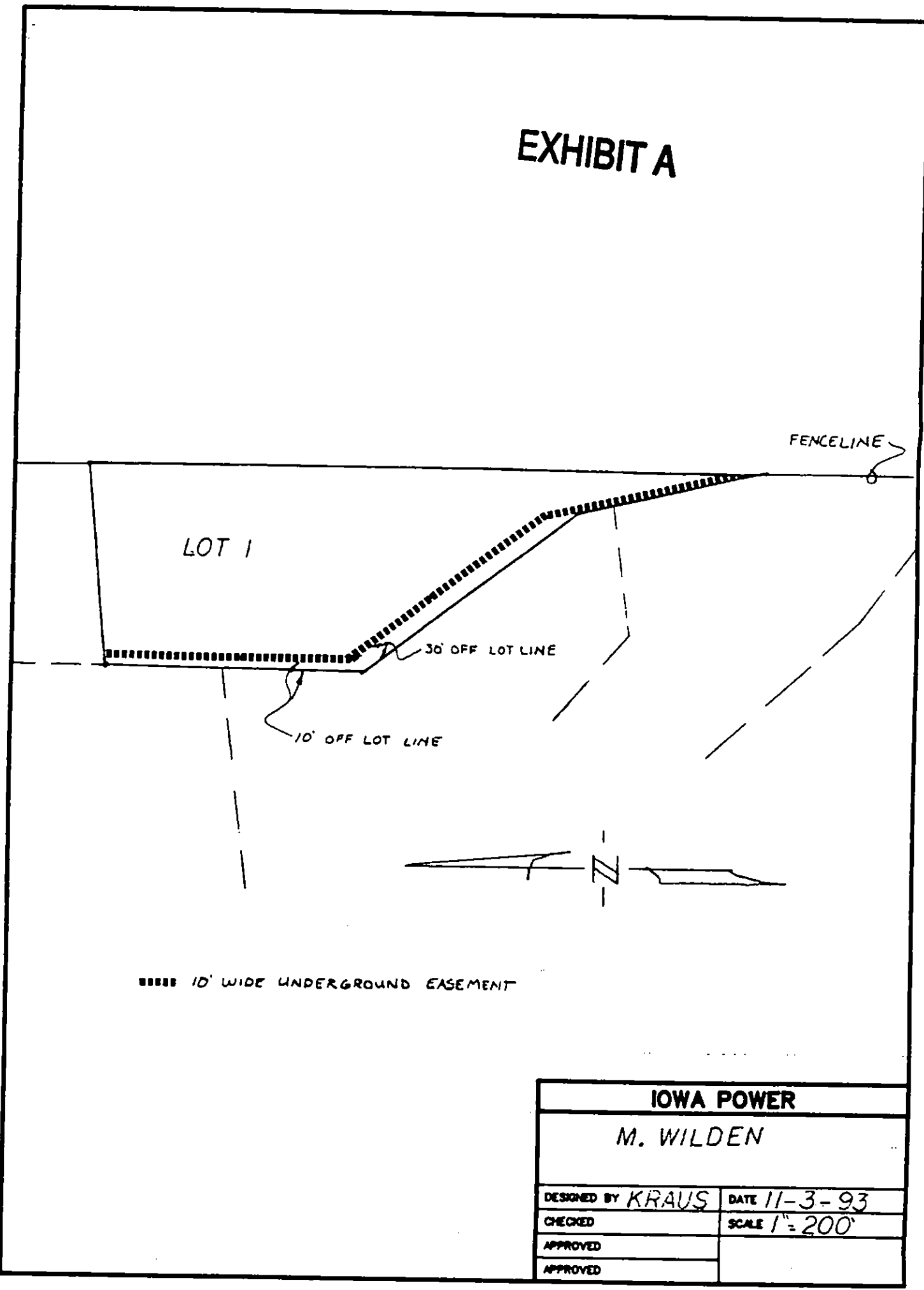

M64435

<b>IOWA POWER</b>	
M. WILDEN	
DESIGNED BY <i>KRAUS</i>	DATE <i>11-3-93</i>
CHECKED	SCALE <i>1" = 200'</i>
APPROVED	
APPROVED	