

REC 10<sup>00</sup>  
PLAT 100

FILED NO. 3227

BOOK 3 PAGE 2

97 MAY 20 AM 9:02

NICHELLE UTSLET  
RECORDER  
MADISON COUNTY, IOWA

MORRISSEY SURVEYING, 1926 PAMMEL PARK ROAD, WINTERSET, IA 50273-8317, 515-462-2166

CORRECTED

CORRECTED



# PLAT OF SURVEY

SW 1/4, SEC. 35, T-77N, R-27W  
MADISON COUNTY, IOWA



NW COR., SW 1/4,  
SEC 35

NE COR., NW 1/4,  
SW 1/4, SEC 35

S89°55'36" E  
664.51

S89°55'36" E  
655.48

Southwesterly  
bank of the  
North Branch  
River

NW 1/4, SW 1/4

Auditor's Parcel  
Letter- B  
29.73 Acres

\*-SECTION CORNER  
OFFSET MONUMENT

N00°18'58"E - 2632.21

N00°20'00"E - 1976.03

615.00  
705.00

S00°20'07"W - 1320.00

SE COR., NW 1/4,  
SW 1/4, SEC 35

APPROXIMATE  
1/4, 1/4,  
SECTION LINE

S00°20'07"W  
655.37

N89°59'03"W  
655.42

SW 1/4, SW 1/4

S00°20'07"W  
662.65

SW COR.,  
SEC 35

N89°40'28"W - 1319.10

SE COR., SW 1/4,  
SW 1/4, SEC 35

### MONUMENTS

- ▲ - found sec cor (pipe, stone, etc)
- - set - 5/8" rebar with cap  
RLS 7995
- - no monument found or set
- - found lot cor (pipe, stone, etc)

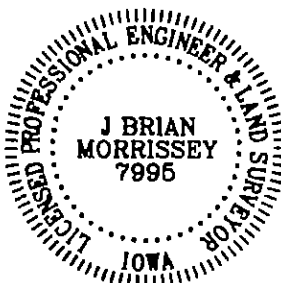

I hereby certify that this plan, specification, plat, map, survey, or report was prepared by me or under my direct personal supervision and that I am a duly Licensed Professional Engineer and Land Surveyor under the laws of the State of Iowa. My license renewal date is 12/31/97

Signed *J. Brian Morrissey* Date 5/19/97  
Brian Morrissey Iowa Lic No 7995

SURVEY FOR PAUL F CAIN, 2391 OSAGE DR, WINTERSET, IA 50273  
OWNER MARVIN COX, 2432 OSAGE DR, WINTERSET, IA 50273

CORRECTED

PLAT OF SURVEY  
SW 1/4, SEC. 35, T-77N, R-27W  
MADISON COUNTY, IOWA

CORRECTED

DESCRIPTION - PARCEL B

That part of the Southwest Quarter of Section 35, Township 77 North, Range 27 West of the Fifth Principal Meridian, Madison County, Iowa, described as follows

Commencing at the northwest corner of the Southwest Quarter of said Section 35, thence on an assumed bearing South 89 degrees 55 minutes 36 seconds East along the north line of the Northwest Quarter of the Southwest Quarter of said Section 35 a distance of 664 51 feet to the point of beginning, thence South 89 degrees 55 minutes 36 seconds East along said north line 655 48 feet to the northeast corner of the Northwest Quarter of the Southwest Quarter of said Section 35; thence South 00 degrees 20 minutes 07 seconds West along the east line of the Northwest Quarter of the Southwest Quarter a distance of 1320 00 feet to the southeast corner of the Northwest Quarter of the Southwest Quarter of said Section 35, thence South 00 degrees 20 minutes 07 seconds West along the east line of the Southwest Quarter of the Southwest Quarter of said Section 35 a distance of 655 37 feet, thence North 89 degrees 59 minutes 03 seconds West 655 42 feet, thence North 00 degrees 20 minutes 00 seconds East 1976 03 feet to the north line of the Northwest Quarter of the Southwest Quarter of said Section 35 and the point of beginning

Said tract contains 29 73 acres

AREA BY 1/4, 1/4 SECTION

NW 1/4, SW 1/4 = 19 85 ACRES  
SW 1/4, SW 1/4 = 9 88 ACRES

NOTE This Plat of Survey corrects the Township number on the Plat of Survey recorded in Farm Plat Book 2, Pages 799 and 800

MONUMENTS

- ▲ - found sec cor (pipe, stone, etc)
- - set - 5/8" rebar with cap  
RLS 7995
- - no monument found or set
- - found lot cor (pipe, stone, etc)

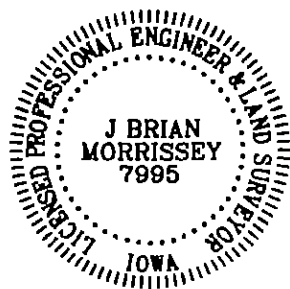

I hereby certify that this plan, specification, plat, map, survey, or report was prepared by me or under my direct personal supervision and that I am a duly Licensed Professional Engineer and Land Surveyor under the laws of the State of Iowa. My license renewal date is 12/31/97

Signed J. B. Morrissey Date 5/19/97  
J Brian Morrissey Iowa Lic No 7995

SURVEY FOR PAUL F CAIN, 2391 OSAGE DR, WINTERSET, IA 50273  
OWNER MARVIN COX, 2432 OSAGE DR, WINTERSET, IA 50273