

PLEASE RETURN TO: MIDWEST POWER  
ATTN: RIGHT-OF-WAY SERVICES  
P.O. BOX 657, 907 WALNUT  
DES MOINES, IA 50303

DEED RECORD 134

FILED NO. 3316

420

BOOK 134 PAGE 420

95 JUN 30 PM 3: 09

MIDWEST POWER SYSTEMS INC.  
UNDERGROUND ELECTRIC LINE EASEMENT

Parcel No. 115-95  
Work Req. No. 9505554  
Project No. 00401  
Sub No. 312144  
Draft No. \_\_\_\_\_

REC \$10.00  
AUD \$ \_\_\_\_\_  
COMPUTER   
RECORDED   
COMPARED \_\_\_\_\_  
R.M.F. \$ 1.00

MICHELLE UTBILLE  
RECORDER  
State of Iowa  
County of Madison MADISON COUNTY, IOWA  
Section 31  
Township 77 North  
Range 27 West of the 5th P.M.

KNOW ALL MEN BY THESE PRESENTS:

For and in consideration of the sum of One and no/100-----Dollar (\$1.00), and other valuable consideration, in hand paid by MIDWEST POWER SYSTEMS INC., an Iowa Corporation, receipt of which is hereby acknowledged, the undersigned Robert B. Crase & Kimberly R. Crase

(Grantors), heirs and assigns, do hereby grant to MIDWEST POWER SYSTEMS INC. (Grantee), its successors or assigns, the right to lay, maintain, operate, repair, and remove underground conduit, wires, and other necessary equipment incident thereto (including associated surface mounted equipment) through and across certain property described below, together with ingress and egress to and from the same, and all the rights and privileges incident and necessary to the enjoyment of this grant.

In consideration of such grant, MIDWEST POWER SYSTEMS INC. agrees that it will repair or pay for any damage which may be caused to crops, fences, or other property of the undersigned by the construction, maintenance, operation, or removal of said line, except such property placed subsequent to the granting of this easement that interferes with the operation and maintenance of the line and associated equipment.

Additionally, MIDWEST POWER SYSTEMS INC. shall have the right to remove from the strip of land specifically described below, any obstructions; including trees, plants, undergrowth, buildings, and structures that interfere with the proper operation and maintenance of said line and equipment.

Grantors agree that they will not construct or place any permanent buildings, structures, trees, plants, or other objects on the property described below.

EASEMENT DESCRIPTION:

An underground electric line easement to consist of a ten (10) foot wide strip of land the centerline of which is described as follows: Beginning at a point approximately 526 feet south of and 526 feet east of the northwest corner of Section 31, Township 77 North, Range 27 West of the 5th P.M., Madison County Iowa on the west right of way line of U.S. Highway 169 as it is presently established; thence in a Northwesterly direction a distance of approximately 400 feet to pad mounted transformer.

All on and across that portion of the West 49.33 acres of the West Fractional Half of the Northwest Quarter (W Fr 1/2 NW 1/4) of said Section 31 as shown on the attached Exhibit A and by this reference made a part hereof.

This easement shall be binding upon the heirs, successors, and assigns of both parties and shall continue until cancelled by mutual consent, or the removal and abandonment of said line. Grantors shall have the right of full enjoyment and use of the above described property except as such that will be inconsistent with this easement.

Dated this 27 day of June, 1995

Robert B. Crase  
Robert B. Crase  
Kimberly R. Crase  
Kimberly R. Crase

\_\_\_\_\_  
Social Security Number/Tax I.D. Number  
\_\_\_\_\_  
Social Security Number/Tax I.D. Number

ACKNOWLEDGMENT

STATE OF IOWA )  
COUNTY OF Dallas ) ss

On this 27 day of June, 1995, before me, a Notary Public, personally appeared Robert B. Crase & Kimberly R. Crase

to me known to be the person(s) who are named in and who executed the foregoing instrument, and acknowledged that they executed the same as a voluntary act and deed.

Jacquelyn K. Marquardt  
Notary Public in and for said County



# EXHIBIT A

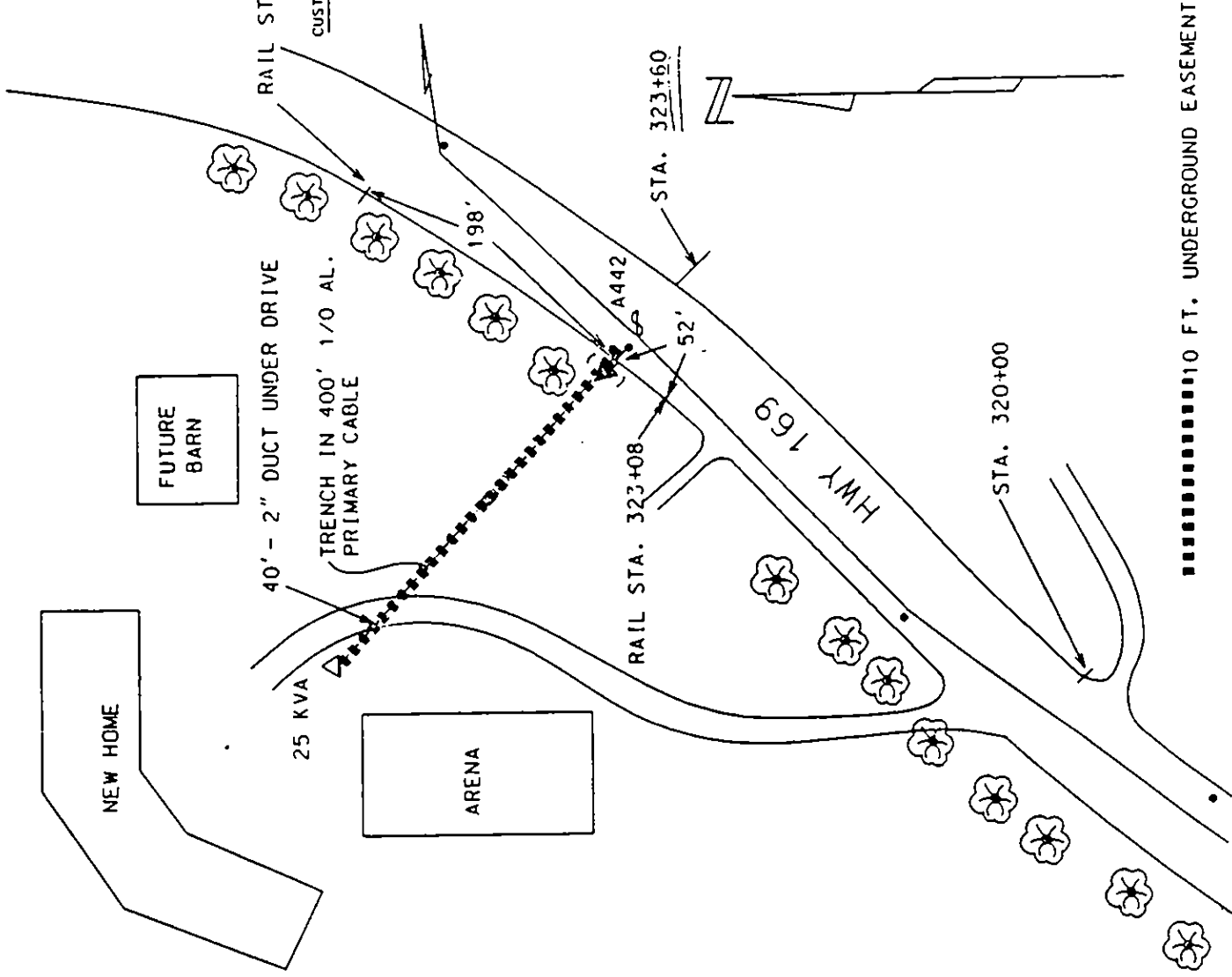

CUSTOMER SHALL PROVIDE THE FOLLOWING :

- ( X ) EASEMENTS
- ( X ) FINAL GRADE
- ( ) SERVICE CABLES ON APARTMENTS BUILDINGS OR OTHER COMMERCIAL TYPE BUILDINGS
- ( X ) UNOBSTRUCTED CABLE ROUTE
- ( ) DUCT AND PULL WIRES WITH STAKED ENDS AS SHOWN ON THE PRINT
- ALL DUCT IS TO BE PVC-TYPE DB-120 (HEAVY WALL) PER NEMA TC-8 AND ASTM512.
- ALL BENDS ARE TO BE FIBERGLASS-STANDARD WALL PER NEMA TC-14A, WITH FACTORY ASSEMBLED PLASTIC COUPLINGS ON EACH END TO MATE WITH DB-120 DUCT
- ( X ) LEVEL AREA FOR TRANSFORMERS
- ( X ) ADDRESSES
- ( ) TRANSFORMER PADS
- ( X ) TREE TRIMMING OR REMOVAL
- ( ) TRANSFORMER FIRE BARRIER WALLS IF REQD. BY THE GOVERNING AUTHORITIES
- ( X ) STAKED LOT CORNERS

PROJ. #00401  
 SUB #312144  
 W.O. #95

<b>MIDWEST POWER</b>	
ROBERT CRASE	
77-27-31-99 MCO	
DRAWN BY: M. KRAUS	DATE: 5-17-95
ECR NUMBER:	SCALE: N.T.S.
MAP PAGE: SW 84	

# EXHIBIT A