

LISA SMITH, COUNTY RECORDER
MADISON IOWA

UNITED STATES PUBLIC LAND SURVEY CORNER CERTIFICATE

LAND SURVEY MONUMENTS SITUATED IN SECTION 18 of 76, TOWNSHIP 27, RANGE Madison County, Iowa.

Monument Description & Remarks: No ties were available from the County Recorder's Office or County Engineer's Office.
Calculated corner location relative to monuments found for East 1/4 corner of said Section 18 and East 1/4 corner of Section
19-76-27: found IDOT Aluminum Disc #6263 - tied out monument.

PLAN VIEW

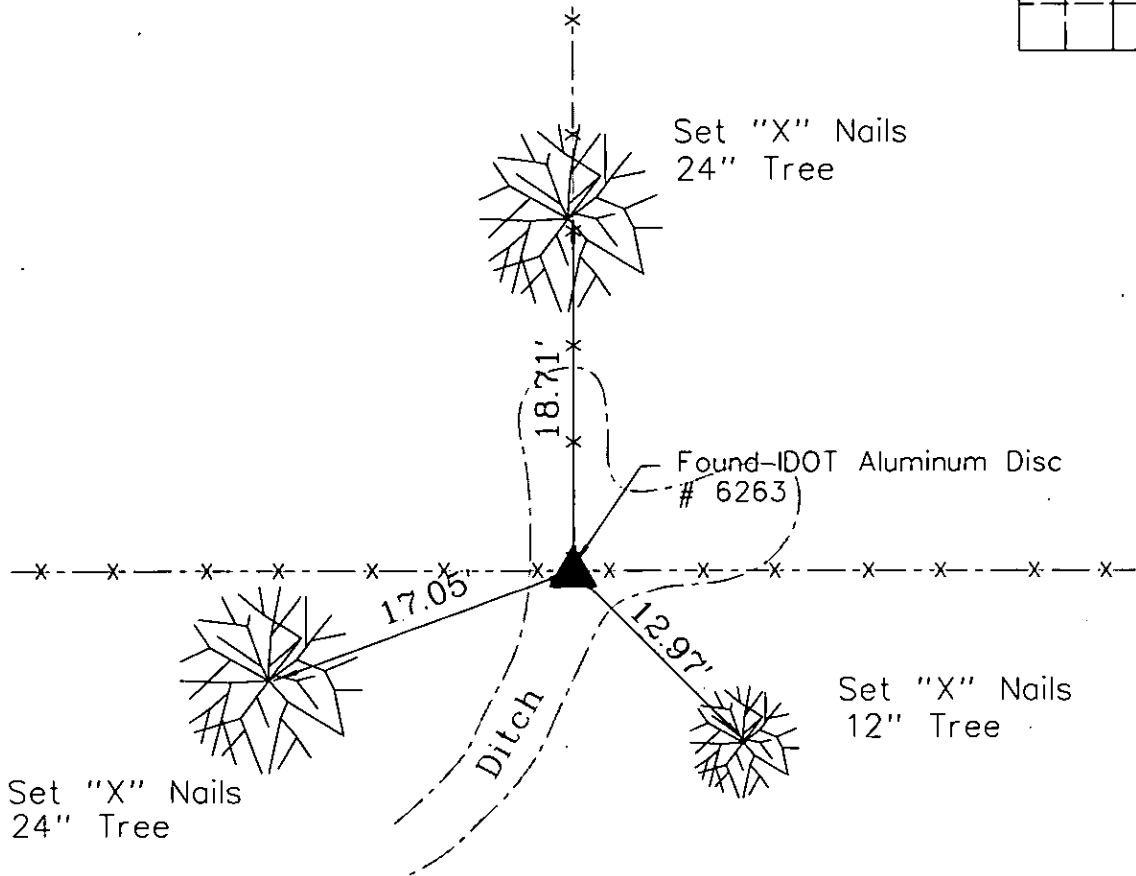
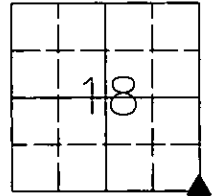

South East Corner 18-76-27

Found IDOT Aluminum Disc with number #6263

I HEREBY CERTIFY THAT THIS SURVEYING DOCUMENT WAS PREPARED AND THE RELATED WORK WAS PERFORMED BY ME OR UNDER MY DIRECT PERSONAL SUPERVISION, AND THAT I AM A DULY LICENSED PROFESSIONAL LAND SURVEYOR UNDER THE LAWS OF THE STATE OF IOWA.

Mark A. McMurphy 2-9-07
MARK A. MCMURPHY, IOWA LIC. NO 14674 DATE

MY LICENSE RENEWAL DATE IS DECEMBER 31, 2008.

ADDITIONAL PAGES CERTIFIED (NONE UNLESS INDICATED HERE)

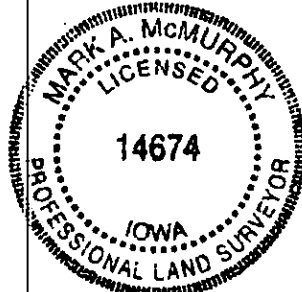

Corners to be Indexed:

Corner	Section	Twp	Range
SE Corner	18	76	27