

INDX ✓
ANNO
SCAN
CHEK

LISA SMITH, COUNTY RECORDER
MADISON IOWA

UNITED STATES PUBLIC LAND SURVEY CORNER CERTIFICATE

LAND SURVEY MONUMENTS SITUATED IN SECTION 18 of 76, TOWNSHIP 76, RANGE 27, of the Fifth Principal Meridian, Madison County, Iowa.

Monument Description & Remarks: No ties were available from the County Recorder's Office or County Engineer's Office. County Road Plans had reference to the point. County reference ties were obliterated, found PK Nail in cl road, and monument lined up with cl road to the North and fenceline to the South - retied monument.

PLAN VIEW

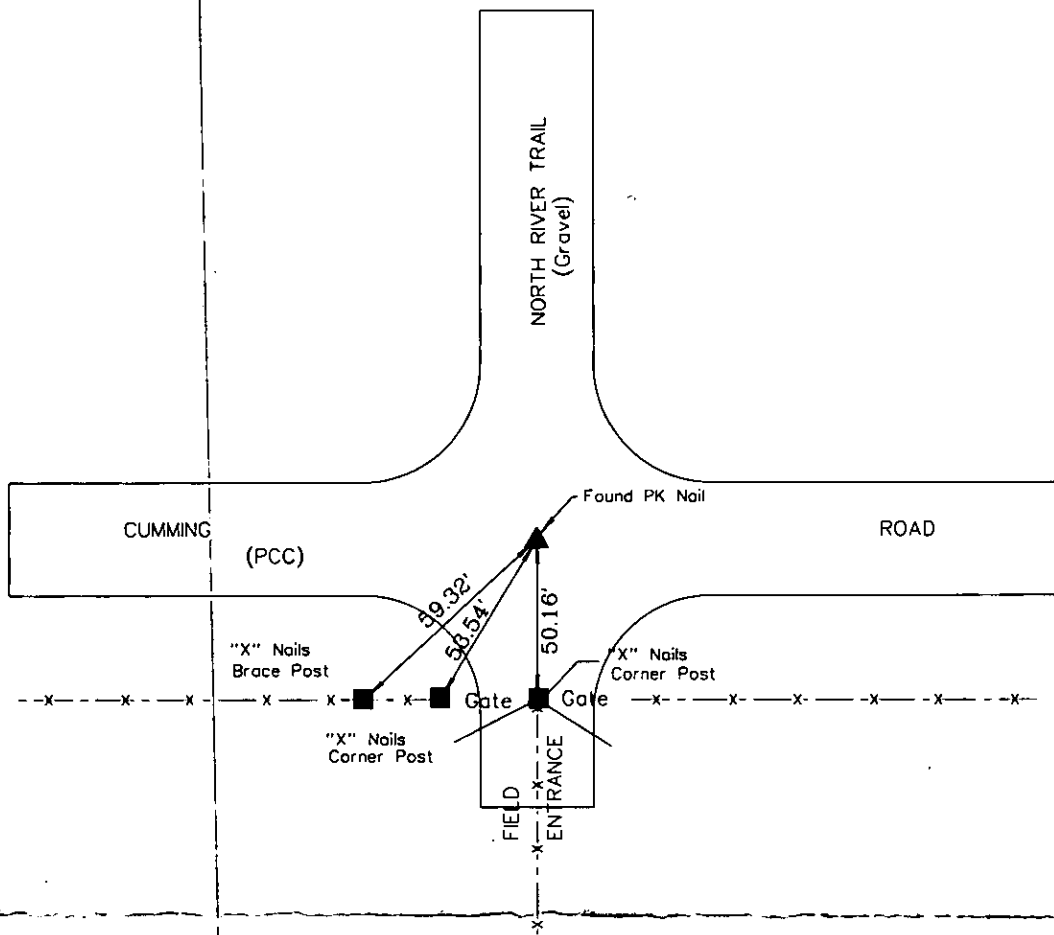
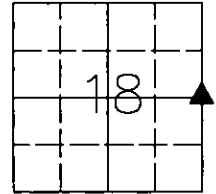

East 1/4 Corner 18-76-27

Found PK Nail in Asphalt

I HEREBY CERTIFY THAT THIS SURVEYING DOCUMENT WAS PREPARED AND THE RELATED WORK WAS PERFORMED BY ME OR UNDER MY DIRECT PERSONAL SUPERVISION, AND THAT I AM A DULY LICENSED PROFESSIONAL LAND SURVEYOR UNDER THE LAWS OF THE STATE OF IOWA.

Mark A. McMurphy 2-9-07
MARK A. MCMURPHY, IOWA LIC. NO 14674 DATE

MY LICENSE RENEWAL DATE IS DECEMBER 31, 2008.

ADDITIONAL PAGES CERTIFIED (NONE UNLESS INDICATED HERE)

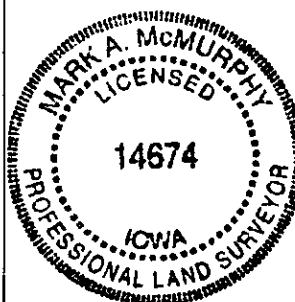

Corners to be Indexed:
Corner Section Twp Range
East 1/4 Corner 18 76 27