

COMPUTER	<input checked="" type="checkbox"/>
RECORDED	<input checked="" type="checkbox"/>
COMPARED	<input type="checkbox"/>

MICHELLE UTSLER, COUNTY RECORDER
MADISON IOWA

HACKETT SURVEYING, Prepared By: Michael James Hackett, 712 North 9th. Ave., Winterset, Ia. 50273, Tel. (515) 462-1106

UNITED STATES PUBLIC LAND SURVEY CORNER CERTIFICATE OF

Land Survey Monuments situated in Section 35, Township 77 N, Range 28 W, of the Fifth Principal Meridian, Madison County, Iowa.
Previously recorded in BOOK 1, PAGE 147 in County Recorder's Office.
(book, page, document number, etc.)

(Show reason for preparing this certificate, the evidence and detailed procedures used in establishing the corner positions and monumentation found or placed.)

Monument Description and Remarks: Found capped iron pin with yellow plastic cap, cap not readable, 1" deep, in gravel road. Traversed the west side of the Northwest Quarter to confirm location. Accepted position. The reason for preparing this certificate is that the previous tie distances have changed.

PLAN VIEW

(Show a minimum of three reference ties to durable physical objects, relevant monuments and physical conditions that will enable recovery of the corner.)

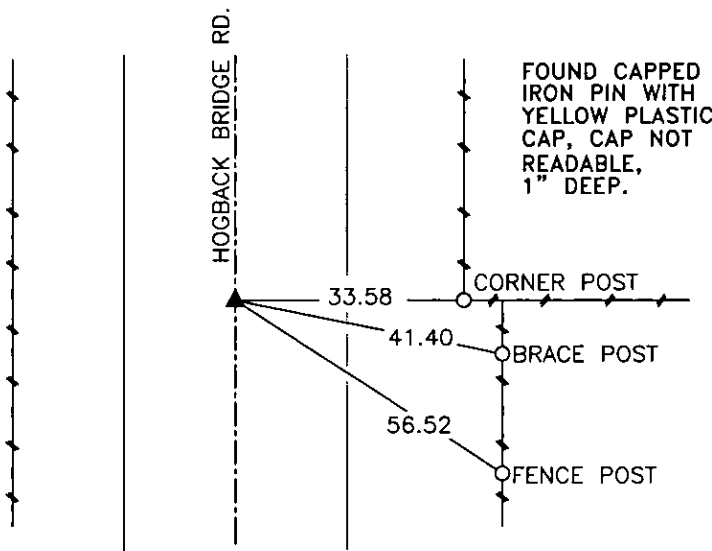
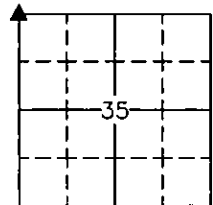

NW. COR., NW. 1/4, NW. 1/4, SEC. 35

NOTE: ALL TIES TO "X" NAILS UNLESS NOTED

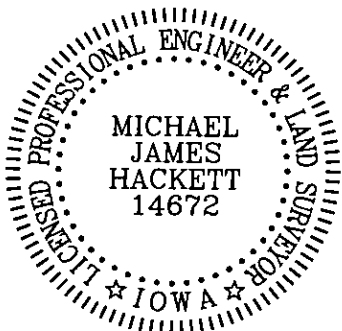

I hereby certify that this land surveying document was prepared and the related survey work was performed by me or under my direct personal supervision and that I am a duly Licensed Land Surveyor under the laws of the State of Iowa.

Signed Michael James Hackett Date 3/16/06
Michael James Hackett

Iowa license number 14672.
My license renewal date is 12/31/2006.
Pages covered by this seal: 1.