

UNITED STATES PUBLIC LAND SURVEY CORNER CERTIFICATE  
OF

COMPUTER   
RECORDED   
COMPARED

Land Survey Monuments situated in Section 5, Township 77, Range 26, of the Fifth Principal Meridian, Madison County, Iowa.  
Previously recorded in \_\_\_\_\_ in County Recorder's Office.  
(book, page, document number, etc.)

(Show reason for preparing this certificate, the evidence and detailed procedures used in establishing the corner positions and monumentation found or placed.)

Monument Description and Remarks: SET 1/2" REBAR W/ CAP # 7056 3" DEEP

PLAN - VIEW

(Show a minimum of three reference ties to durable physical objects, relevant monuments and physical conditions that will enable recovery of the corner.)

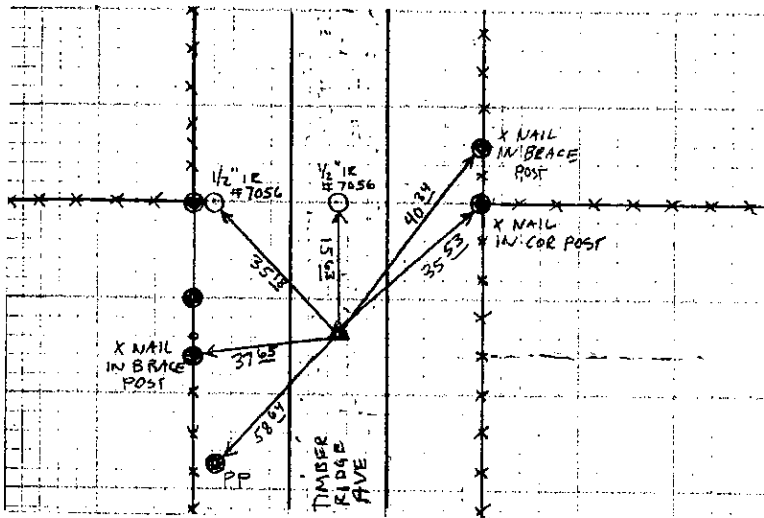
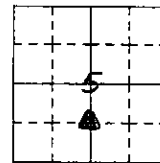

I hereby certify that the survey work was completed and this land surveying document was prepared by me or under my direct personal supervision and that I am a duly registered land surveyor under the laws of the state of Iowa.

Signature Larry Richards  
Name typed or printed: Larry J. Richards

Date: 3/07/06 Reg. No. 7056

My registration renewal date is December 31, 2008

List Corners to be Indexed			
Corners	Section	Twp	Range
SE COR NE 1/4 SW 1/4	5	77	26

SEAL

