

COMPUTER	<input checked="" type="checkbox"/>
RECORDED	<input checked="" type="checkbox"/>
COMPARED	<input type="checkbox"/>

MICHELLE UTSLER, COUNTY RECORDER
MADISON IOWA

PREPARED BY: LARRY J. RICHARDS, ENGINEERING DESIGN SERVICES, 14225 UNIVERSITY AVENUE--SUITE 220, WAUKEE, IOWA 50263

UNITED STATES PUBLIC LAND SURVEY CORNER CERTIFICATE
OF

Land Survey Monuments situated in Section 5, Township 77N, Range 26W, of the Fifth Principal Meridian, Madison County, Iowa.
Previously recorded in _____ in County Recorder's Office.

(book, page, document number, etc.)

(Show reason for preparing this certificate, the evidence and detailed procedures used in establishing the corner positions and monumentation found or placed.)

Monument Description and Remarks: SET 1/2" IRON REBAR WITH CAP #7056

PLAN - VIEW

(Show a minimum of three reference ties to durable physical objects, relevant monuments and physical conditions that will enable recovery of the corner.)

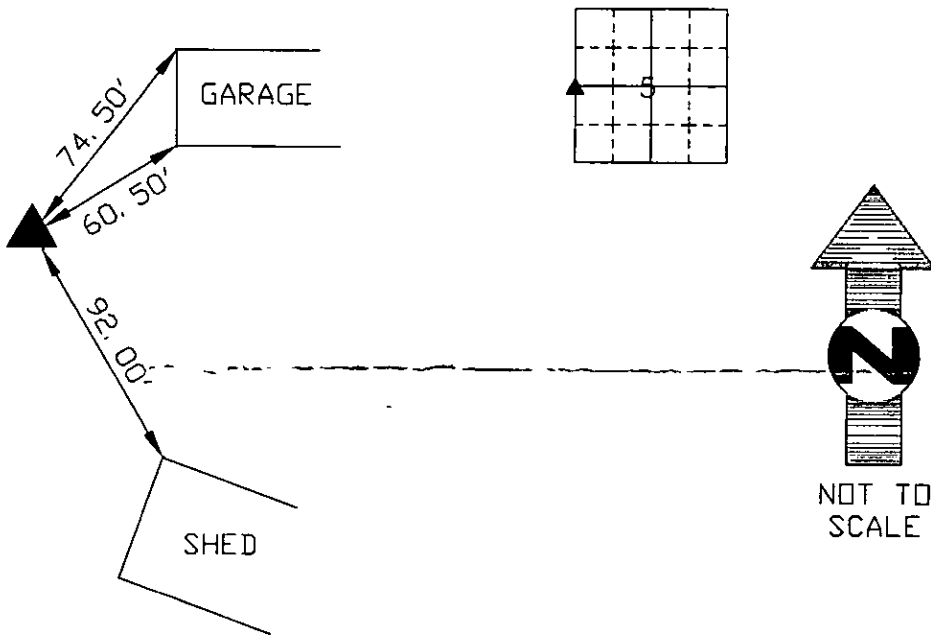

I hereby certify that the survey work was completed and this land surveying document was prepared by me or under my direct personal supervision and that I am a duly registered land surveyor under the laws of the state of Iowa

Signature Larry Richards
Name typed or printed: Larry J. Richards

Date: 03/07/06 Reg. No. 7056

My registration renewal date is December 31, 2006

List Corners to be Indexed			
Corners	Section	Twp	Range
W 1/4	5	T77N	R26W

SEAL

