

COMPUTER
RECORDED
COMPARED

MICHELLE UTSLER, COUNTY RECORDER
MADISON IOWA

HACKETT SURVEYING, Prepared By: Michael James Hackett, 712 North 9th. Ave., Winterset, Ia. 50273, Tel. (515) 462-1106

UNITED STATES PUBLIC LAND SURVEY CORNER CERTIFICATE OF

Land Survey Monuments situated in Section 14, Township 75 N, Range 26 W, of the Fifth Principal Meridian, Madison County, Iowa.
Previously recorded in _____ in County Recorder's Office.
(book, page, document number, etc.)

(Show reason for preparing this certificate, the evidence and detailed procedures used in establishing the corner positions and monumentation found or placed.)

Monument Description and Remarks: Set 5/8" x 18" rebar with red plastic cap, PLS #14672. The position of the corner based on a intersection of a North - South line between the found northwest corner of the Northeast Quarter and the southeast corner of the Northeast Quarter of the Southwest Quarter and the East - West line from the southeast corner of the Northeast Quarter to a 1/2" rebar as set on line as recorded in Farm Plat Book 1, Page 192, Madison County Recorders Office.

PLAN VIEW

(Show a minimum of three reference ties to durable physical objects, relevant monuments and physical conditions that will enable recovery of the corner.)

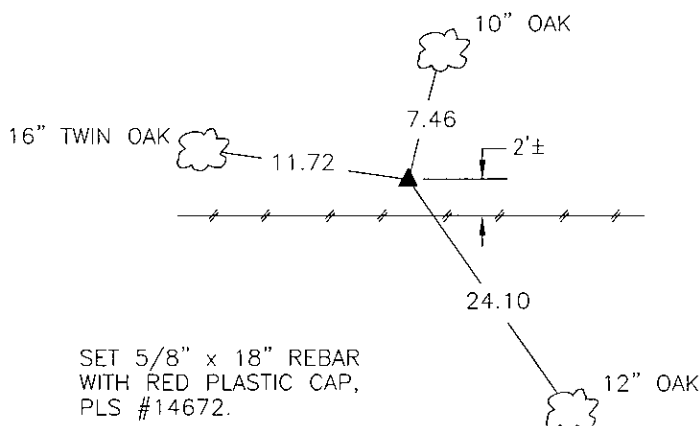
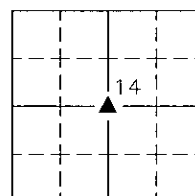

SET 5/8" x 18" REBAR
WITH RED PLASTIC CAP,
PLS #14672.

NE. COR., NE. 1/4, SW. 1/4, SEC. 14

NOTE: ALL TIES TO "X" NAILS UNLESS NOTED

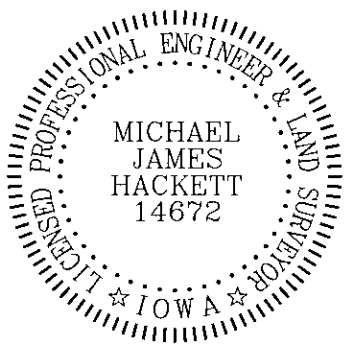

I hereby certify that this land surveying document was prepared and the related survey work was performed by me or under my direct personal supervision and that I am a duly Licensed Land Surveyor under the laws of the State of Iowa.

Signed Michael James Hackett Date 1-11-06
Michael James Hackett

Iowa license number 14672.
My license renewal date is 12/31/2006.
Pages covered by this seal: 1.