

MICHELLE "MICKI" UTSLER, COUNTY RECORDER  
MADISON IOWA

VANCE & HOCHSTETLER, P.C. CONSULTING ENGINEERS, WINTERSSET, IOWA (515)462-3995

04-2095 CHARLES T. VANCE, 110 WEST GREEN ST., WINTERSSET, IOWA 50273  
JAMES M. HOCHSTETLER, 110 WEST GREEN ST., WINTERSSET, IOWA 50273

COMPUTER	<input checked="" type="checkbox"/>
RECORDED	<input checked="" type="checkbox"/>
COMPARED	<input type="checkbox"/>

UNITED STATES PUBLIC LAND SURVEY CORNER CERTIFICATE

OF

Land Survey Monuments situated in Section 4, Township T76 North, Range R28 West, of the Fifth Principal Meridian, Madison County, Iowa.  
Previously recorded in N/A in County Recorder's Office.

(book, page, document number, etc.)  
(Show reason for preparing this certificate, the evidence and detailed procedures used in establishing the corner positions and monumentation found or placed.)

Monument Description and Remarks: Set C.I.R.#5041 at SW.Cor. NW 1/4 NE 1/4 Sec. 4 at projected fence intersection. Set C.I.R.#5041 at SE.Cor. NW 1/4 NE 1/4 Sec. 4 at distance split between section line and quarter section line. Set C.I.R.#5041 at SE.Cor. NE 1/4 NE 1/4 Sec. 4 on the section line and the intersection with the Quarter Quarter Sec. line from the West.

PLAN - VIEW

(Show a minimum of three reference ties to durable physical objects, relevant monuments and physical conditions that will enable recovery of the corner.)

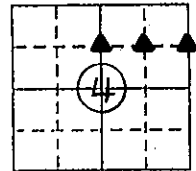
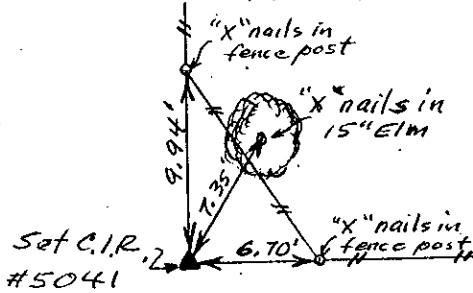

Ref. to SW.COR. NW 1/4 NE 1/4 Sec. 4, T76N, R28W

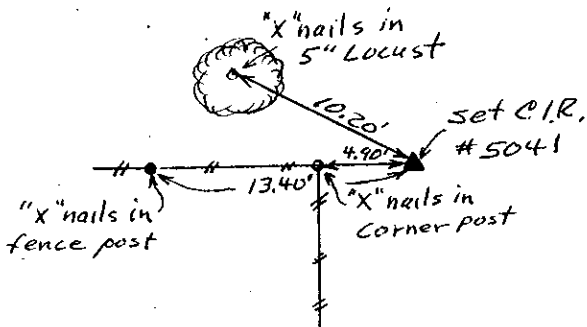

Ref. to SE.COR. NW 1/4 NE 1/4  
Sec. 4, T76N, R28W.

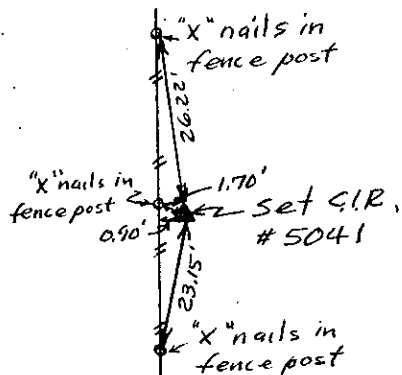

Ref. to SE.COR. NE 1/4 NE 1/4  
Sec. 4, T76N, R28W

I hereby certify that the survey work was completed and this land surveying document was prepared by me or under my direct personal supervision and that I am a duly registered land surveyor under the laws of the state of Iowa

Signature: Charles T. Vance

Name typed or printed: Charles T. Vance, PE & LS

Date: 17 March 2005 Reg. No. 5041

My registration renewal date is December 31, 2005

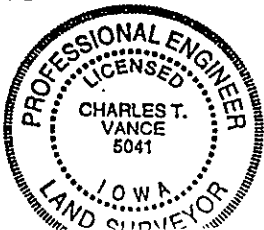

Corners	Section	Twp	Range
SW COR.	4	T76N	R28W
NW 1/4 NE 1/4			
SE COR.	4	T76N	R28W
NW 1/4 NE 1/4			
SE COR.	4	T76N	R28W
NE 1/4 NE 1/4			