

REC \$ No
AUD \$ Fee
R.M.F. \$

COMPUTER	<input checked="" type="checkbox"/>
RECORDED	<input checked="" type="checkbox"/>
COMPARED	<input type="checkbox"/>

NICKI UTSLER
RECORDER
MADISON COUNTY IOWA

Prepared By: Michael James Hackett, Madison County Engineer's Office, Courthouse, P.O. Box 152, Winterset, Ia. 50273, Tel. (515) 462-1156

UNITED STATES PUBLIC LAND SURVEY CORNER CERTIFICATE OF

Land Survey Monuments situated in Section 23, Township 76 N, Range 27 W, of the Fifth Principal Meridian, Madison County, Iowa. Previously recorded in Book 1, Page 490 in County Recorder's Office. (book, page, document number, etc.)

(Show reason for preparing this certificate, the evidence and detailed procedures used in establishing the corner positions and monumentation found or placed.)

Monument Description and Remarks: Found 5/8" rebar, with orange plastic cap, cap not readable, 5" deep.
The reason for preparing this certificate is that the description of the monument previously recorded was different than what was found (the number on the cap was not readable). Ties from previously recorded certificate checked O.K.. Traversed between sections 26/27 and 22/23, and distances between recorded established section corners to the North and South check with reasonable distances. Accepted position.

PLAN VIEW

(Show a minimum of three reference ties to durable physical objects, relevant monuments and physical conditions that will enable recovery of the corner.)

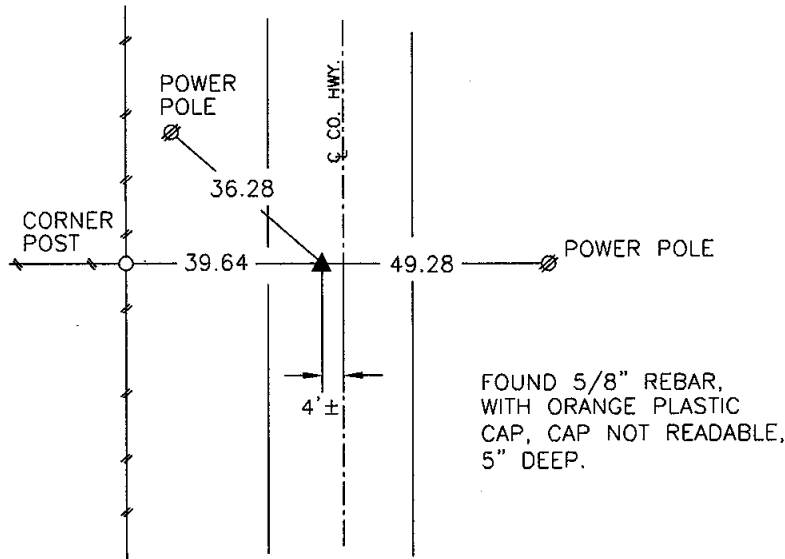
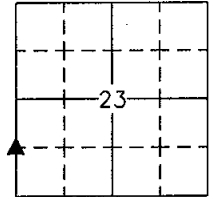

NW. COR., SW. 1/4, SW. 1/4, SEC. 23

NOTE: ALL TIES TO "X" NAILS UNLESS NOTED

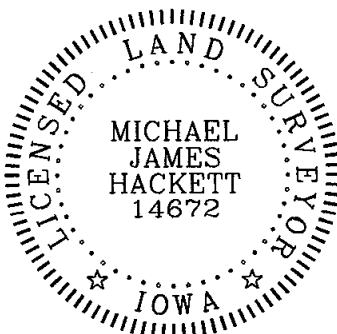

I hereby certify that this land surveying document was prepared and the related survey work was performed by me or under my direct personal supervision and that I am a duly Licensed Land Surveyor under the laws of the State of Iowa.

Signed Michael James Hackett Date 3-6-02
Michael James Hackett Iowa Lic. No. 14672

My license renewal date is 12/31/2002.
Pages covered by this seal: 1.