

MICKI UTSLER  
 RECORDER  
 MADISON COUNTY, IOWA

REC \$ 5<sup>81</sup>  
 AUD \$ \_\_\_\_\_  
 R.M.F. \$ \_\_\_\_\_

COMPUTER	<input checked="" type="checkbox"/>
RECORDED	<input checked="" type="checkbox"/>
COMPARED	<input type="checkbox"/>

VANCE & HOCHSTETLER, P.C. CONSULTING ENGINEERS, WINTERSSET, IOWA (515) 462-3995  
 CHARLES T. VANCE, 110 WEST GREEN ST., WINTERSSET, IOWA 50273  
 JAMES M HOCHSTETLER, 110 WEST GREEN ST., WINTERSSET, IOWA 50273

AN AMENDED PLAT OF SURVEY FOR RUSS UTSLER LOCATED IN THE  
 NORTHEAST FRACTIONAL QUARTER OF THE NORTHEAST QUARTER OF  
 SECTION 1, TOWNSHIP 74 NORTH, RANGE 28 WEST OF THE 5th P.M.,  
 MADISON COUNTY, IOWA. THIS PLAT REPLACES THE PLAT FILED ON  
 JANUARY 6, 1995 IN BOOK 2 PAGE 532 AT THE MADISON COUNTY  
 RECORDER'S OFFICE.

NOTE: This plat was  
 amended to match  
 existing fencelines.

LEGAL DESCRIPTION:  
 Parcel "A", located in the Northeast Fractional  
 Quarter of the Northeast Quarter of Section 1,  
 Township 74 North, Range 28 West of the 5th P.M.,  
 Madison County, Iowa, more particularly described  
 as follows:  
 Beginning at the Northeast corner of Section 1,  
 Township 74 North, Range 28 West of the 5th P.M.,  
 Madison County, Iowa; thence South 0°37'43" West,  
 332.21 feet along the East line of the Northeast  
 Quarter of said Section 1; thence South 89°28'47"  
 West, 338.54 feet along an existing fenceline;  
 thence South 46°23'20" West, 24.54 feet along said  
 fenceline; thence South 88°46'39" West, 253.85  
 feet along said fenceline; thence North 0°05'19"  
 East, 358.87 feet to a point on the North line of  
 the Northeast Quarter of said Section 1; thence  
 South 89°52'55" East, 613.19 feet along the North  
 line of the Northeast Quarter of said Section 1  
 to the Point of Beginning. Said Parcel contains  
 4.822 acres, including 0.909 acres of County  
 road right-of-way.

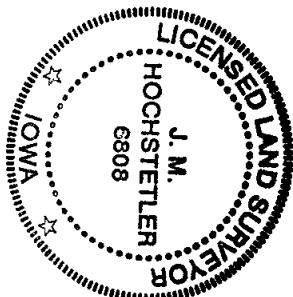

I hereby certify that this land surveying document  
 was prepared and the related survey work was  
 performed by me or under my direct personal  
 supervision and that I am a duly licensed Land  
 Surveyor under the laws of the State of Iowa.

*J.M. Hochstetler*  
 J.M. HOCHSTETLER  
 License number 6808 Date 2/21/03  
 My license renewal date is December 31, 2003  
 Pages or sheets covered by this seal: 1

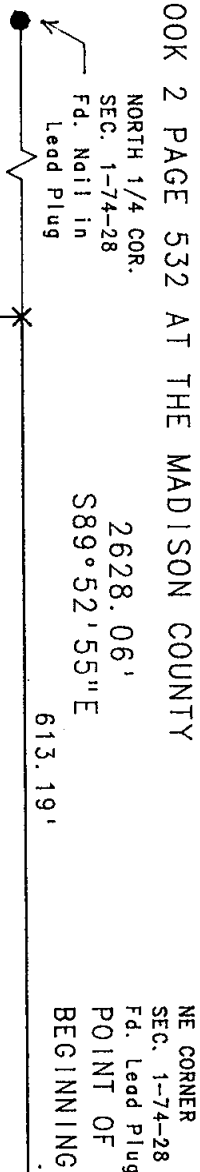

Gross = 4.822 ac.  
 R.O.W. = 0.909 ac.  
 Net = 3.913 ac.

- LEGEND
- Fd. Lead Plug
  - Fd. 5/8" Iron Rod
  - Set Capped Iron Rod (C.I.R.) #6808
  - Existing Fenceline
  - - - Road R.O.W. line
  - x No Monument set or found

DATE OF SURVEY:  
 February 7, 2003

SCALE: 1" = 100'

