

REC \$ 5.00
AUD \$ _____
R.M.F. \$ 1.00

COMPUTER
RECORDED
COMPARED _____

MICKI UTSLER
RECORDER

Prepared by Mark L. Lee, LEE Engineers & Surveyors, 3031 NW 86th Street, Urbandale, Iowa 50322 Phone: 515-252-7457

UNITED STATES PUBLIC LAND SURVEY CORNER CERTIFICATE OF

Land Survey Monuments situated in Section 13, Township 77 North, Range 29 West, of the Fifth Principal Meridian, MADISON County, Iowa.

Previously recorded in N/A in the County Recorder's Office.

Monument Description and Remarks: SOUTH 1/4 COR (NO TIES) FND 1 1/4 I.P.
3' OUT OF GROUND - ON LINE BTW SW COR & SE COR. DIST BTW S 1/4 & SE COR
FND LONGER THAN ORIGINAL GOV'T SURVEY. DIST BTW S 1/4 & SE COR FND
APPROX. SAME AS ALL EXCESS FND BY ORIGINAL GOV'T SURVEY FOR S. LINE
SEC 13. SW COR SE 1/4 SE 1/4 SET ON LINE EQUIDISTANT BTW S 1/4 AND SE COR.

PLAN - VIEW

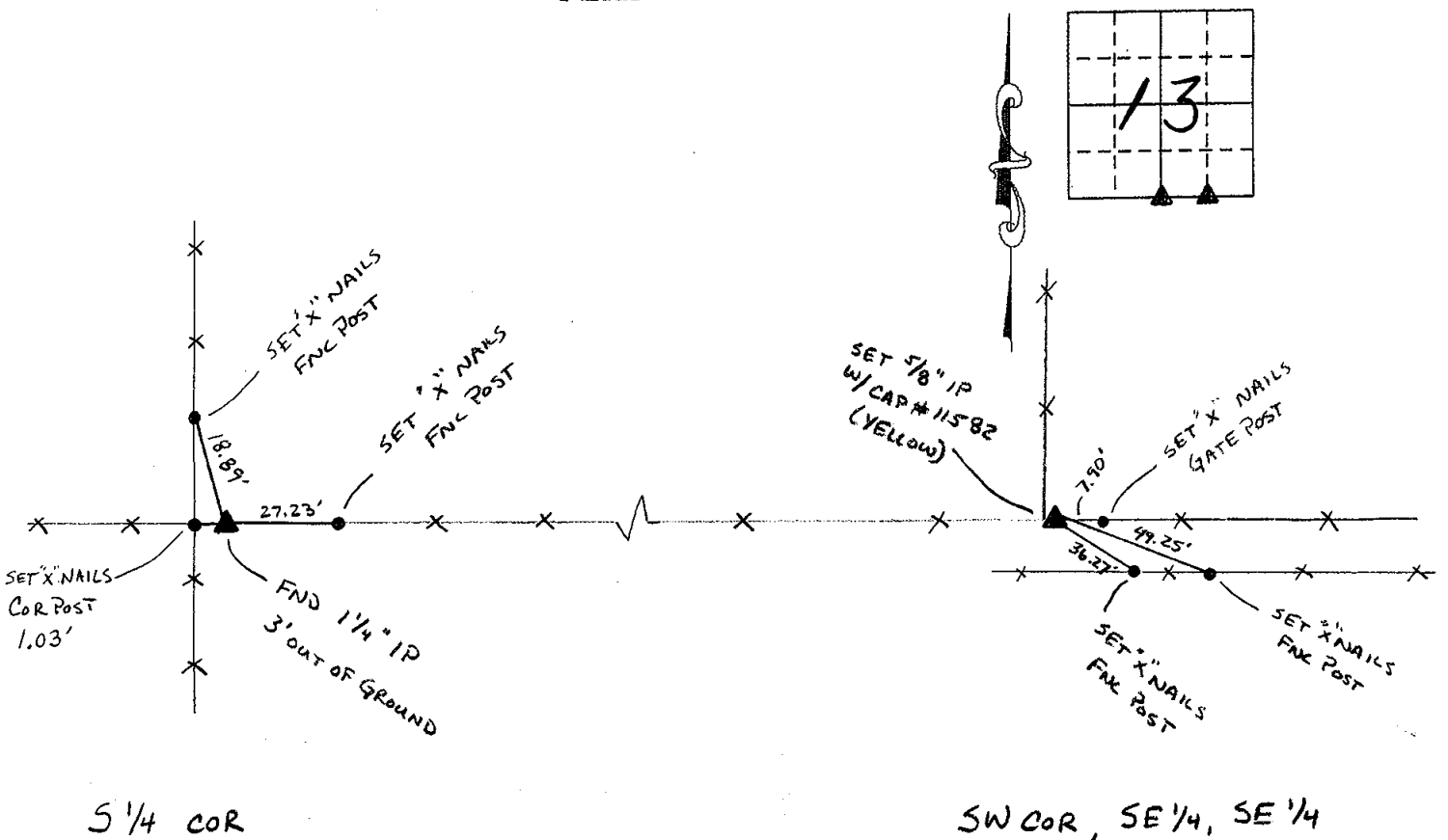

IP = IRON PIPE

I hereby certify that this land surveying document was prepared and the related survey work was performed by me or under my direct personal supervision and that I am a duly licensed Land Surveyor under the laws of the State of Iowa.

Signature: Mark L. Lee
Mark L. Lee

Date: 12-26-02 Reg. No. 11582
My license renewal date is Dec. 31, 2002.

Corners	Corners to be Indexed		
	Section	Twp.	Range
S 1/4 COR	13	77	29
SW COR SE 1/4, SE 1/4	13	77	29

