

REC \$ 5^e
 AUD \$
 R.M.F. \$

COMPUTER	<input checked="" type="checkbox"/>
RECORDED	<input checked="" type="checkbox"/>
COMPARED	<input type="checkbox"/>

MICKI UTSLER
 RECORDER
 MADISON COUNTY, IOWA

VANCE & HOCHSTETLER, P.C., CONSULTING ENGINEERS, WINTERSET, IOWA (515) 462-3995
02-112 S CHARLES T. VANCE, 110 West Green St., Winterset, Iowa, 50273
 JAMES M HOCHSTETLER, 110 West Green St., Winterset, Iowa 50273

UNITED STATES PUBLIC LAND SURVEY CORNER CERTIFICATE

Land Survey Monuments situated in Section 32 OF 76 N Township, Range 29 W of the Fifth Principal Meridian, MADISON County, Iowa.
 Previously recorded in _____ in County Recorder's Office.
 (book, page, document number, etc.)

(Show reason for preparing this certificate, the evidence and detailed procedures used in establishing the the corner positions and monumentation found or placed.)

Monument Description and Remarks: NE COR SE 1/4 SE 1/4 - Found limestone with "X" cut in top.

S 1/4 Cor. - Found 5/8" Iron Rod shown in old corner ties at County Engineers office.

NW Cor. SW 1/4 SE 1/4 - Set yellow CIR #6808 based on projection of portion of road @ from South and old property line fence from East. Could not find stone noted in old notes at Co. Engr's office
 PLAN - VIEW

(Show a minimum of three reference ties to durable physical objects, relevant monuments and physical conditions that will enable recovery of the corner.)

NE COR
 SE 1/4 SE 1/4

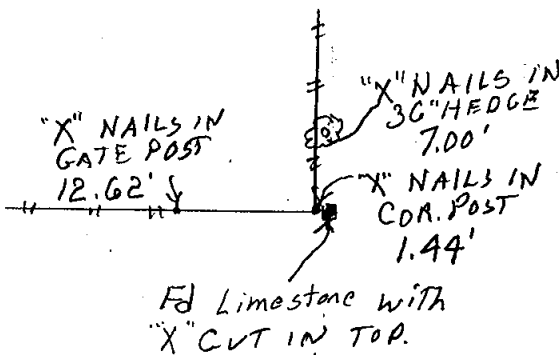

NW COR
 SW 1/4 SE 1/4

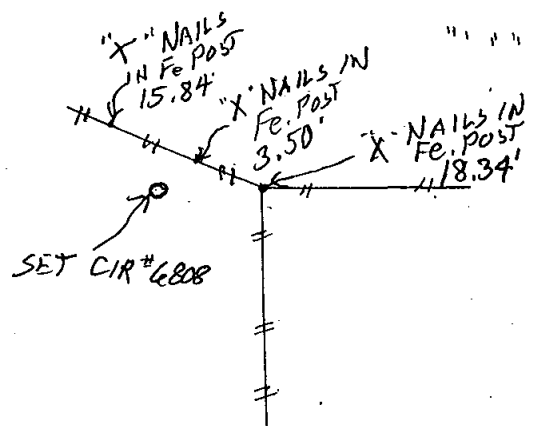
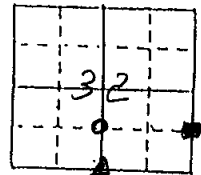

S 1/4 COR

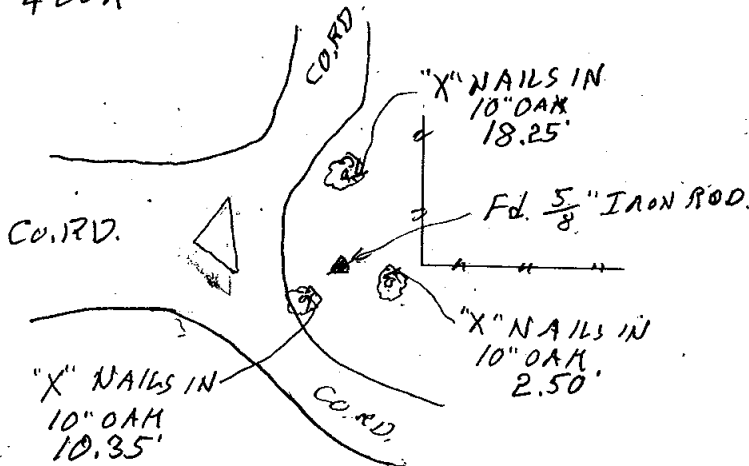

List Corners to be Indexed

Corners	Section	Twp	Range
NE COR SE 1/4 SE 1/4	32	76 N	29 W
S 1/4 COR.	32	76 N	29 W
NW COR SW 1/4 SE 1/4	32	76 N	29 W

I hereby certify that this land surveying document was prepared and the related survey work was performed by me or under my direct personal supervision and that I am a duly licensed Land Surveyor under the laws of the State of Iowa.

J.M. Hochstetler
 J.M. HOCHSTETLER
 License number 6808 Date 11/21/02
 My license renewal date is December 31, 2003
 Pages or sheets covered by this seal: 1

