

REC \$ 5⁰⁰
 AUD \$
 R.M.F. \$

FILED NO. **005033**
 BOOK **2002** PAGE **5033**

2002 OCT 14 AM 10:26

COMPUTER	<input checked="" type="checkbox"/>
RECORDED	<input checked="" type="checkbox"/>
COMPARED	<input type="checkbox"/>

MICKI UTSLER
 RECORDER
 MADISON COUNTY, IOWA

VANCE & HOCHSTETLER, P.C., CONSULTING ENGINEERS, WINTERSSET, IOWA (515) 462-3995
 02-1755 CHARLES T. VANCE, 110 West Green St., Winterset, Iowa, 50273
 JAMES M HOCHSTETLER, 110 West Green St., Winterset, Iowa 50273

UNITED STATES PUBLIC LAND SURVEY CORNER CERTIFICATE

OF
 Land Survey Monuments situated in Section 25, Township 77N, Range 28W,
 of the Fifth Principal Meridian, MADISON County, Iowa.
 Previously recorded in _____ in County Recorder's Office.
 (book, page, document number, etc.)

(Show reason for preparing this certificate, the evidence and detailed procedures used in establishing the the corner positions and monumentation found or placed.)

Monument Description and Remarks: E 1/4 Cor. - Found PK Nail in Hwy #169 at location shown on old DOT Plans.

NE Cor. SE 1/4 NE 1/4 - Set yellow CIR #6808 based on old ties by I.D.O.T in 1982. A Iron Pin was noted on ties but the tree immediately North of the Corner has grown over the pin and around a post set at the site.

PLAN - VIEW

(Show a minimum of three reference ties to durable physical objects, relevant monuments and physical conditions that will enable recovery of the corner.)

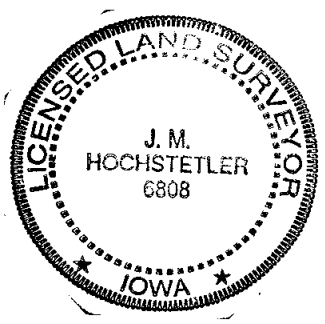
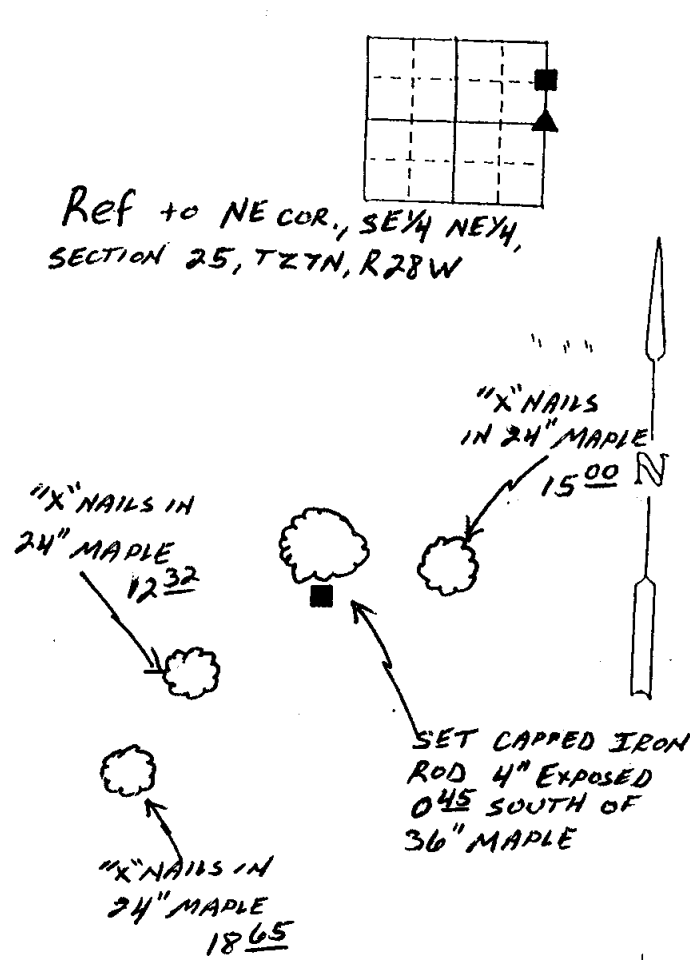
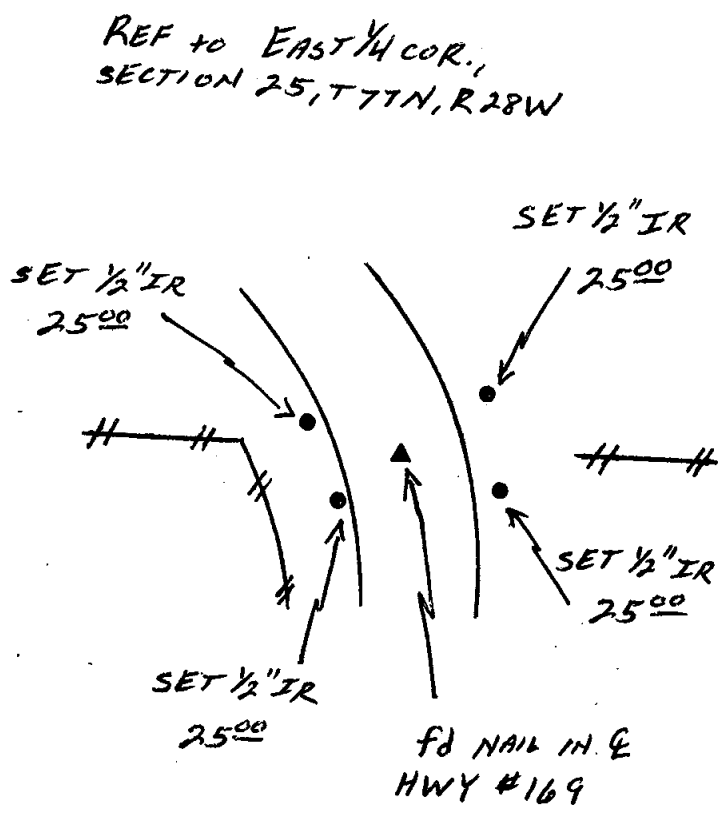

I hereby certify that this land surveying document was prepared and the related survey work was performed by me or under my direct personal supervision and that I am a duly licensed Land Surveyor under the laws of the State of Iowa.
J.M. Hochstetler
 J.M. HOCHSTETLER
 License number 6808 Date 9/25/02
 My license renewal date is December 31, 2003
 Pages or sheets covered by this seal: 1

List Corners to be Indexed

Corners	Section	Twp	Range
E 1/4 COR	25	77	28
NE COR SE 1/4 NE 1/4	25	77	28