

003428

FILED NO. \_\_\_\_\_  
BOOK 2002 PAGE 3428  
2002 JUL 15 AM 11:02

REC \$ 5<sup>00</sup>  
AUD \$ \_\_\_\_\_  
R.M.F. \$ 1<sup>00</sup>

COMPUTED   
RECORDED   
COMPARED \_\_\_\_\_

MICKI UTSLER  
RECORDER  
IOWA

**Nortline** Franklin Norton

425 9th Street • Carlisle, IA 50047 • (515) 989-3677

**Surveyors**

**UNITED STATES PUBLIC LAND SURVEY CORNER CERTIFICATE  
OF**

Land Survey Monuments situated in Section 20, Township 77, Range 26 West, of the Fifth Principal Meridian, MADISON County, Iowa.  
Previously recorded in N/A in County Recorder's Office.

(book, page, document number, etc.)

(Show reason for preparing this certificate, the evidence and detailed procedures used in establishing the corner positions and monumentation found or placed.)

Monument Description and Remarks:

Accepted & of road & E-W Boundary fence.

**PLAN - VIEW**

(Show a minimum of three reference ties to durable physical objects, relevant monuments and physical conditions that will enable recovery of the corner.)

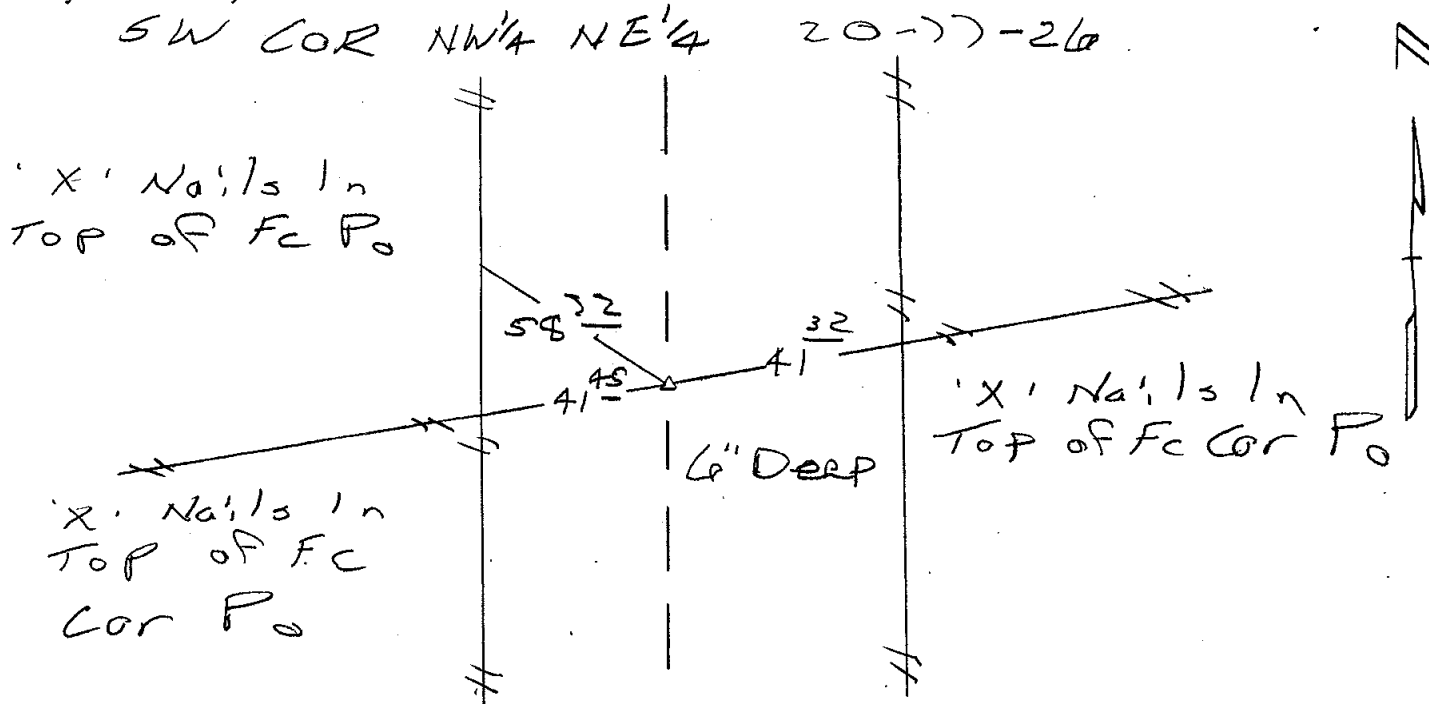

set 1/2" Iron Rod w/ yellow cap #5301

I hereby certify that the survey work was completed and this land surveying document was prepared by me or under my direct personal supervision and that I am a duly licensed Land Surveyor under the laws of the state of Iowa.

Signature: Franklin A. Norton  
Name typed or printed: FRANKLIN A. NORTON

Date: 6-15-02 Lisc. No. 5301

My license renewal date is December 31, 2002

List Corners to be Indexed

Corners	Section	Twp	Range
SW COR NW 1/4 NE 1/4	20	77	26

