

REC \$ 5⁰⁰
AUD \$
R.M.F. \$ 1⁰⁰

COMPUTER
RECORDED
COMPARED

MICKI UTSLER
RECORDER
MADISON COUNTY, IOWA

Prepared by: Boldman Land Surveying, L.L.C., P.O. Box 66, Winterset, Ia. 50273. Phone 515-462-9242

UNITED STATES PUBLIC LAND SURVEY CORNER CERTIFICATE OF

Land Survey Monuments situated in Section 17, Township 75 North, Range 28 West, of the Fifth Principal Meridian, Madison County, Iowa
Previously recorded in None recorded in County Recorder's Office,
(book, page, document number, etc.)

(Show reason for preparing this certificate, the evidence and detailed procedures used in establishing the corner positions found or placed.) All monuments 1/2"x24" rebar with orange plastic cap stamped "LS 13427"

Monument Description and Remarks: ^① set at split of right of way fences in line with fence west.
^② set at ancient 3-way fence post.

PLAN-VIEW

(Show a minimum of three reference ties to durable physical objects, relevant monuments and physical conditions that will enable recovery of the corner.)

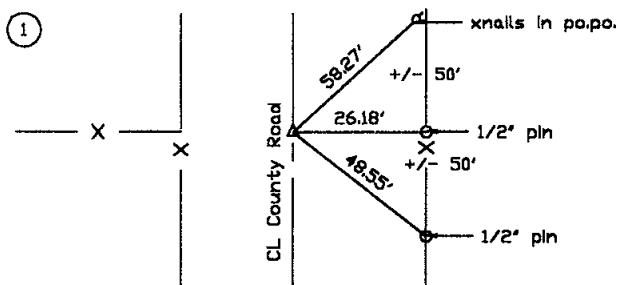

Reference N 1/4 Corner

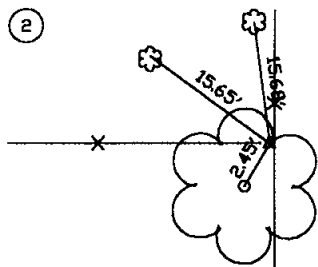

Reference NE Corner

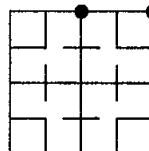

I HEREBY CERTIFY THAT THIS LAND SURVEYING DOCUMENT WAS PREPARED AND THE RELATED SURVEY WORK WAS PERFORMED BY ME OR UNDER MY DIRECT PERSONAL SUPERVISION AND THAT I AM A DULY LICENSED LAND SURVEYOR UNDER THE LAWS OF THE STATE OF IOWA.

SIGNATURE: *Craig S. Boldman*

NAME: CRAIG S. BOLDMAN

DATE: *5/16/02*

MY LICENSE RENEWAL DATE IS: DECEMBER 31, 2002

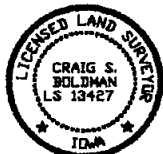

List Corners to be Indexed

Corners	Section	Twp	Range
NE	17	75	28
N 1/4	17	75	28