

REC \$ 5⁰⁰
AUD \$
R.M.F. \$

COMPUTER
RECORDED
COMPARED

MICKI UTSLER
RECORDER
MADISON COUNTY, IOWA

VANCE & HOCHSTETLER, P.C., CONSULTING ENGINEERS, WINTERSSET, IOWA (515) 462-3995
01-141S CHARLES T. VANCE, 110 West Green St., Winterset, Iowa, 50273
JAMES M HOCHSTETLER, 110 West Green St., Winterset, Iowa 50273

UNITED STATES PUBLIC LAND SURVEY CORNER CERTIFICATE

Land Survey Monuments situated in Section 9 OF 9, Township 76 North, Range 29 West, of the Fifth Principal Meridian, MADISON County, Iowa.
Previously recorded in _____ in County Recorder's Office.
(book, page, document number, etc.)

(Show reason for preparing this certificate, the evidence and detailed procedures used in establishing the the corner positions and monumentation found or placed.)

Monument Description and Remarks:

S. 1/4 cor. - Set Capped Iron Rod #6808 (1/2" rebar, 4" deep) at road R.O.W. split in line with property line fence to North & South.

SW cor. - Fd Nail (20" deep) - replaced with C.I.R. #6808 (1/2" rebar, 6" deep) at road centerline intersection.

PLAN - VIEW

(Show a minimum of three reference ties to durable physical objects, relevant monuments and physical conditions that will enable recovery of the corner.)

SOUTH 1/4 COR.

SEC. 9-76-29

Set C.I.R. #6808

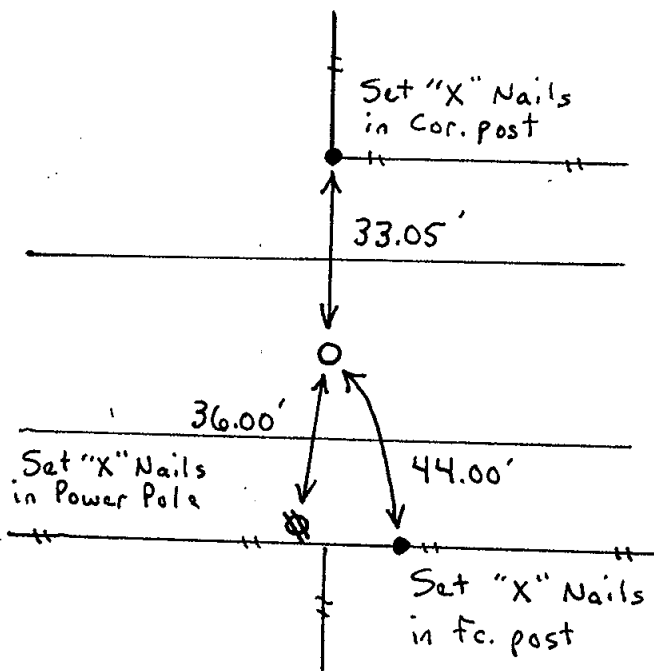

SW CORNER

SEC. 9-76-29

Set C.I.R. #6808

over found nail

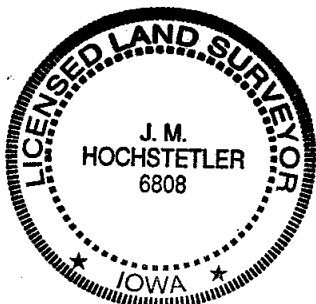
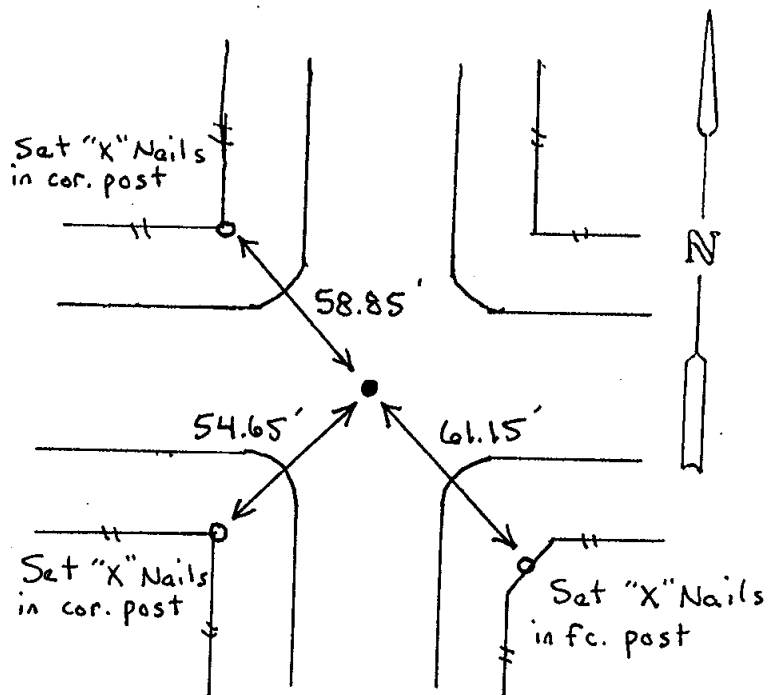
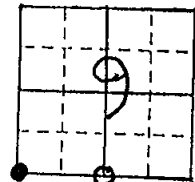

I hereby certify that this land surveying document was prepared and the related survey work was performed by me or under my direct personal supervision and that I am a duly licensed Land Surveyor under the laws of the State of Iowa.

J.M. Hochstetler
J.M. HOCHSTETLER
License number 6808 Date 8/6/01
My license renewal date is December 31, 2001
Pages or sheets covered by this seal: 1

List Corners to be Indexed

Corners	Section	Twp	Range
S. 1/4 cor.	9	76N	29W
SW cor.	9	76N	29W