

MICHELLE "MICKI" UTSLER, COUNTY RECORDER
MADISON IOWA

Prepared by Mark L. Lee, LEE Engineers & Surveyors, 8003 Douglas Avenue, Urbandale, Iowa 50322 Phone: 515-252-7457

UNITED STATES PUBLIC LAND SURVEY CORNER CERTIFICATE OF

Land Survey Monuments situated in Section 27, Township 74 North, Range 27 West, of
the Fifth Principal Meridian, MADISON County, Iowa.

Previously recorded in NONE in the County Recorder's Office.

Monument Description and Remarks: SOUTHWEST CORNER OF THE S.E. 1/4, S.E. 1/4 = SET 5/8" IRON
PIPE ONLINE BETWEEN THE SOUTH QUARTER CORNER AND THE SOUTHWEST CORNER;
ALSO USED NORTH-SOUTH FENCE LINE AND AERIAL PHOTOS.

NORTHEAST CORNER OF THE S.E. 1/4, S.E. 1/4 = SET 5/8" IRON PIPE WITH YELLOW CAP #11582 AT EQUAL
DISTANCE AND ONLINE BETWEEN THE EAST QUARTER CORNER AND THE SOUTHWEST CORNER.

NOTE: TIES ARE TO "X" NAILS
ON FENCE POSTS

PLAN - VIEW

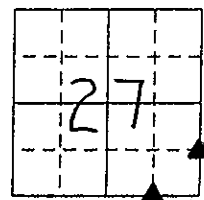
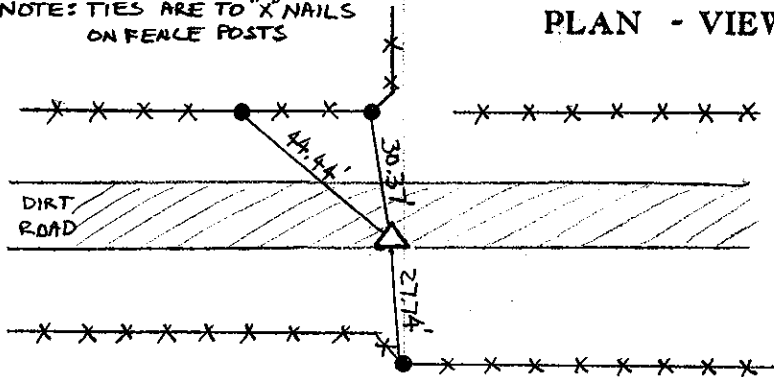

LEGEND

- ▲ FOUND SECTION CORNER MONUMENT
- FOUND MONUMENT
- I FOUND CHISELED "X" IN RIGHT-OF-WAY RAIL
- ⊗ FND "X" NAILS IN FENCE POST
- △ SECTION CORNER SET 5/8" I.P. W/YELLOW CAP #11582 (UNLESS NOTED)
- SET 1/2" I.R.
- × SET "X" NAILS IN FENCE POST
- I.P. IRON PIPE
- I.R. IRON ROD (REROD)
- (M) MEASURED DIMENSION
- (R) RECORDED DIMENSION
- SECTION LINE
- - - CENTERLINE
- × - × FENCE LINE
- ☼ SET "X" NAILS IN DECIDUOUS TREE

SOUTHWEST CORNER OF THE
S.E. 1/4, S.E. 1/4
SET 5/8" IRON PIPE W/YELLOW CAP #11582

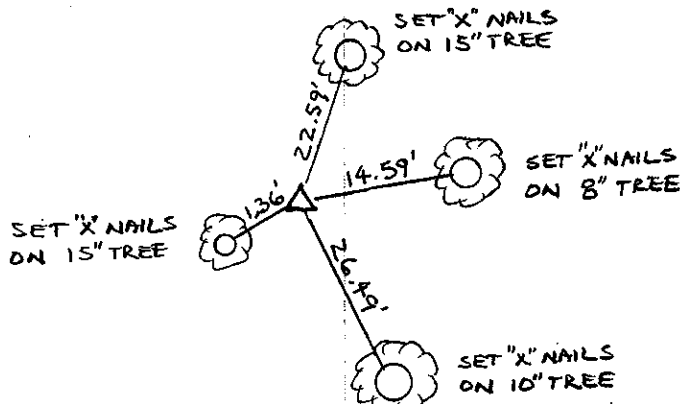

NORTHEAST CORNER OF THE
S.E. 1/4, S.E. 1/4
SET 5/8" IRON PIPE W/YELLOW CAP #11582

I hereby certify that this land surveying document was prepared and
the related survey work was performed by me or under my direct
personal supervision and that I am a duly licensed Land Surveyor
under the laws of the State of Iowa.

Signature: Mark L. Lee
Mark L. Lee

Date: 1-12-05 Reg. No. 11582
My license renewal date is Dec. 31, 2006.

Corners	Corners to be Indexed		
	Section	Twp.	Range
S.W. CORNER S.E. 1/4, S.E. 1/4	27	74	27
N.E. CORNER S.E. 1/4, S.E. 1/4	27	74	27

