

007202

FILED NO. _____

BOOK 2 PAGE 189

2000 NOV 28 PM 1:09

REC \$ 5⁰⁰
AUD \$ _____
R.M.F. \$ 1⁰⁰

COMPUTER
RECORDED
COMPARED _____

MICKI UTSLER
RECORDER
MADISON COUNTY IOWA
5050865

VANCE & HOCHSTETLER, P.C., CONSULTING ENGINEERS, WINTERSSET, IOWA (515) 462-3995
CHARLES T. VANCE, 110 West Green St., Winterset, Iowa, 50273
JAMES M HOCHSTETLER, 110 West Green St., Winterset, Iowa 50273

UNITED STATES PUBLIC LAND SURVEY CORNER CERTIFICATE

Land Survey Monuments situated in Section 20 OF 20 Township 74 North, Range 26 West, of the Fifth Principal Meridian, MADISON County, Iowa.
Previously recorded in _____ in County Recorder's Office.
(book, page, document number, etc.)

(Show reason for preparing this certificate, the evidence and detailed procedures used in establishing the the corner positions and monumentation found or placed.)

Monument Description and Remarks:

Center - Set Capped Iron Rod #6808 (1/2" rebar, exposed) at existing fence corner.
SW cor. SE. 1/4 NE. 1/4 - Set C.I.R. #6808 (1/2" rebar, 4" deep) at road R.O.W. split

PLAN - VIEW

(Show a minimum of three reference ties to durable physical objects, relevant monuments and physical conditions that will enable recovery of the corner.)

CENTER
SEC. 20-74-26
Set C.I.R. #6808

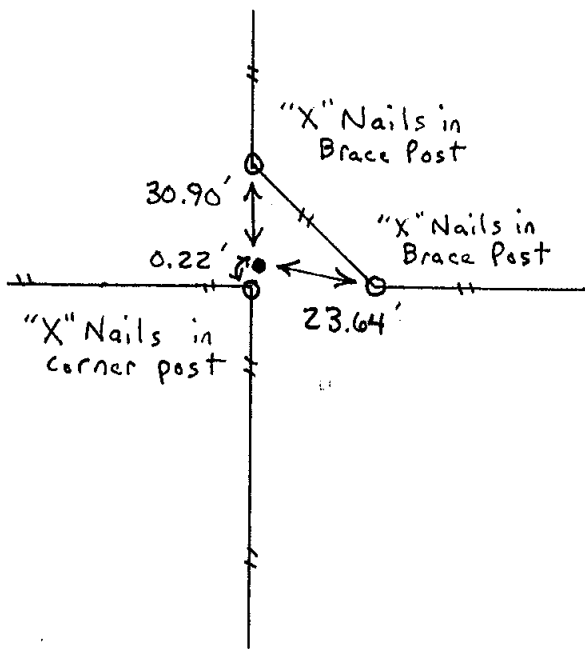

SW CORNER
SE. 1/4 NE. 1/4
SEC. 20-74-26
Set C.I.R. #6808

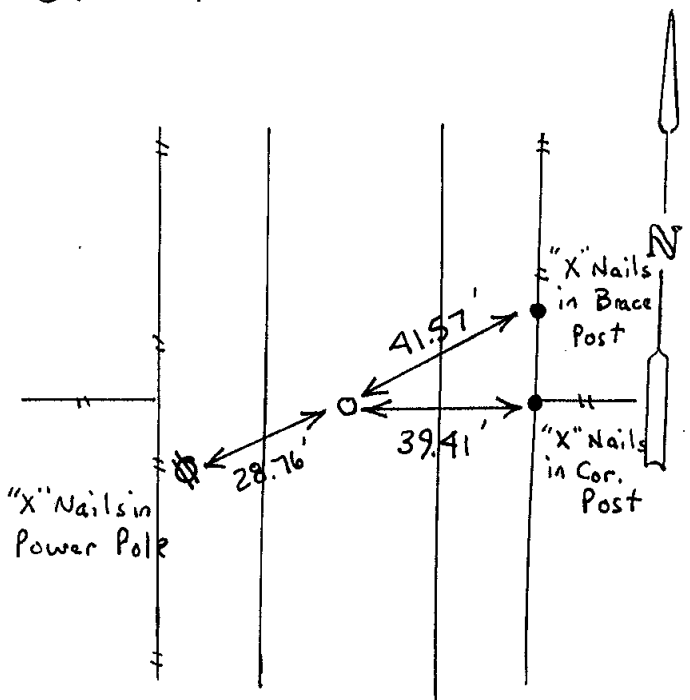
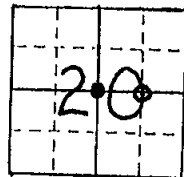

List Corners to be Indexed

Corners	Section	Twp	Range
Center	20	74 N	26 W
SW cor. SE. 1/4 NE. 1/4	20	74 N	26 W

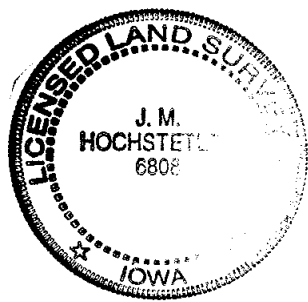

I hereby certify that this land surveying document was prepared and the related survey work was performed by me or under my direct personal supervision and that I am a duly licensed Land Surveyor under the laws of the State of Iowa.

J.M. Hochstetler
J.M. HOCHSTETLER

License number 6808 Date 11/8/2000

My license renewal date is December 31, 2001

Pages or sheets covered by this seal: 1