

007201

FILED NO. \_\_\_\_\_

BOOK 2 PAGE 188

2000 NOV 28 PM 1:08

REC \$ 5<sup>00</sup>  
AUD \$ \_\_\_\_\_  
R.M.F. \$ 1<sup>00</sup>

COMPUTER ✓  
RECORDED ✓  
COMPARED \_\_\_\_\_

MICKI UTSLER  
RECORDER  
MADISON COUNTY, IOWA

✓ VANCE & HOCHSTETLER, P.C., CONSULTING ENGINEERS, WINTERSSET, IOWA (515) 462-3995  
CHARLES T. VANCE, 110 West Green St., Winterset, Iowa, 50273  
JAMES M HOCHSTETLER, 110 West Green St., Winterset, Iowa 50273

UNITED STATES PUBLIC LAND SURVEY CORNER CERTIFICATE

Land Survey Monuments situated in Section 20 OF 20 Township 74 North Range 26 West of the Fifth Principal Meridian, MADISON County, Iowa.  
Previously recorded in \_\_\_\_\_ in County Recorder's Office.  
(book, page, document number, etc.)

(Show reason for preparing this certificate, the evidence and detailed procedures used in establishing the the corner positions and monumentation found or placed.)

Monument Description and Remarks:  
NW cor. SE. 1/4 NE. 1/4 - Set Capped Iron Rod #6808 (1/2" rebar, flush with surface) at 1/4-1/4 section corner calculated using existing corner monuments, freshly set corner monuments, and existing property line fence corners.

PLAN - VIEW

(Show a minimum of three reference ties to durable physical objects, relevant monuments and physical conditions that will enable recovery of the corner.)

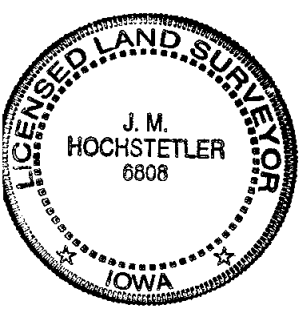
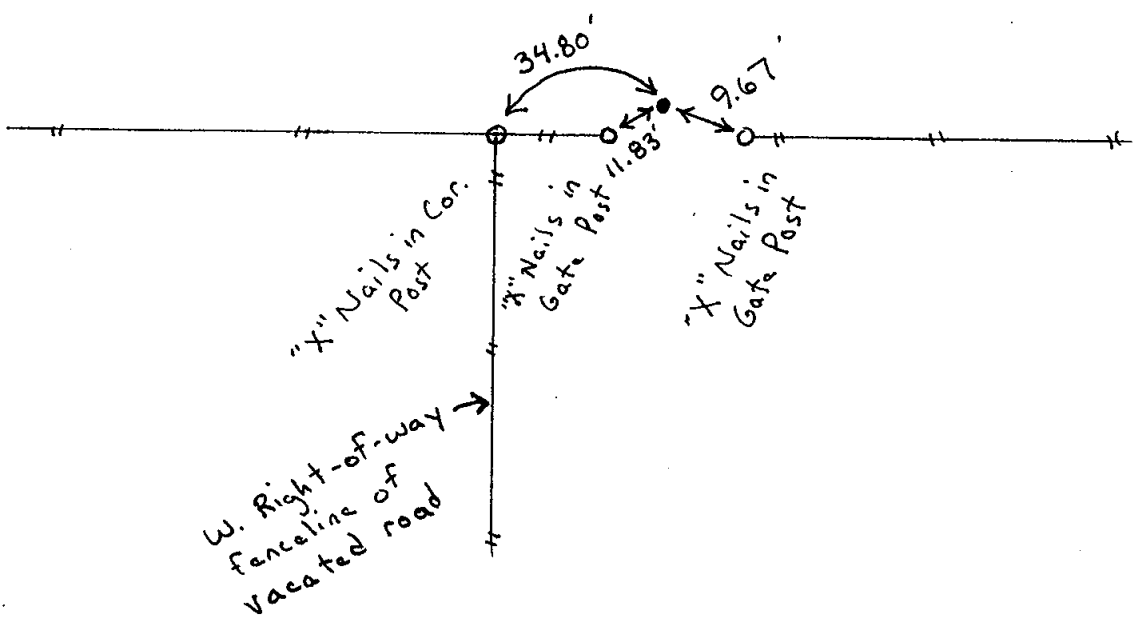
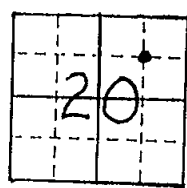

I hereby certify that this land surveying document was prepared and the related survey work was performed by me or under my direct personal supervision and that I am a duly licensed Land Surveyor under the laws of the State of Iowa.  
J. M. Hochstetler  
J. M. HOCHSTETLER  
License number 6808 Date 11/8/2000  
My license renewal date is December 31, 2001  
Pages or sheets covered by this seal:

List Corners to be Indexed

Corners	Section	Twp	Range
NW cor.	20	74N	26W
SE. 1/4 NE. 1/4			