

REC'D 5⁰⁰
APR 10
RECORDED 1⁰⁰

COMPUTER
RECORDED
COMPARED _____

2000 JUL 11 PM 1:01

MICHELLE UTSLER
RECORDER
MADISON COUNTY, IOWA

Prepared By: J. Brian Morrissey, Morrissey Surveying, 1405 Hwy. G28, Otley, Ia. 50214, Tel. (515) 627-5554

UNITED STATES PUBLIC LAND SURVEY CORNER CERTIFICATE OF

Land Survey Monuments situated in Section 16, Township 75N, Range 26W, of the Fifth Principal Meridian, Madison County, Iowa.
Previously recorded in N.A. in County Recorders Office.

(book, page, document number, etc.)

(Show reason for preparing this certificate, the evidence and detailed procedures used in establishing the corner positions and monumentation found or placed.)

Monument Description and Remarks: Found 3"x7"x24" pointed limestone, exposed 6". Set 5/8" rebar, orange plastic cap, #7995 on N. side of stone as a witness only. Accepted position of limestone.

PLAN VIEW

(Show a minimum of three reference ties to durable physical objects, relevant monuments and physical conditions that will enable recovery of the corner.)

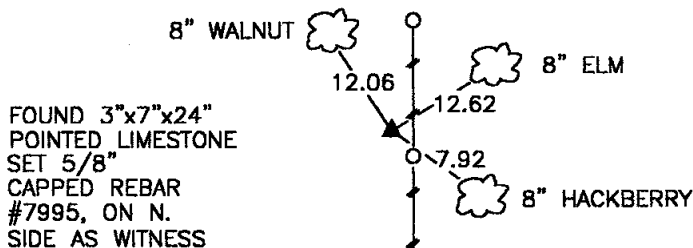
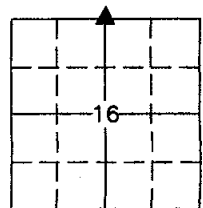

NE. COR., NW. 1/4, SEC. 16

NOTE: ALL TIES TO 'x' NAILS UNLESS NOTED



I hereby certify that the survey work was completed and this certificate was prepared by me or under my direct personal supervision and that I am a duly Licensed Land Surveyor under the laws of the State of Iowa.

Signature: J. Brian Morrissey Date: 7/10/00
J. Brian Morrissey

License number 7995.
My license renewal date is December 31, 2001