

FILED NO. **005519**

BOOK **64** PAGE **167**

2000 AUG 10 PM 3:49

MICKI UTSLER
RECORDER
MADISON COUNTY, IOWA

RECS 30⁰⁰
AUD \$
R.M.F. \$ 1⁰⁰

COMPUTER
RECORDED
COMPARED



Mark Nitchals
City Administrator
101 E. Jefferson
Winterset IA 50273
(515) 462-1422

CERTIFICATION OF VOLUNTARY ANNEXATION

I, the undersigned City Clerk of the City of Winterset, Iowa, hereby certifies that attached are true and correct copies of a Resolution Assenting to the Annexation of Certain Real Estate to the City of Winterset, the Application for Voluntary Annexation, legal description of the real estate, and maps showing its location in relationship with the existing City limits. This filing is made pursuant to the requirements of Section 368.7 of the Code of Iowa.

Witness my hand and the City Seal this 10th day of August, 2000.





Mark Nitchals, City Clerk

RESOLUTION 2000- 87

RESOLUTION ASSENTING TO THE ANNEXATION
OF CERTAIN REAL ESTATE
TO THE CITY OF WINTERSET, IOWA

WHEREAS, the City of Winterset, State of Iowa, is a duly organized municipal corporation;

WHEREAS, there has been presented to the City Council of said City an Application for Annexation, as required by Section 368.7 of the Code of Iowa, executed by Ronald B. Wass & Kathie J. Wass, the owners of the real estate to be annexed;

WHEREAS, said real estate described on the Application is adjacent to the existing City limits of the City with the owners of the parcels shown on the accompanying plat in Exhibit "A" attached hereto; and,

WHEREAS, the City of Winterset, Iowa desires to annex said territory upon the Application presented.

NOW, THEREFORE, IT IS HEREBY RESOLVED by the City Council of the City of Winterset, Iowa as follows:

1. That the Application for Annexation of the real estate as described in Exhibit "A" attached hereto is hereby approved.

2. That on the passage of this Resolution this territory shall thereafter be and become a part of the City of Winterset, Iowa.

3. That the Clerk shall forthwith cause this Resolution and the exhibit attached hereto to be filed with the City Development Board, the Madison County Recorder, the Iowa Secretary of State, and the District Office of the Iowa Department of Transportation as required by Section 368.7 of the Code of Iowa.

Passed and approved this 7th day of August, 2000.

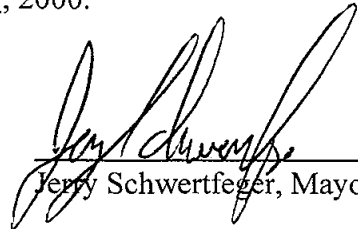

Jerry Schwertfeger, Mayor

ATTEST:



Mark Nitchals, City Administrator

APPLICATION FOR VOLUNTARY ANNEXATION

TO: CITY OF WINTERSET, IOWA

The undersigned applicants hereby apply to the City of Winterset, Iowa that the following described real estate be annexed to the City of Winterset, Iowa, to-wit:

(See attached legal description)

The applicants attach hereto as a part of this application a map of the said real estate to be annexed showing its location in relationship to the existing limits of the City of Winterset, Iowa.

The said real estate is not within the urbanized area of a city other than the City to which this Application is directed.

The undersigned applicants do hereby certify that they hold the said real estate by title in fee simple and they have good and lawful authority to make this Application.

Dated on this 4th day of Aug., 2000.

Donald B. Wass

Kathie J. Wass

EXHIBIT "A"

Parcel "D" located in that part of the Northwest Quarter (1/4) of the Northwest Quarter (1/4) of Section Thirty (30), Township Seventy-six (76) North, Range Twenty-seven (27) West of the 5th P.M., Madison County, Iowa, described as follows: Commencing at the Northwest Corner of said Section Thirty (30); thence on an assumed bearing of South 00°00'00" East along the west line of the Northwest Quarter (1/4) of said Section thirty (30) a distance of 1178.50 feet; thence North 82°40'41" East 272.80 feet; thence North 52°08'16" East 270.54 feet; thence North 30°31'10" East 466.75 feet; thence South 89°39'21" East 459.04 feet; thence South 00°00'41" West 167.68 feet; thence South 26°34'14" West 288.78 feet; thence South 48°56'20" East 90.01 feet to the point of beginning; thence North 16°22'05" East 268.86 feet; thence South 89°59'19" East 301.05 feet; thence South 00°22'20" East 275.00 feet; thence South 89°50'33" West 357.86 feet; thence North 48°56'20" West 27.52 feet to the point of beginning. Said trace contains 2.16 acres; And an Access-Utility Easement as recorded on Plat of Survey recorded in Farm Plat Bk 2, Page 428 Madison County Recorder's Office, Madison County, Iowa, described as follows: A 50 foot wide ingress-egress and utility easement, being 25 feet wide on both sides of the following described centerline, in the NW. Frac. 1/4 of the NW. 1/4 of Section 30, T76N, R27W of the 5th P.M., Madison County, Iowa; Commencing at the Northwest Corner of Section 30, T76N, R27W of the 5th P.M., thence along the West line of the NW. Frac. 1/4 of the NW. 1/4 of said Section 30, South 00°00'00", 1203.67 feet to the Point of Beginning of the easement centerline; thence North 82°41'05" East, 282.82 feet; thence North 52°04'00" East, 271.00 feet; thence North 39°40'10" East, 324.92 feet; thence Easterly 183.08 feet along a 100 foot radius curve, concave Southerly, with a central angle of 104°53'50" and a long chord bearing South 87°52'55" E., 156.56 feet; thence South 35°26'00" East, 280.07 feet to a point at the center of a 120 foot diameter Cul-de-sac; And a 50 foot wide ingress-egress (access) easement and utility easement, over, under and across, and being 25 feet either side of the following described centerline: Beginning at the center of said 120 foot diameter Cul-de-sac; thence on an assumed bearing of North 89°33'41" East 119.67 feet; thence North 16°22'05" East 186.17 feet; thence North 10°26'46" East 58.12 feet; thence North 00°00'41" East 169.81 feet to the terminus of said access-utility easement,

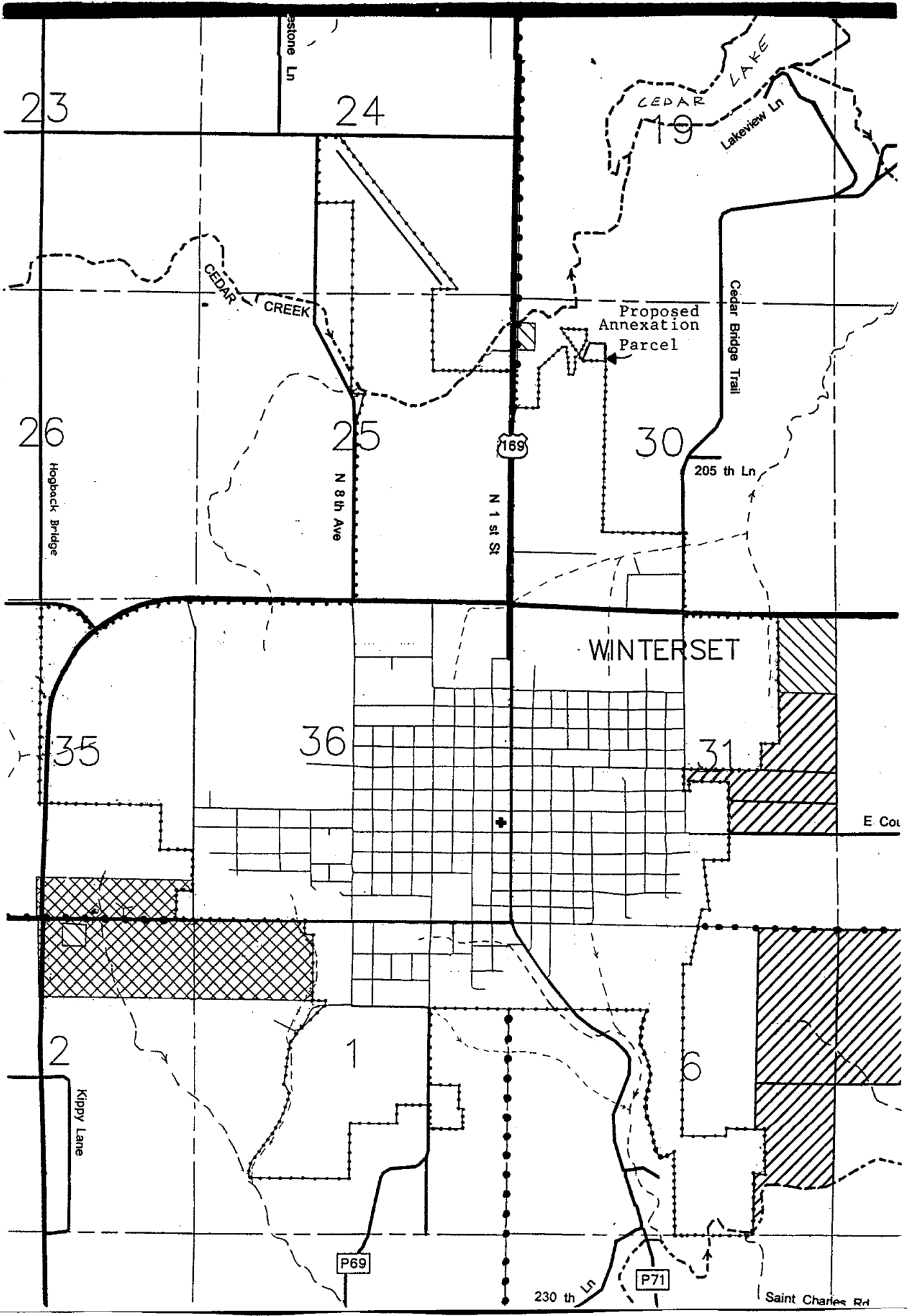

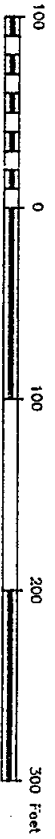

SCHWERTFEGER PROPERTY, MADISON COUNTY, IA
7/20/98

