

RECS 5⁰⁰
AMT \$ 10
P.M.F. \$ 10

COMPUTER
RECORDED
COMPARED

MICKI UTSLER
RECORDER
MADISON COUNTY, IOWA

PREPARED BY: JAMES E. NORMAN - PO BOX 39 - CRESTON, IOWA, 50801 - (515)-782-5154

UNITED STATES PUBLIC LAND CORNER CERTIFICATE OF

SHEET 1 OF 1

LAND SURVEY MONUMENTS SITUATED IN SECTION 2, TOWNSHIP 74
NORTH, RANGE 29 WEST, OF THE 5TH P.M. IN MADISON COUNTY, IOWA.
PREVIOUSLY RECORDED IN BOOK , PAGE .
(NOT PREVIOUSLY RECORDED)

MONUMENT DESCRIPTION AND REMARKS:

- ① E1/4 COR. SEC. 2-74-29, SET 5/8" X 30" IRON PIN #11808 USING \odot ROAD S AND FENCE LINES E-W.
- ② S1/4 COR. SEC. 2-74-29, SET 1/2" X 18" IRON PIN #11808 USING \odot ROAD E-W AND FENCE LINE N.
- ③ SE COR. SEC. 2-74-29, FOUND 5/8" IRON PIN 12" DEEP.

PLAN VIEW

(SHOW A MINIMUM OF THREE REFERENCE TIES TO DURABLE PHYSICAL OBJECTS, RELEVANT MONUMENTS, AND PHYSICAL CONDITIONS THAT WILL ENABLE RECOVERY OF THE CORNER.)

①

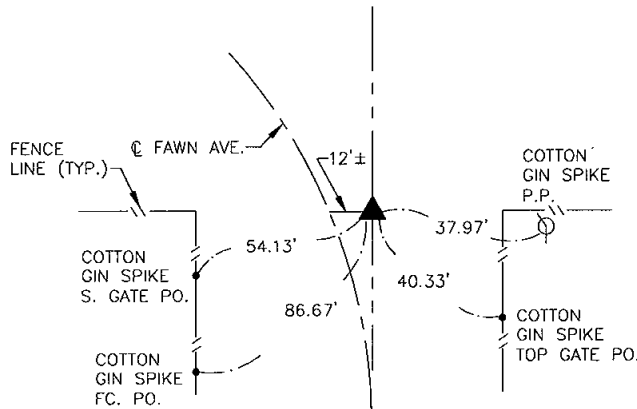

TIES TO E1/4 COR. SEC. 2-74-29

②

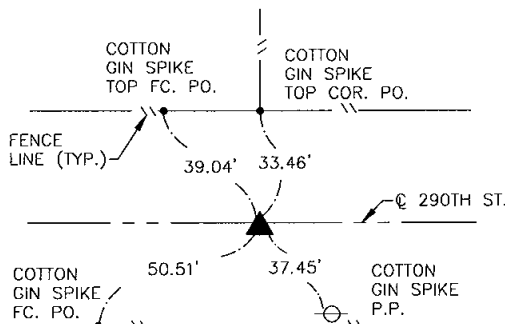

TIES TO S1/4 COR. SEC. 2-74-29

③

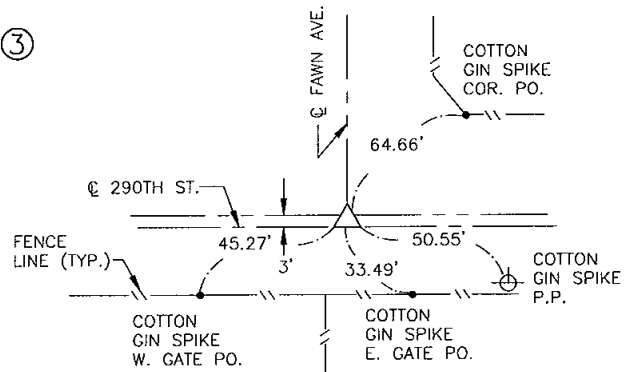

TIES TO SE COR. SEC. 2-74-29

I HEREBY CERTIFY THAT THIS LAND SURVEYING DOCUMENT WAS PREPARED AND THE RELATED SURVEY WORK WAS PERFORMED BY ME OR UNDER MY DIRECT PERSONAL SUPERVISION AND THAT I AM A DULY LICENSED LAND SURVEYOR UNDER THE LAWS OF THE STATE OF IOWA.

James E. Norman 8-10-00
JAMES E. NORMAN, L.S. DATE

LICENSE NUMBER 11808
MY LICENSE RENEWAL DATE IS DECEMBER 31, 2001
PAGES OR SHEETS COVERED BY THIS SEAL: SHEET 1 OF 1

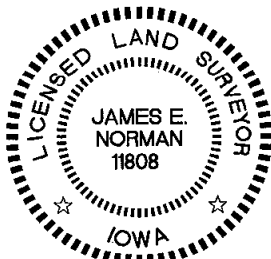

Howard R. Green Company
CONSULTING ENGINEERS

LIST CORNERS TO BE INDEXED

CORNERS	SECTION	TWP.	RANGE
E1/4	2	74	29
S1/4	2	74	29
SE	2	74	29

SURVEY FOR: S.I.R.W.A.
DATE: 4-10-00