

FILED NO. **004489**

BOOK 2 PAGE 159

2000 MAY 31 PM 1:28

MICHELLE L. BLOOM **445**
RECORDER
MADISON COUNTY, IOWA

REC'D 5⁰⁰
AUD'S
R.M.P. \$ 1.00

COMPUTER
RECORDED
COMPARED _____

VANCE & HOCHSTETLER, P.C., CONSULTING ENGINEERS, WINTERSSET, IOWA (515) 462-3995
CHARLES T. VANCE, 110 West Green St., Winterset, Iowa, 50273
JAMES M HOCHSTETLER, 110 West Green St., Winterset, Iowa 50273

UNITED STATES PUBLIC LAND SURVEY CORNER CERTIFICATE

Land Survey Monuments situated in Section 4 OF 4, Township 75 North, Range 27 West, of the Fifth Principal Meridian, MADISON County, Iowa.
Previously recorded in _____ in County Recorder's Office.
(book, page, document number, etc.)

(Show reason for preparing this certificate, the evidence and detailed procedures used in establishing the the corner positions and monumentation found or placed.)

Monument Description and Remarks:

SE cor. NE. 1/4 SE. 1/4 - Set Capped Iron Rod #6808 (1/2" rebar, exposed) at calculated point shown on a 1991 Plat from C.T. Vance of a parcel located in the NE. 1/4 of the SE. 1/4 of Sec. 4 (filed at County Recorder's office); point was established by projecting a line from the E. 1/4 cor through the SE corner of said plat with a distance South from the SE cor as shown on the 1991 plat.
PLAN - VIEW

(Show a minimum of three reference ties to durable physical objects, relevant monuments and physical conditions that will enable recovery of the corner.)

SE CORNER
NE. 1/4 SE. 1/4
SEC. 4-75-27
Set C.I.R. #6808

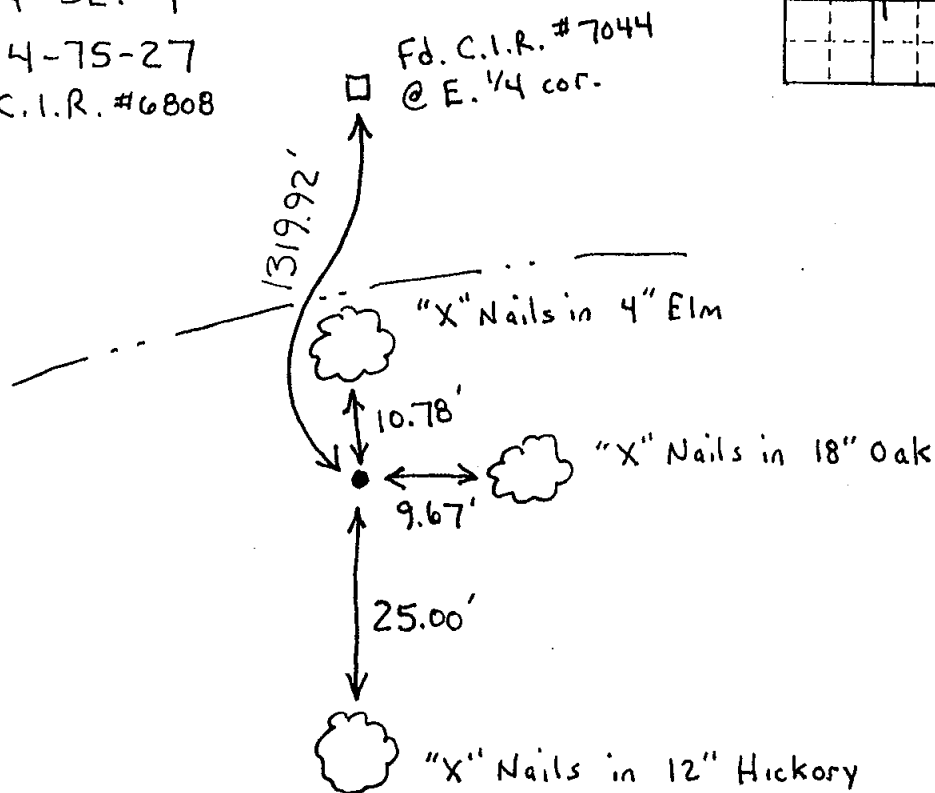
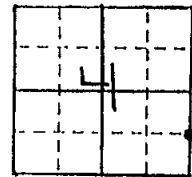

List Corners to be Indexed

Corners Section Twp Range

SE cor. 4 75N 27W
NE. 1/4 SE. 1/4

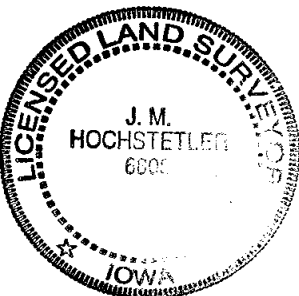

I hereby certify that this land surveying document was prepared and the related survey work was performed by me or under my direct personal supervision and that I am a duly licensed Land Surveyor under the laws of the State of Iowa.

J.M. Hochstetler
J.M. HOCHSTETLER

License number 6808 Date 5/31/2000

My license renewal date is December 31, 2001.

Pages or sheets covered by this seal: 1