

UNITED STATES PUBLIC LAND SURVEY CORNER CERTIFICATE

OF

Land Survey Monuments situated in Section 21, Township 76 N, Range 27 W, of the Fifth Principal Meridian, MADISON County, Iowa. Previously recorded in \_\_\_\_\_ in County Recorder's Office.

(book, page, document number, etc.)  
 (Show reason for preparing this certificate, the evidence and detailed procedures used in establishing the corner positions and monumentation found or placed.)

Monument Description and Remarks: W 1/4 Cor. - Set CIR #6808 4" deep on projection of line from SW Cor. through NW Cor. SW 1/4 SW 1/4 at equal distance. Point was within reason of distance shown on old road dedication of road to East through SW 1/4 NW 1/4.  
N.E. COR NW 1/4 SW 1/4 - Set CIR #6808 on line between set W 1/4 Cor and found CIR #5041 at SE Cor SW 1/4 NE 1/4 at 1/3 total distance which fell within 4 feet of old fence.

PLAN - VIEW

(Show a minimum of three reference ties to durable physical objects, relevant monuments and physical conditions that will enable recovery of the corner.)

W 1/4 Cor.  
 SEC. 21-76-27

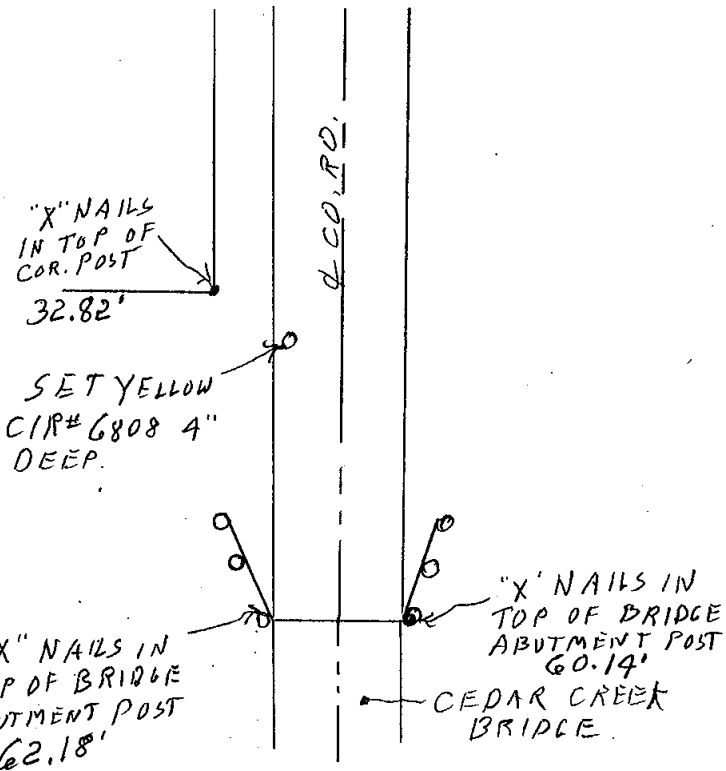

NE. COR  
 NW 1/4 SW 1/4  
 SEC. 21-76-27

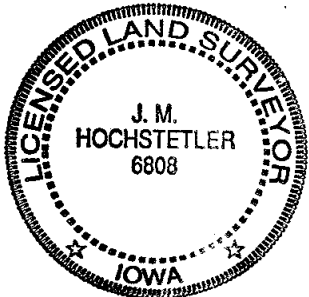
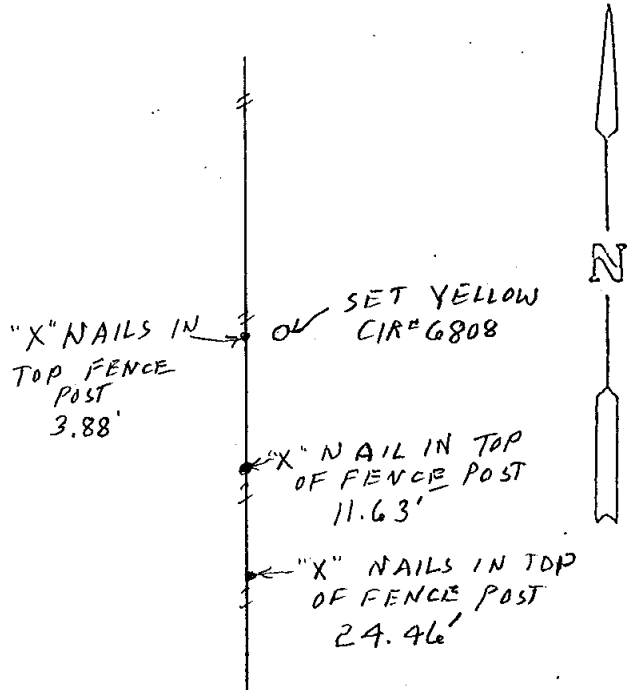
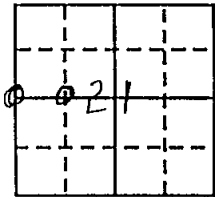

I hereby certify that this land surveying document was prepared and the related survey work was performed by me or under my direct personal supervision and that I am a duly licensed Land Surveyor under the laws of the State of Iowa.

*J.M. Hochstetler*  
 J.M. HOCHSTETLER

License number 6808 Date 5/24/2000  
 My license renewal date is December 31, 2001  
 Pages or sheets covered by this seal: 1

Corners	Section	Twp	Range
W 1/4 Cor.	21	76N	27W
NE COR NW 1/4 SW 1/4	21	76N	27W

REC \$ 5.00  
 AUD \$ \_\_\_\_\_  
 F.I.A.F. \$ 1.00

COMPUTER   
 RECORDED   
 COMPARED \_\_\_\_\_

004488  
 FILED NO. \_\_\_\_\_  
 BOOK 2 PAGE 158  
 2000 MAY 31 PM 1:27  
 MICHELLE UTSER  
 RECORDER  
 MADISON COUNTY, IOWA