



Document 2009 GW2535

Book 2009 Page 2535 Type 43 001 Pages 8

Date 8/10/2009 Time 2:14 PM

Rec Amt \$.00

INDX ✓
ANNO
SCAN
CHEK

LISA SMITH, COUNTY RECORDER
MADISON COUNTY IOWA

**REAL ESTATE TRANSFER - GROUNDWATER HAZARD STATEMENT
TO BE COMPLETED BY TRANSFEROR**

TRANSFEROR:

Name David M. Pickett and Marsha Cheers Pickett

Address 2675 State Hwy 92, Winterset, IA 50273

Number and Street or RR

City, Town or P.O.

State

Zip

TRANSFeree:

Name Bruce A. Bjorn and Michele A. Bjorn

Address 2656 Pinewood Ave., Greenfield, IA 50849

Number and Street or RR

City, Town or P.O.

State

Zip

Address of Property Transferred:

2675 State Hwy 92, Winterset, IA 50273

Number and Street or RR

City, Town, or P.O.

State

Zip

Legal Description of Property: (Attach if necessary) See 1 in Addendum

1. Wells (check one)

- There are no known wells situated on this property.
- There is a well or wells situated on this property. The type(s), location(s) and legal status are stated below or set forth on an attached separate sheet, as necessary.

2. Solid Waste Disposal (check one)

- There is no known solid waste disposal site on this property.
- There is a solid waste disposal site on this property and information related thereto is provided in Attachment #1, attached to this document.

3. Hazardous Wastes (check one)

- There is no known hazardous waste on this property.
- There is hazardous waste on this property and information related thereto is provided in Attachment #1, attached to this document.

4. Underground Storage Tanks (check one)

- There are no known underground storage tanks on this property. (Note exclusions such as small farm and residential motor fuel tanks, most heating oil tanks, cisterns and septic tanks, in instructions.)
- There is an underground storage tank on this property. The type(s), size(s) and any known substance(s) contained are listed below or on an attached separate sheet, as necessary.

5. Private Burial Site (check one)

- There are no known private burial sites on this property.
- There is a private burial site on this property. The location(s) of the site(s) and known identifying information of the decedent(s) is stated below or on an attached separate sheet, as necessary.

6. Private Sewage Disposal System (check one)

- There are no known private sewage disposal systems on this property.
- There is a private sewage disposal system on this property. A certified inspector's report is attached which documents the condition of the private sewage disposal system and whether any modifications are required to conform to standards adopted by the Department of Natural Resources. A certified inspection report must be accompanied by this form when recording.
- There is a private sewage disposal system on this property. Weather or other temporary physical conditions prevent the certified inspection of the private sewage disposal system from being conducted. The buyer has executed a binding acknowledgment with the county board of health to conduct a certified inspection of the private sewage disposal system at the earliest practicable time and to be responsible for any required modifications to the private sewage disposal system as identified by the certified inspection. A copy of the binding acknowledgment is attached to this form. When the inspection is completed, an amended Groundwater Hazard Statement shall be recorded with the certified inspection and shall include the document numbers of both the real estate transfer document and the original Groundwater Hazard Statement.
- There is a private sewage disposal system on this property. The building to which the sewage disposal system is connected will be demolished without being occupied. The buyer has executed a binding acknowledgment with the county board of health to demolish the building within an agreed upon time period. A copy of the binding acknowledgment is provided with this form.
- This property is exempt from the private sewage disposal inspection requirements pursuant to the following exemption: _____.
- The private sewage disposal system has been installed within the past two years pursuant to permit number _____.

Information required by statements checked above should be provided here or on separate sheets attached hereto:

I HEREBY DECLARE THAT I HAVE REVIEWED THE INSTRUCTIONS FOR THIS FORM AND THAT THE INFORMATION STATED ABOVE IS TRUE AND CORRECT.

Signature: *Harsh Chavers Pickett*
(Transferor or Agent)

Telephone No.: (515) 462-3120

x Daniel Pickett

GROUNDWATER HAZARD STATEMENT

ATTACHMENT #1

NOTICE OF WASTE DISPOSAL SITE

a. Solid Waste Disposal (check one)

- There is a solid waste disposal site on this property, but no notice has been received from the Department of Natural Resources that the site is deemed to be potentially hazardous.
- There is a solid waste disposal site on this property which has been deemed to be potentially hazardous by the Department of Natural Resources. The location(s) of the site(s) is stated below or on an attached separate sheet, as necessary.

b.. Hazardous Wastes (check one)

- There is hazardous waste on this property and it is being managed in accordance with Department of Natural Resources rules.
- There is hazardous waste on this property and the appropriate response or remediation actions, or the need therefore, have not yet been determined.

Further descriptive information:

None

I HEREBY DECLARE THAT I HAVE REVIEWED THE INSTRUCTIONS FOR THIS FORM

AND THAT THE INFORMATION STATED ABOVE IS TRUE AND CORRECT.

Signature: *Marta Chere Pickett*
(Transferor or Agent)

Telephone No.: (515) 462-3120

x *David D. Pickett*



Time of Transfer Inspection Report (DNR Form 542-0191)

Property information

Current owner Milse Pickett
Buyer Bruce & Michele Bjorn Realtor Madison Co. Realty
Mailing address 2656 Pine wood ave - Greenfield, Va.

Site Address/County 2675 Hwy 92
Legal Description # E - N. of Hwy 92 N.E. 1/4 Sec. 26 T 76 N. R 27 W -
Union Township

No. of bedrooms 3 Last occupied? yes now Records available yes

Permit/installation date # 1987 Separation distances ok/ no? OK
2001

Septic system information

Septic tank(s): size 1,500 gal material concrete condition like new
Tank pumped? yes date 7-7-09 licensed pumper Mayer St. 75
Septic/trash/processing tank: size _____ material _____ condition _____
Tank pumped? _____ date _____ licensed pumper _____

Aerobic treatment unit (ATU) mfg _____ size _____
Tank pumped? _____ date _____ licensed pumper _____
Maintenance contract? _____ expiration date _____ service provider _____
Condition _____

Pump tanks/vaults: type _____ size _____ condition _____

Distribution system: distribution box Plastic outlets used 4 condition like new
Header pipe(s) _____ # of lines _____ Pressure dosed? no

Secondary treatment:
length of absorption fields 100 ft determined by no map
condition of fields good determined by walking & Probing
type of trench material plastic dome E Q 24-4

Size of sand filter _____ determined by _____
Vent pipes above grade? _____ discharge pipe located? _____
Effluent sample taken? _____ Results _____

Media filters: type _____
Maintenance contract? _____ expiration date _____ service provider _____
Condition _____

NPDES General Permit No. 4: required? _____ permitted? _____ NOI provided _____



Time of Transfer Inspection Report

Other components:

Alarms _____ Working? _____ disinfection _____ working? _____

Control box _____ Timers _____ inspection ports _____

Other components _____

Overall condition of the private sewage disposal system

Report system status Very good cond.

Explain (attach additional pages as needed): _____

Comments: septic tanks & lateral fields are very good cond.
& no sewage is on ground surface as of 7-8-09

Site status at conclusion of Time of Transfer inspection:

- Verify that controls are set on the appropriate mode.
- Power is on to all components.
- Revisit all components to verify lids are secure.
- Gather all tools for removal from the site.
- Verify that no sewage is on the ground surface.

Using this worksheet, write a narrative report of the inspection results and attach a site sketch.

This report indicates the condition of the private sewage disposal system at the time of the inspection. It does not guarantee that it will continue to function satisfactorily.

Signature of Certified inspector: John M. Mayer Date: 7-8-09
 Name (print): _____ Certificate #: #8979
 Address: _____
 Phone #: 515-462-2624

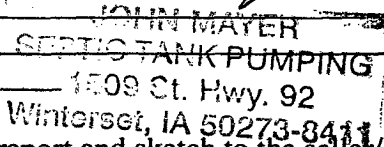

Provide a copy of this report, the narrative report and sketch to the seller/agent, buyer/agent, the county sanitarian/environmental health office, county Recorder in the county the inspection was conducted and to;

Iowa DNR Onsite Wastewater Program
502 E. 9th St.
Des Moines, IA 50319

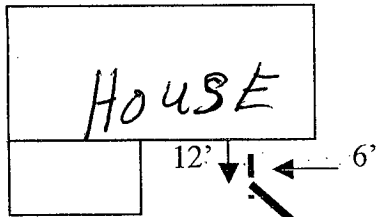

← NORTH

32
10'

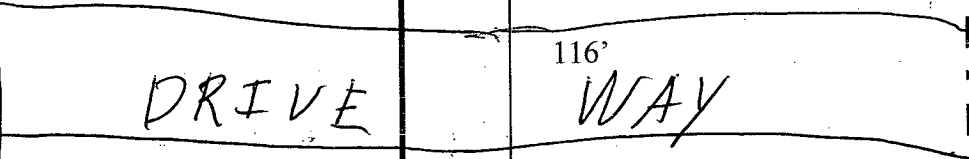
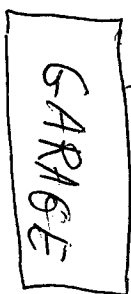

State Hwy 99

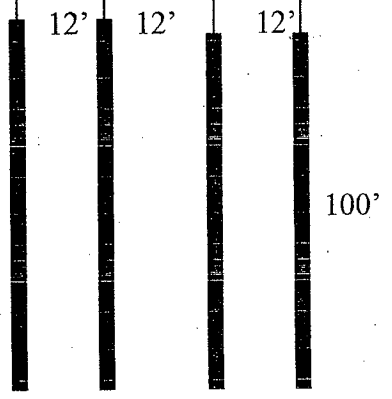
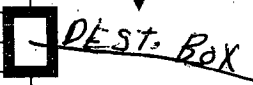

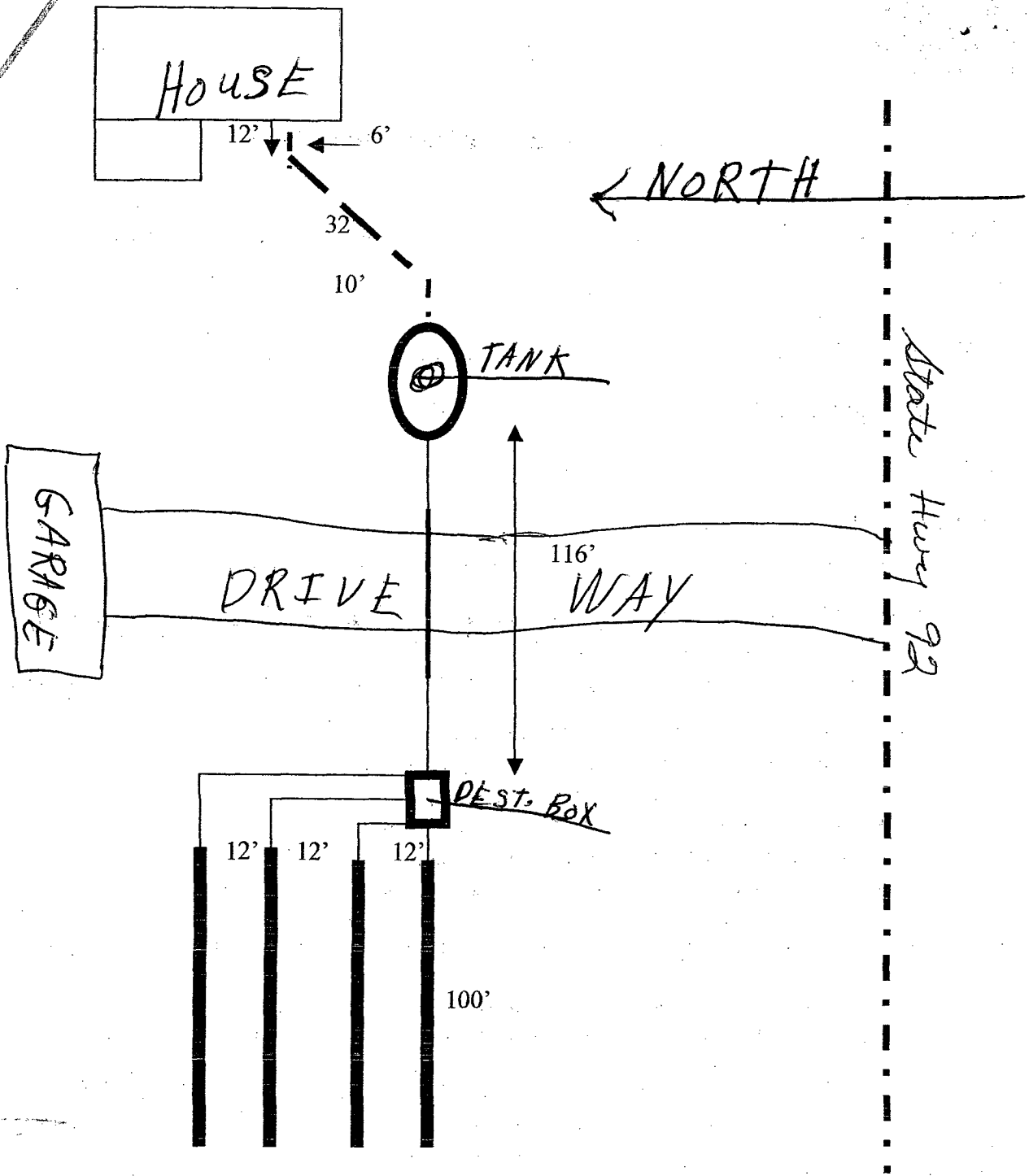

Addendum

1. Parcel "F", a portion of Parcel "C", located in the Northeast Quarter ($\frac{1}{4}$) of Section Twenty-six (26), Township Seventy-six (76) North, Range Twenty-seven (27) West of the 5th P.M., Madison County, Iowa, containing 25.0051 acres, as shown in Plat of Survey filed in Book 3, Page 665 on December 29, 2000, in the Office of the Recorder of Madison County, Iowa