



GARDEN & ASSOC.

806 Wyoming Ave., Creston, Iowa 50801 Phone: (641)782-4005

UNITED STATES PUBLIC LAND SURVEY CORNER CERTIFICATE OF

LAND SURVEY MONUMENTS SITUATED IN SECTION 18, TOWNSHIP 75 NORTH, RANGE 28 WEST
OF THE 5TH P.M. IN MADISON COUNTY, IOWA.

PREVIOUSLY RECORDED IN SEE BELOW IN COUNTY RECORDER'S OFFICE.

MONUMENT DESCRIPTION AND REMARKS: ① SW COR. SEC. 18-75-28, FOUND 1/2" PIN, W/ NAIL ON EAST SIDE OF
PIN PER PRIOR CERTIFICATE (BK. 1, PG. 241) ACCEPTED LOCATION OF PIN AND RETIED DUE TO MISSING TIES.

② S1/4 COR. SEC. 18-75-28, A PLAT OF SURVEY (BK. 2012, PG. 2186) INDICATES A NAIL IN TOP OF FENCE POST AS
CORNER. FOUND POST ROTTED OFF. CO. RD. PLANS "S-1490(1)" INDICATE AN IRON PIN AT P.I. STA. 98+30.5. USED TAN.
DISTANCE FROM FOUND PIN AT CO. RD. P.C. STA. 95+47.1 AND IN LINE W/ FOUND MONUMENT AT SW COR. 18-75-28.
SET 5/8" X 24" REBAR W/ YPC#24655 ON EAST SIDE OF ROTTED OFF CORNER POST USING CALC. LOCATION.

(SHOW A MINIMUM OF THREE REFERENCE TIES TO DURABLE PHYSICAL OBJECTS, RELEVANT MONUMENTS, AND PHYSICAL
CONDITIONS THAT WILL ENABLE RECOVERY OF THE CORNER)

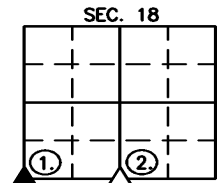

①

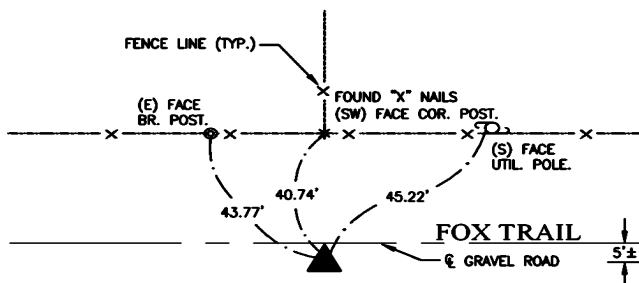

ALL TIES = MAG NAIL W/ NYLON WASHER, UNLESS NOTED.

SW COR. SEC. 18, T-75-N, R-28-W,
FOUND 1/2" IRON PIN

②

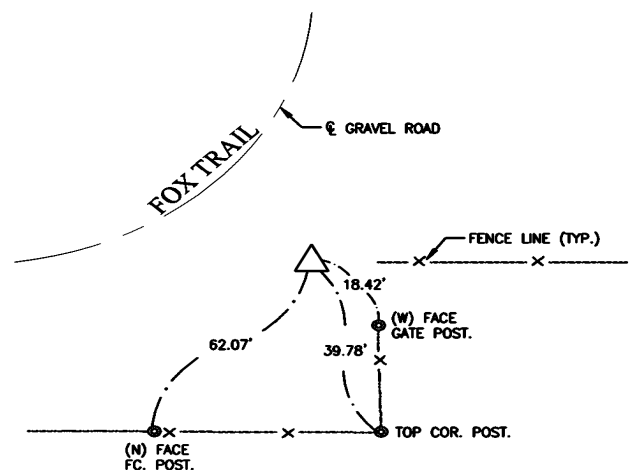

ALL TIES = MAG NAIL W/ NYLON WASHER, UNLESS NOTED.

S1/4 COR. SEC. 18, T-75-N, R-28-W,
SET 5/8" X 24" REBAR W/ YPC#24655

I hereby certify that this land surveying document was prepared and the
related survey work was performed by me or under my direct personal
supervision and that I am a duly licensed Professional Land Surveyor under the
laws of the State of Iowa.

Joshua E. Schneider

8-11-2025

Date

Joshua E. Schneider, P.L.S.
License number: 24655

My license renewal date is December 31, 2025
This page only covered by this seal:



LIST OF CORNERS TO BE INDEXED

CORNERS	SECTIONS	TOWNSHIP	RANGE
SW COR.	18	75	28
S1/4 COR.	18	75	28

SURVEY FOR: COLT EYERLY

DATE: 8-4-25

PROJECT NO. 6025761