



Document 2025 1402

Book 2025 Page 1402 Type 06 043 Pages 1
Date 6/05/2025 Time 9:29:36AM
Rec Amt \$7.00

INDX
ANNO
SCAN
CHEK

BRANDY MACUMBER, COUNTY RECORDER
MADISON COUNTY IOWA

PREPARED BY: CRAIG S. BOLDMAN 521 WEST GREEN STREET, WINTERSET, IA 50273 PHONE (515)462-9242

UNITED STATES PUBLIC LAND SURVEY CORNER CERTIFICATE

Land Survey Monuments situated in Section 10, Township 74, Range 28, the Fifth Principal Meridian, Madison County, Iowa.
Previously recorded in N 1/4 Book 1 Page 185 in County Recorder's Office

(Show reason for preparing this certificate, the evidence and detailed procedures used in establishing the corner positions & monumentation found or placed)

Monument Description and Remarks:

S 1/4 - Placed cut "X" in centerline from County Road plan.

SE Corner - Placed cut "X" in centerline from County Road plans.

N 1/4 - Found 5/8" yellow capped iron rod #7995 using ties and bridge acquisition plat. Monument is +/- 4' East of Center.

PLAN-VIEW

S 1/4 Corner

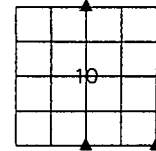
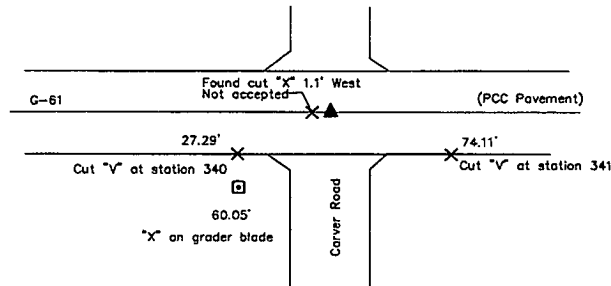

N 1/4 Corner

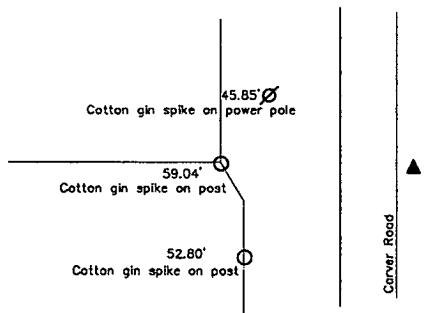

SE Corner

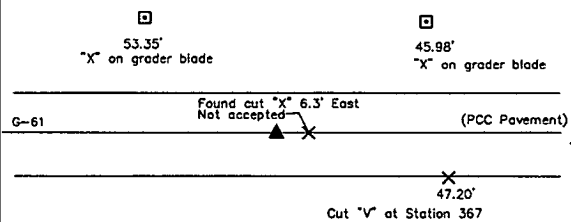

NOTE: ALL TIES TO ORANGE PLASTIC SURVEY MARKERS (SM) UNLESS NOTED

I HEREBY CERTIFY THAT THIS LAND SURVEYING DOCUMENT WAS PREPARED AND THE RELATED SURVEY WORK WAS PERFORMED BY ME OR UNDER MY DIRECT PERSONAL SUPERVISION AND THAT I AM A DULY LICENSED LAND SURVEYOR UNDER THE LAWS OF THE STATE OF IOWA.

SIGNATURE Craig S. Boldman
CRAIG S. BOLDMAN

DATE: 6/5/2025 LICENSE NO 13427

MY RENEWAL DATE IS DECEMBER 31, 2026

COVERS SHEETS A-11

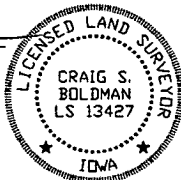

CORNERS TO BE INDEXED

Corners	Section	Township	Range
N 1/4	10	74	28
S 1/4	3	74	28
S 1/4	10	74	28
N 1/4	15	74	28
SE	10	74	28
SW	11	74	28
NW	14	74	28
NE	15	74	28

Project No. 25019