

**REAL ESTATE TRANSFER - GROUNDWATER HAZARD STATEMENT**  
TO BE COMPLETED BY TRANSFEROR

If the transaction is exempt from filing a declaration of value pursuant to Iowa Code 428A.1(2), **STOP HERE**. Pursuant to Iowa Code section 558.69(1), when no declaration of value is submitted during a transaction, you are not required to submit a groundwater hazard statement or include the statutory language in Iowa Code section 558.69(8A). Please consult your realtor or legal counsel for further advice, including on whether a declaration of value is required. The Department provides this information for statutory reference only.

Instructions for this document can be found at:

<https://www.iowadnr.gov/Portals/idnr/uploads/forms/5420960%20Instructions.pdf>

Attachment 1, if required, can be found at: <https://www.iowadnr.gov/Portals/idnr/uploads/forms/5420960a.pdf>

**TRANSFEROR:**

Name Yanhui Yu and Scott Iverson

Address 899 Robert Smith Rd McMinville Tennessee 37110  
Number and Street or RR City, Town or PO State Zip

**TRANSFeree:**

Name Alyssa Nicole Itzin Timm and Michael Timm

Address 1717 Merriam Ct Winterset Iowa 50273  
Number and Street or RR City, Town or PO State Zip

Address of Property Transferred:

1717 Merriam Ct Winterset Iowa 50273  
Number and Street or RR City, Town or PO State Zip

Legal Description of Property: (Attach if necessary)

Lot Six (6) of Hillcrest Subdivision, located in the East Half (1/2) of the North, Madison County, Iowa.

**1. Wells (check one)**

- No Condition - There are no known wells situated on this property.  
 Condition Present - There is a well or wells situated on this property. The type(s), location(s) and legal status are stated below or set forth on an attached separate sheet, as necessary.

**2. Solid Waste Disposal (check one)**

- No Condition - There is no known solid waste disposal site on this property.  
 Condition Present - There is a solid waste disposal site on this property and information related thereto is provided in Attachment #1, attached to this document.

**3. Hazardous Wastes (check one)**

- No Condition - There is no known hazardous waste on this property.
- Condition Present - There is hazardous waste on this property and information related thereto is provided in Attachment #1, attached to this document.

**4. Underground Storage Tanks (check one)**

- No Condition - There are no known underground storage tanks on this property. (Note exclusions such as small farm and residential motor fuel tanks, most heating oil tanks, cisterns and septic tanks, in instructions.)
- Condition Present - There is an underground storage tank on this property. The type(s), size(s) and any known substance(s) contained are listed below or on an attached separate sheet, as necessary.

**5. Private Burial Site (check one)**

- No Condition - There are no known private burial sites on this property.
- Condition Present - There is a private burial site on this property. The location(s) of the site(s) and known identifying information of the decedent(s) is stated below or on an attached separate sheet, as necessary.

**6. Private Sewage Disposal System (check one)**

- No Condition - All buildings on this property are served by a public or semi-public sewage disposal system.
- No Condition - This transaction does not involve the transfer of any building which has or is required by law to have a sewage disposal system.
- Condition Present - There is a building served by private sewage disposal system on this property or a building without any lawful sewage disposal system. A certified inspector's report is attached which documents the condition of the private sewage disposal system and whether any modifications are required to conform to standards adopted by the Department of Natural Resources. A certified inspection report must be accompanied by this form when recording.
- Condition Present - There is a building served by private sewage disposal system on this property. Weather or other temporary physical conditions prevent the certified inspection of the private sewage disposal system from being conducted. The buyer has executed a binding acknowledgment with the county board of health to conduct a certified inspection of the private sewage disposal system at the earliest practicable time and to be responsible for any required modifications to the private sewage disposal system as identified by the certified inspection. A copy of the binding acknowledgment is attached to this form.
- Condition Present - There is a building served by private sewage disposal system on this property. The system is failing to ensure effective wastewater treatment or is otherwise improperly functioning, and the buyer has executed a binding acknowledgment with the county board of health to install a new private sewage disposal system on this property within an agreed upon time period. A copy of the binding acknowledgment is provided with this form.
- Condition Present - There is a building served by private sewage disposal system on this property. The building to which the sewage disposal system is connected will be demolished without being occupied. The buyer has executed a binding acknowledgment with the county board of health to demolish the building within an agreed upon time period. A copy of the binding acknowledgment is provided with this form. [Exemption #7]
- Condition Present - There is a building served by private sewage disposal system on this property. This property is exempt from the private sewage disposal inspection requirements pursuant to the following Exemption [Note: for exemption #7 use prior check box]: \_\_\_\_\_
- Condition Present - There is a building served by private sewage disposal system on this property. The private sewage disposal system has been installed within the past two years pursuant to permit number: \_\_\_\_\_

Review the following two directions carefully:

- A. **If you selected a box stating "No Condition" for every numbered section above, STOP HERE. Do not submit this form.** Instead, pursuant to Iowa Code section 558.69(8A), you must include the following language on the first page of the recorded deed, instrument, or other writing:

"There is no known private burial site, well, solid waste disposal site, underground storage tank, hazardous waste, or private sewage disposal system on the property as described in Iowa Code section 558.69, and therefore the transaction is exempt from the requirement to submit a groundwater hazard statement."

Please consult your realtor or legal counsel for further advice on this exemption. By law, the owner of the property is responsible for the accuracy of this statement, and the Department provides this information for statutory reference only.

- B. **If you checked any box stating "Condition Present" for any of the numbered sections above, continue below.** You must complete this form, including providing all required information, and you must submit this form to the county recorder's office with declaration of value.

**Information required by statements checked above should be provided here or on separate sheets attached hereto:**

---

---

---

---

---

**I HEREBY DECLARE THAT I HAVE REVIEWED THE INSTRUCTIONS FOR THIS FORM AND THAT THE INFORMATION STATED ABOVE IS TRUE AND CORRECT.**

Signature: \_\_\_\_\_

(Transferor or Agent)

Telephone No.: \_\_\_\_\_

515-520-9951



**TIME OF TRANSFER INSPECTION TOT# 3956 SETH BROWN CERT # 13190**

Site Information

Parcel Description: **400071020060000**

Address: **1717 Merriam Ct, Winterset, IA 50273**

County: **Madison**

Owner Information

Property is owned by a business: **No**

Business Name:

Owner Name: **Scott Iverson**

Email Address: **yys.properties@gmail.com**

Address: **1717 Merriam Ct, Winterset, IA 50273**

Phone No:

Additional Contact Information

Name

Email Address

Affiliate Type

**Steve Wiederin**

**stevewiederin@realestateconcepts.net**

**Realtor**

**Michael Timm**

**Buyer**

Site related information

No Of Bedrooms: **4**

Inspection Date: **02/23/2023**

Facility Type: **Residential**

Currently Occupied: **No**

Last Occupied:

System Installation Date:

Permit issued by County: **N/A**

Permit Number:

All plumbing fixtures enter septic system: **Yes**

County contacted for records: **Yes**

Property Information Comments:

Primary Treatment

**Tank 1**

Tank Name: **Tank 1**

Type: **Septic Tank**

Tank Size (Gal): **1500**

Tank Material: **Concrete**

Tank Corrosion Type: **None**

Liquid Level Type: **Normal**

|                               |                                     |  |
|-------------------------------|-------------------------------------|--|
| No. of Compartments: <b>2</b> | Pump Tank Chamber: <b>No</b>        | Licensed Pumper Name: <b>Rogers Septic</b> |
| Date Pumped: <b>2/23/2023</b> | Meets Setback to Well: <b>N/A</b>   | Well Type:                                 |
| Distance To Well (Ft.):       | Is Accessible: <b>Yes</b>           | Lid Intact: <b>Yes</b>                     |
| Risers Intact: <b>Yes</b>     | Effluent Filter Present: <b>Yes</b> | Watertight: <b>Yes</b>                     |
| Tank/Vault Pumped: <b>Yes</b> | Inlet Baffle Present: <b>Yes</b>    | Outlet Baffle Present: <b>Yes</b>          |
| Tank Comments:                |                                     | Functioning as Designed: <b>Yes</b>        |

**Tank 2**

|                                |                                   |  |
|--------------------------------|-----------------------------------|--|
| Tank Name: <b>Tank 2</b>       | Type: <b>Pump Tank</b>            | Tank Size (Gal): <b>500</b>                |
| Tank Material: <b>Concrete</b> | Tank Corrosion Type: <b>None</b>  | Liquid Level Type: <b>Normal</b>           |
| No. of Compartments: <b>1</b>  | Pump Tank Chamber: <b>Yes</b>     | Licensed Pumper Name: <b>Rogers Septic</b> |
| Date Pumped: <b>2/23/2023</b>  | Meets Setback to Well: <b>N/A</b> | Well Type:                                 |
| Distance To Well (Ft.):        | Is Accessible: <b>Yes</b>         | Lid Intact: <b>Yes</b>                     |
| Risers Intact: <b>Yes</b>      | Effluent Filter Present:          | Watertight: <b>Yes</b>                     |
| Tank/Vault Pumped: <b>Yes</b>  | Inlet Baffle Present: <b>Yes</b>  | Outlet Baffle Present: <b>No</b>           |
| Tank Comments:                 |                                   | Functioning as Designed: <b>Yes</b>        |

General Primary Treatment Comments:

**Distribution Type**

**Pump System 1**

|  |                                     |                                     |
|--|-------------------------------------|-------------------------------------|
| Label: <b>Pump System 1</b>                  | Accessible: <b>Yes</b>              | Control Box Functioning: <b>Yes</b> |
| Alarm(s) Present and Functioning: <b>Yes</b> | Functioning As Designed: <b>Yes</b> |                                     |

**Distribution Box 1**

|                                  |                                     |                                    |
|----------------------------------|-------------------------------------|------------------------------------|
| Label: <b>Distribution Box 1</b> | Material Type: <b>Plastic</b>       | Accessible: <b>Yes</b>             |
| Box Opened: <b>Yes</b>           | Baffle Present: <b>Yes</b>          | Speed Levelers Present: <b>Yes</b> |
| Watertight: <b>Yes</b>           | Functioning As Designed: <b>Yes</b> |                                    |

General Distribution System Comments :

**Secondary Treatment**

**Lateral Field1**

|  |   |                                     |
|--|---|-------------------------------------|
| Distribution Type: <b>Distribution Box</b> | Material Type: <b>Leaching Chamber</b>      | Trench Width: <b>36</b>             |
| Lines: <b>5</b>                            | Total Length of Absorption Line: <b>480</b> | System Hydraulic Loaded: <b>Yes</b> |
| Gallons Loaded: <b>300</b>                 | Meets Setback to Well: <b>N/A</b>           | Well Type:                          |

Distance To Well (Ft):  
Grass Cover Present: **Yes**  
Easement Present: **N/A**  
Comments:

Lateral Lines Probed: **Yes**  
Lateral Lines Equal Length: **Yes**  
Functioning as Designed: **Yes**

Saturation or Ponding Present: **No**  
System Located on Owner Property: **Yes**

General Secondary Treatment Comments:

#### Narrative Report

TOT Inspection Report Overall Narrative Comments: **All wastewater goes to septic. 1500 gallon watertight concrete septic tank in working condition with no deterioration. Accessible by inlet and outlet risers and lids. Inlet and outlet baffles present, outlet filter present. 500 gallon watertight concrete pump tank in working condition with no deterioration. Accessible by riser and lid. Inlet baffle present. Pump and floats present and in working condition. Alarm panel (located inside house) and float present and in working condition. Pumps to distribution box. Plastic watertight distribution box in working condition. Baffle and speed levelers present. Hydraulic load tested 5x96 equaling 480 sq ft of chambered laterals with 300 gallons. Each lateral took water and probed dry and clean.**



**TIME OF TRANSFER INSPECTION TOT# 3956 SETH BROWN CERT # 13190**

Owner Name: **Scott Iverson**

Address: **1717 Merriam Ct , Winterset , IA 50273**

County: **Madison**

Inspection Date: **02/23/2023**

Submitted Date: **2/23/2023**

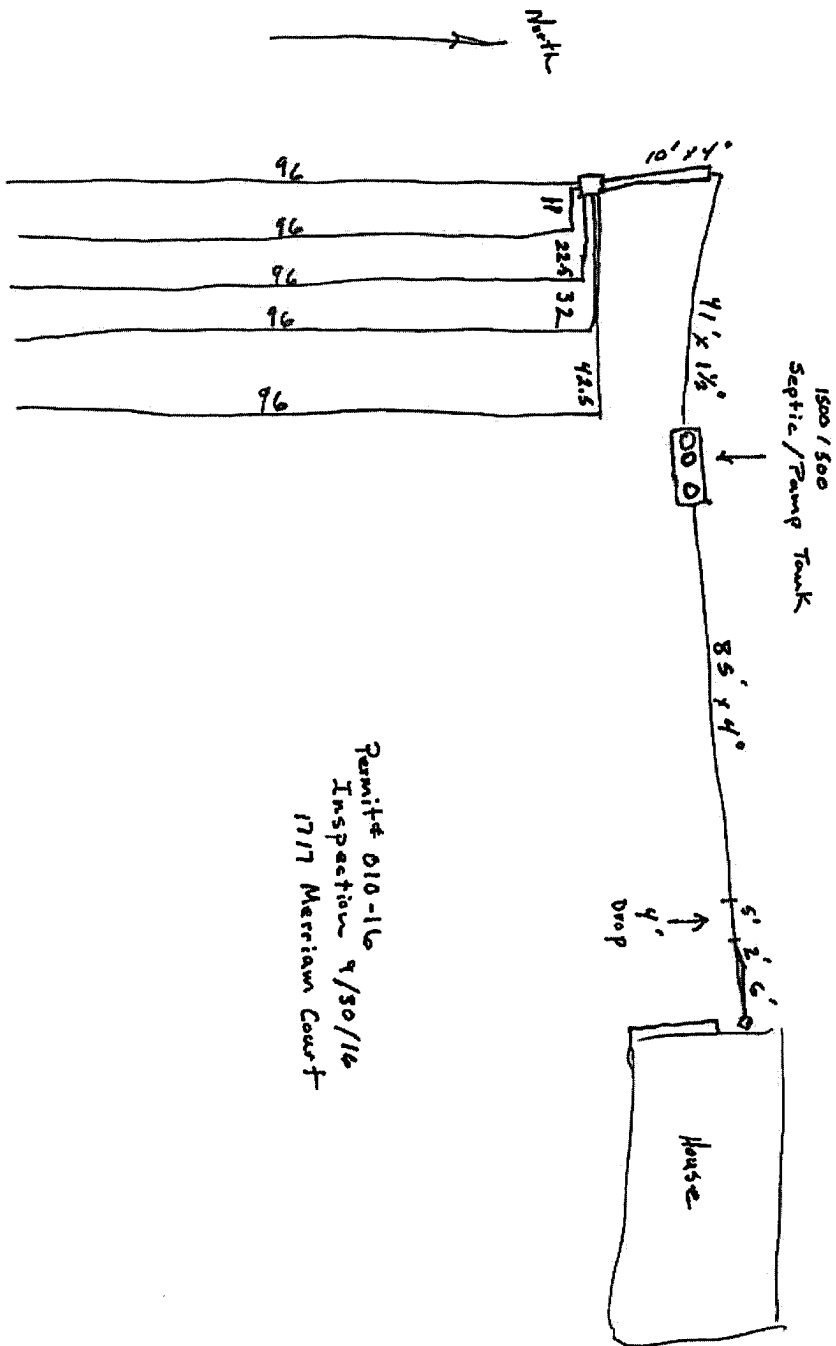

Permit # 010-16  
 Inspection 9/30/14  
 1717 Merriam Court