



Document 2023 GW2292

Book 2023 Page 2292 Type 43 001 Pages 7  
Date 9/20/2023 Time 1:23:02PM  
Rec Amt \$.00

INDX  
ANNO  
SCAN

BRANDY MACUMBER, COUNTY RECORDER  
MADISON COUNTY IOWA

**REAL ESTATE TRANSFER - GROUNDWATER HAZARD STATEMENT**  
TO BE COMPLETED BY TRANSFEROR

If the transaction is exempt from filing a declaration of value pursuant to Iowa Code 428A.1(2), **STOP HERE**. Pursuant to Iowa Code section 558.69(1), when no declaration of value is submitted during a transaction, you are not required to submit a groundwater hazard statement or include the statutory language in Iowa Code section 558.69(8A). Please consult your realtor or legal counsel for further advice, including on whether a declaration of value is required. The Department provides this information for statutory reference only.

Instructions for this document can be found at:  
<https://www.iowadnr.gov/Portals/idnr/uploads/forms/5420960%20Instructions.pdf>

Attachment 1, if required, can be found at: <https://www.iowadnr.gov/Portals/idnr/uploads/forms/5420960a.pdf>

**TRANSFEROR:**

Name Christopher D. Boswell and Leann K. Boswell

Address c/o Curt Green, 1307 Tomahawk Trail Ellston Iowa 50074  
Number and Street or RR City, Town or PO State Zip

**TRANSFeree:**

Name Kelly Henderson and Erin Henderson

Address 2534 140th St Van Meter Iowa 50261  
Number and Street or RR City, Town or PO State Zip

Address of Property Transferred:

2534 140th St Van Meter Iowa 50261  
Number and Street or RR City, Town or PO State Zip

Legal Description of Property: (Attach if necessary)

Parcel "C" located in the Southeast Quarter (1/4) of the Southwest Quarter (1/4) and part of the Southwest Quarter (1/4) of the Southeast Quarter (1/4) of Section Twenty-two (22), Township Seventy-seven (77) North, Range Twenty-seven (27) West of the 5th P.M., Madison County, Iowa, containing 40.25 acres, as shown in Plat of Survey filed in Book 2, Page 786 on April 28, 1997 in the Office of the Recorder of Madison County, Iowa, INCLUDING Parcel "H" located in the Southeast Quarter (1/4) of the Southwest Quarter (1/4) therein, containing 10.00 acres, as shown in Plat of Survey filed in Book 2001, Page 2695 on June 28, 2001 in the Office of the Recorder of Madison County, Iowa.

**1. Wells (check one)**

- No Condition - There are no known wells situated on this property.
- Condition Present - There is a well or wells situated on this property. The type(s), location(s) and legal status are stated below or set forth on an attached separate sheet, as necessary.

**2. Solid Waste Disposal (check one)**

- No Condition - There is no known solid waste disposal site on this property.
- Condition Present - There is a solid waste disposal site on this property and information related thereto is provided in Attachment #1, attached to this document.

**3. Hazardous Wastes (check one)**

- No Condition - There is no known hazardous waste on this property.
- Condition Present - There is hazardous waste on this property and information related thereto is provided in Attachment #1, attached to this document.

**4. Underground Storage Tanks (check one)**

- No Condition - There are no known underground storage tanks on this property. (Note exclusions such as small farm and residential motor fuel tanks, most heating oil tanks, cisterns and septic tanks, in instructions.)
- Condition Present - There is an underground storage tank on this property. The type(s), size(s) and any known substance(s) contained are listed below or on an attached separate sheet, as necessary.

**5. Private Burial Site (check one)**

- No Condition - There are no known private burial sites on this property.
- Condition Present - There is a private burial site on this property. The location(s) of the site(s) and known identifying information of the decedent(s) is stated below or on an attached separate sheet, as necessary.

**6. Private Sewage Disposal System (check one)**

- No Condition - All buildings on this property are served by a public or semi-public sewage disposal system.
- No Condition - This transaction does not involve the transfer of any building which has or is required by law to have a sewage disposal system.
- Condition Present - There is a building served by private sewage disposal system on this property or a building without any lawful sewage disposal system. A certified inspector's report is attached which documents the condition of the private sewage disposal system and whether any modifications are required to conform to standards adopted by the Department of Natural Resources. A certified inspection report must be accompanied by this form when recording.
- Condition Present - There is a building served by private sewage disposal system on this property. Weather or other temporary physical conditions prevent the certified inspection of the private sewage disposal system from being conducted. The buyer has executed a binding acknowledgment with the county board of health to conduct a certified inspection of the private sewage disposal system at the earliest practicable time and to be responsible for any required modifications to the private sewage disposal system as identified by the certified inspection. A copy of the binding acknowledgment is attached to this form.
- Condition Present - There is a building served by private sewage disposal system on this property. The system is failing to ensure effective wastewater treatment or is otherwise improperly functioning, and the buyer has executed a binding acknowledgment with the county board of health to install a new private sewage disposal system on this property within an agreed upon time period. A copy of the binding acknowledgment is provided with this form.
- Condition Present - There is a building served by private sewage disposal system on this property. The building to which the sewage disposal system is connected will be demolished without being occupied. The buyer has executed a binding acknowledgment with the county board of health to demolish the building within an agreed upon time period. A copy of the binding acknowledgment is provided with this form. [Exemption #7]
- Condition Present - There is a building served by private sewage disposal system on this property. This property is exempt from the private sewage disposal inspection requirements pursuant to the following Exemption [Note: for exemption #7 use prior check box]: \_\_\_\_\_
- Condition Present - There is a building served by private sewage disposal system on this property. The private sewage disposal system has been installed within the past two years pursuant to permit number: \_\_\_\_\_

Review the following two directions carefully:

- A. If you selected a box stating "No Condition" for every numbered section above, **STOP HERE**. Do not submit this form. Instead, pursuant to Iowa Code section 558.69(8A), you must include the following language on the first page of the recorded deed, instrument, or other writing:

"There is no known private burial site, well, solid waste disposal site, underground storage tank, hazardous waste, or private sewage disposal system on the property as described in Iowa Code section 558.69, and therefore the transaction is exempt from the requirement to submit a groundwater hazard statement."

Please consult your realtor or legal counsel for further advice on this exemption. By law, the owner of the property is responsible for the accuracy of this statement, and the Department provides this information for statutory reference only.

- B. If you checked any box stating "Condition Present" for any of the numbered sections above, continue below. You must complete this form, including providing all required information, and you must submit this form to the county recorder's office with declaration of value.

Information required by statements checked above should be provided here or on separate sheets attached hereto:

\*Functional, in the pasture on the SW side of the house

I HEREBY DECLARE THAT I HAVE REVIEWED THE INSTRUCTIONS FOR THIS FORM AND THAT THE INFORMATION STATED ABOVE IS TRUE AND CORRECT.

Signature:

(Transferor or Agent)

Telephone No.:

515-979-2738



**TIME OF TRANSFER INSPECTION TOT# 4844 SETH BROWN CERT # 13190**

Site Information

Parcel Description: **110022268000000**

Address: **2534 140th st, Van Meter, IA 50261**

County: **Madison**

Owner Information

Property is owned by a business: **No**

Business Name:

Owner Name: **Chris Boswell**

Email Address: **cboswell2002@yahoo.com**

Address: **2534 140th st, Van Meter, IA 50261**

Phone No:

Additional Contact Information

Name	Email Address	Affiliate Type
<b>Tammy Heckart</b>	<b>tammy@tammyheckart.com</b>	<b>Realtor</b>

Site related information

No Of Bedrooms: **3**

Inspection Date: **05/01/2023**

Facility Type: **Residential**

Currently Occupied: **N/A**

Last Occupied: **05/01/2023**

System Installation Date:

Permit issued by County: **N/A**

Permit Number:

All plumbing fixtures enter septic system: **Yes**

County contacted for records: **Yes**

Property Information Comments:

Primary Treatment

**Tank 1**

Tank Name: **Tank 1**

Type: **Septic Tank**

Tank Size (Gal): **1250**

Tank Material: **Concrete**

Tank Corrosion Type: **Slight**

Liquid Level Type: **Normal**

No. of Compartments: **2**

Pump Tank Chamber: **No**

Licensed Pumper Name: **Rogers Septic**

Date Pumped: **5/1/2023** Meets Setback to Well: **N/A** Well Type:  
Distance To Well (Ft.): Is Accessible: **Yes** Lid Intact: **Yes**  
Risers Intact: **Yes** Effluent Filter Present: **No** Watertight: **Yes**  
Tank/Vault Pumped: **Yes** Inlet Baffle Present: **Yes** Outlet Baffle Present: **Yes** Functioning as Designed: **Yes**  
Tank Comments:

General Primary Treatment Comments:

#### Distribution Type

##### Distribution Box 1

Label: **Distribution Box 1** Material Type: **Plastic** Accessible: **Yes**  
Box Opened: **Yes** Baffle Present: **Yes** Speed Levelers Present: **Yes**  
Watertight: **Yes** Functioning As Designed: **Yes**

General Distribution System Comments :

#### Secondary Treatment

##### Lateral Field1

Distribution Type: **Distribution Box** Material Type: **Leaching Chamber** Trench Width: **36**  
Lines: **4** Total Length of Absorption Line: **400** System Hydraulic Loaded: **Yes**  
Gallons Loaded: **300** Meets Setback to Well: **N/A** Well Type:  
Distance To Well (Ft.): Lateral Lines Probed: **Yes** Saturation or Ponding Present: **No**  
Grass Cover Present: **Yes** Lateral Lines Equal Length: **Yes** System Located on Owner Property: **Yes**  
Easement Present: **N/A** Functioning as Designed: **Yes**  
Comments:

General Secondary Treatment Comments:

#### Narrative Report

TOT Inspection Report Overall Narrative Comments: **All wastewater goes to septic. 1250 gallon watertight concrete septic tank in working condition with slight deterioration. Accessible by riser over center buried with 8in of dirt cover. Inlet and outlet baffles present, no outlet filter. Plastic watertight distribution box in working condition. Baffle and speed levelers present. Hydraulic load tested 4x100 equaling 400 ft of chambered laterals with 300 gallons. Each lateral took water and probed dry and clean.**



**TIME OF SFER INSPECTION TOT# 4844 SETH BROWN CERT # 13190**

Owner Name: **Chris Boswell**

Address: **2534 140th st , Van Meter , IA 50261**

County: **Madison**

Inspection Date: **05/01/2023**

Submitted Date: **5/1/2023**

**This page certifies a Time of Transfer inspection was conducted and submitted for the property listed above in accordance with Subrule 567 IAC 69.2(8).**

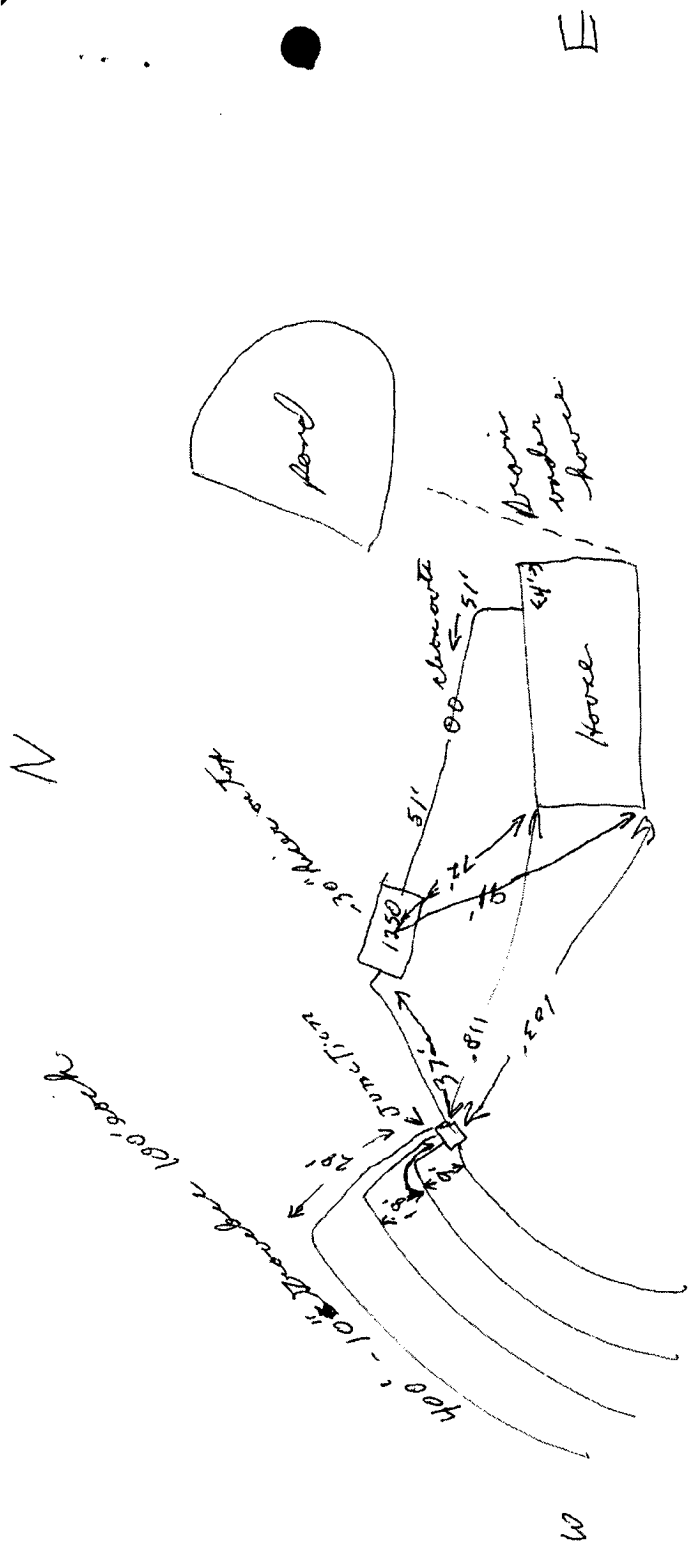

Craig Boswell