

BK: 2023 PG: 1234
 Recorded: 6/2/2023 at 8:37:14.0 AM
 Pages 1
 County Recording Fee: \$7.00
 Iowa E-Filing Fee: \$3.13
 Combined Fee: \$10.13
 Revenue Tax:
 BRANDY L. MACUMBER, RECORDER
 Madison County, Iowa

PREPARED BY: CRAIG S. BOLDMAN 521 WEST GREEN STREET, WINTERSET, IA 50273 PHONE (515)462-9242
 UNITED STATES PUBLIC LAND SURVEY CORNER CERTIFICATE

Land Survey Monuments situated in Section 27, Township 77, Range 28, the Fifth Principal Meridian, Madison County, Iowa.
 Previously recorded in Book 2 Page 35 in County Recorder's Office

(Show reason for preparing this certificate, the evidence and detailed procedures used in establishing the corner positions & monumentation found or placed)

Monument Description and Remarks:

Found 1/2" iron rod with yellow plastic cap #6808 using previous surveys. Original ties all removed.

PLAN-VIEW

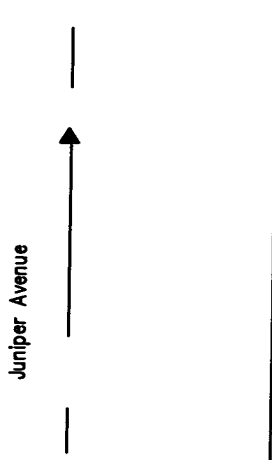
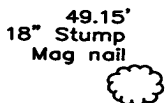
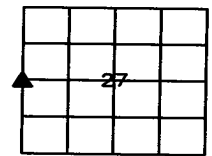

NOTE: ALL TIES TO ORANGE PLASTIC SURVEY MARKERS (SM) UNLESS NOTED

I HEREBY CERTIFY THAT THIS LAND SURVEYING DOCUMENT WAS PREPARED AND THE RELATED SURVEY WORK WAS PERFORMED BY ME OR UNDER MY DIRECT PERSONAL SUPERVISION AND THAT I AM A DULY LICENSED LAND SURVEYOR UNDER THE LAWS OF THE STATE OF IOWA

SIGNATURE: Craig S. Boldman
 CRAIG S. BOLDMAN

DATE: 6/1/23 LICENSE NO 13427

MY RENEWAL DATE IS DECEMBER 31, 2024

COVERS SHEETS 1

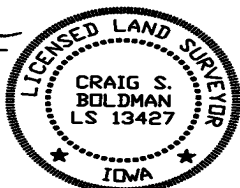

CORNERS TO BE INDEXED

Corners	Section	Township	Range
West 1/4	27	77	28
E 1/4	28	77	28

Project No. 23027